



DuKyota

ANTHROCON 2018 CONVENTION & DINING GUIDE

ANTHROCON 2018 CONVENTION & DINING GUIDE

Welcome to Anthrocon 2018! This Guide contains the following information which will be useful to you during the convention:

- ◆ Anthrocon 2018 Guest of Honor
- ◆ Dining Guide including Maps of Downtown & Strip District
- ◆ Dealers' Room Layout and Index
- ◆ David L. Lawrence Convention Center Floorplan
- ◆ Westin Convention Center Hotel Floorplan
- ◆ Art Show Hours & Bidding Rules
- ◆ Charity Auction & Raffle Information
- ◆ Anthrocon Standards of Conduct



Cover artwork by DJKyota

Dining Guide information compiled by Greyse AKA Heidi

Edited by Kijani

Layout and Dining Guide maps by Karl Xydexx Jorgensen

Composed by the Anthrocon Publications Department, PO Box 4211, Leesburg, VA 20177

Printed by Herrmann Printing, 1709 Douglass Drive, Pittsburgh, PA 15221

The Friends of Anthrocon are back!



Anthrocon
DRU
FRIENDS OF
#ANTHROCON
DRURY
PLAZA HOTEL

Anthrocon
HILDA
FRIENDS OF #ANTHROCON
2018 OFFICIAL CHARITY

Anthrocon
VIZZI
FRIENDS OF
#ANTHROCON
Visit **PITTSBURGH**

A friend for charity joins the group! Take your photo with all thirteen and use the #Anthrocon hashtag!



"Friends of Anthrocon" artwork for our hotels and partners by Mary "Moth Monarch" Capaldi! Find them at table C20 or see more in the art show!

GUESTS OF HONOR

Len Simon

Born in Toronto (Brampton), Ontario, Canada, Len Simon began his artistic career at the early age of 14. Creating T-shirt designs for sporting events and clothing companies, Len began to attract larger clients such as Black Label and Budweiser. At the age of 17 he taught drawing classes at a local night school. The following year, inspired by his older brother Mark Simon, Len attended Sheridan College in Oakville, Ontario to pursue his passion for animation.

After completing his first year of college, Len was recruited by Sullivan/Bluth Studios Ireland, where he was rapidly promoted to Directing Animator. From Ireland, he moved to Phoenix, Arizona in 1994 and was one of the original staff of Fox Animation Studios. While at Fox, Len was one of the main leads on Anastasia and was promoted to Animation Director in charge of all the character animation on Bartok the Magnificent and Titan AE. With Fox Animation's closure in 2000, Len established his own studio with his business partner James Stoyanof. Len has worked on more than a dozen classically animated feature films including Prince of Egypt, Spirit: Stallion of the Cimarron, and Curious George. His experience also includes television work, internet games, casino games, animated shorts, commercials and animated pilots.

Len's ability has progressed to encompass all aspects of animation from storyboard and development to post-production. His hands-on style of management has made Len one of the most accomplished figures in animation. In his spare time, Len enjoys illustrating children's books and sculpting, as well as developing original stories for print and film. Anthrocon is excited to welcome such a diversely talented animator as our Guest of Honor!



Ursula Vernon

Growing up the daughter of an artist in Oregon and Arizona, Ursula Vernon spent most of her youth attempting to rebel against the arts, eventually being drawn in by the "siren's song of paint." It was while earning her anthropology degree from Macalester College in Saint Paul, Minnesota that she first began her art classes.

She is perhaps most widely known for her Hugo Award (2012) and Mythopoeic Award (2013) winning webcomic Digger and her book series "Dragonbreath" which won the Sequoyah Book Award for Children's Literature. Her short story "Jackalope Wives" won the Nebula Award for Best Short Story, the Coyo! Award, and the WSFA Small Press Award (2015). Her stand-alone novel "Castle Hangnail" won the Mythopoeic Award for Children's Literature in 2016 and her novelette "The Tomato Thief" won the Hugo Award for Best Novelette in 2017.

Ursula's works have also been nominated for the Eisner Award, World Fantasy Award, and the British Science Fiction Award. Her works have also garnered many Web Cartoonists' Choice Awards, a mention in the New York Times, and enough Junior Library Guild Selections to allow her to cosplay as a six-star general.

Ursula currently resides in Pittsboro, North Carolina, where she works full-time as an artist and creator of oddities. Along with her husband Kevin, she lives with their two Coonhounds and a small collection of cats and chickens!

Her current project is the "Hamster Princess" series of books for kids which has been nominated for the Texas Bluebonnet Award and made the Amelia Bloomer List for feminist children's literature. She also writes for adults under the name T. Kingfisher.

Anthrocon is excited to welcome such a wonderfully talented author, artist, and illustrator as our Guest of Honor!



STANDARDS OF CONDUCT

The following general rule supersedes all others listed below and may be invoked at any time:

Any action or behavior that causes significant interference with convention operations, excessive discomfort to other attendees, or adversely affects Anthrocon's relationship with its guests, its venues, or the public is strictly forbidden and may result in permanent suspension of membership.

INTRODUCTION

The primary purpose of Anthrocon is for our attendees to have fun. To ensure that the greatest number of people do so, we have established certain rules of conduct. These rules are to ensure that the behavior of any one small group does not disturb the membership as a whole, and does not detract from the relaxed and comfortable atmosphere of the convention. Anthrocon welcomes all parties with an interest in anthropomorphic animals; however, the convention's management reserves the right to deny or revoke the membership of any individual at any time for any reason. Anthrocon, Inc. also reserves the right to amend these rules at any time without prior or posted notice and reserves the sole right of interpretation. In any dispute, the general rule above will apply. If you have any questions, please contact the convention operations staff for assistance.

Anyone who accepts a membership agrees to indemnify and hold harmless Anthrocon, Inc. from any claim for personal injuries or other damages or equity arising out of any individual's activities at Anthrocon, even if such injury or damage is caused by negligence by or on the part of Anthrocon, Inc.

As a condition of membership, all Anthrocon attendees are required to abide by these standards of conduct for the entire duration of their stay, even prior to Opening Ceremonies or after Closing Ceremonies.

GENERAL RATING OF THE CONVENTION

All convention space is considered to be "PG" at all times, with the exception of events or exhibits that are specifically noted to be inappropriate for minors and access to which is controlled by Anthrocon staff.

When in public areas, attendees may not wear clothing or accessories which are overly revealing, inappropriate to the atmosphere of the convention, or likely to draw reasonable complaint or offense. This includes clothing or accessories that are fetish-related or restrict mobility, such as a leash attached to an otherwise acceptable collar. Some normally inappropriate items may be included as part of a costume at the discretion of the Security Chief.

Shirts, pants/shorts/skirts, and footwear must be worn when in areas of hotels or the convention center that are accessible to non-Anthrocon attendees, such as lobbies, restaurants and concourses, except for hotel swimming pools. Full-body fursuits qualify as shirts, pants, and footwear provided that the costume is not unacceptably revealing. Fursuiters must respect the policies of hotels and other venues regarding areas where costumes are not allowed, which may include restaurants and hotel swimming pools.

Public displays of affection beyond what is appropriate for polite company are frowned upon. Please express your devotion to your significant other either in less conspicuous ways, or in private.

PUBLIC DECORUM

No items of any kind may be thrown, flown, or dropped from hotel or Convention Center balconies or patios.

No water pistols, silly string, or any thrown, flown, or projectile item may be used in any area of hotels or the Convention Center.

Lighter-than-air balloons may not be brought into the Convention Center.

For safety reasons, only handheld glowsticks are permitted in the dances. Glowsticks on strings or on polearms must be cleared with Security staff before being used. The decision of the Security staff on any particular item will be final.

Please do not sleep in convention space or hotel lobbies; return to your hotel room or home.

Anthrocon attendees must abide by instructions given by Anthrocon Security staff. Failure to do so will result in loss of membership privileges. Any disputes or concerns may be addressed onsite at Convention Operations.

Anthrocon functions are open only to members, and all attendees should wear their membership badges at all times. A badge is valid only for the person to whom it was issued; badges may not be shared under any circumstances.

Knowingly providing transportation or housing, or otherwise knowingly enabling an individual that is unwelcome at Anthrocon to attend or enter convention space will result in permanent revocation of Anthrocon membership privileges.

HARASSMENT

Harassment of any kind will not be tolerated at the convention. If you have been the target of harassment, we urge you to report the incident immediately to a member of Security or to Convention Operations. The sooner an issue is reported to us, the more appropriately we can address it.

Harassment includes, but is not limited to:

(a) Physical assault, battery, stalking, or unwelcome physical attentions.

(b) Conduct, dress, or speech that targets, threatens, intimidates, or is otherwise intended to cause distress to other attendees or members of protected classes (such as those based on race, age, religion, national origin, disability, gender, or sexual identity).

If people tell you “no” or ask you to leave them alone, your business with them is done. If you continue to attempt to have contact with those people, you may be removed from the premises. Remember: “A costume does not imply consent.”

ATTENDANCE BY MINORS

Anyone who is under the age of 18 years at any time during the convention must present a signed and notarized parental permission form unless accompanied by a parent or able to produce evidence of legal emancipation. There are no exceptions.

Minors are not permitted under any circumstances to enter areas designated for mature audiences.

Anyone providing false documentation of identity or age will be denied membership and reported to the police.

WEAPONS POLICY

No actual weapons or any item that can be easily mistaken for one may be carried either openly or concealed at any time in convention space, regardless of any government permits which you may possess. Exceptions may be made only for duly appointed law enforcement officers by prior arrangement with the Security Chief. Personal pocket knives with single-edged blades less than 4 inches long are permitted.

Realistic weapon replicas are permitted as part of a costume only during costume events such as the Fursuit Parade or Anthrocon Tonight, and must be appropriately peace-bonded; see the Security Chief for instruction on how to do so. They must be cased or otherwise secured when being carried outside of costume.

PET POLICY

Pets are not permitted in convention space. Service dogs (as defined by the Americans with Disabilities Act or ADA, Title II) are permitted in all convention space accessible to members provided that they are under appropriate control. Emotional Support Animals and Therapy Animals are NOT considered service dogs by the ADA, and are not permitted in convention space.

HOTEL PARTY POLICY

Gatherings in hotel rooms must not generate any noise that can be heard in neighboring rooms during nighttime hours. Hotel doors must be kept shut during such gatherings and guests are not permitted to congregate in the hotel corridors.

Loud parties will be given a single warning to remain quiet. No second warnings will be given

before action is taken by the hotel to remove the offending individuals.

Hotel guests who host any gathering are responsible for cleaning up afterward. Excessive amounts of unbagged trash must not be left for housekeeping staff to clean up (it’s just plain rude). Trash bags are provided. Use them.

OTHER HOTEL MATTERS

Any act of vandalism, deliberate or excessive damage to hotel property, or interference with any hotel or Convention Center workers in the performance of their duties will result in permanent revocation of Anthrocon membership, criminal prosecution, fines, or any combination thereof.

Do not affix anything to the walls of any hotel or Convention Center, to the elevators, to Anthrocon signage, or to hotel room doors.

The person in whose name a room is rented is solely responsible for the conduct of all individuals in the room as well as for the condition of the room. Excessive trash, soiling or other damage to hotel property, or any circumstance that may present a hazard to hotel housekeeping staff may result in permanent loss of Anthrocon membership privileges.

Hotel Housekeeping staff are required by corporate policy to inspect every room once per day, even if the room is not to be serviced. In some of our partner hotels, Housekeepers will delay their rounds for our benefit, and will initially bypass rooms with “do not disturb” signs on the doors. At the end of their rounds they must return to those rooms and will knock on the door. Attendees must allow housekeeping staff access to the room to inspect it at that time, even if the “do not disturb” sign is displayed.

Requests for room amenities such as towels and pillows beyond the number that is reasonable and customary for a single room will not be honored. Kindly bring such extra items from home if you anticipate the need.

SALES OF GOODS AND SERVICES

The offering for sale of any goods or services at the convention may be undertaken only in appropriate and authorized areas of Halls “B” or “C” in the Convention Center; in all cases the sale will be governed by the rules applicable to those areas. Sales may only be made at authorized times, and by registered, authorized Dealerships or registered, authorized Artist’s Alley participants. It is not permitted to sell any other goods or services in any other areas, including the Anthrocon “Zoo.”

SMOKING, ALCOHOL, AND SUBSTANCE ABUSE

Smoking is not permitted in any area within the Westin (including guest rooms) or the Convention Center. THIS INCLUDES ELECTRONIC CIGARETTES, at the request of the venue management. Smokers are asked to use designated smoking areas, and to comply with any other smoking rules of the facility. Cigarette butts must be disposed of properly.

Anthrocon asks that any bottled alcoholic beverages be brought promptly to hotel rooms for storage or responsible consumption. No alcoholic beverages may be brought into nor consumed in convention space, except during designated programming events.

Anyone knowingly or unknowingly providing alcohol to anyone under the age of 21 may be removed from the convention, be turned over to the authorities, and can be charged with a felony. It is the sole responsibility of persons serving alcohol in room parties to ensure that every person in attendance is over the age of 21, even if that person is not drinking alcohol. The Pennsylvania Liquor Control Board is extremely serious about this law and we ask our members to respect it.

The sale, distribution, or use of any illegal or controlled substances is not welcome at Anthrocon. Any individual found to be distributing such substances will be removed and reported directly to the authorities. For safety, any obviously intoxicated or impaired attendees will be asked to return to their room or seek medical attention until the effects have passed.

MEDIA RELATIONS AND USE OF ANTHROCON IMAGES OR FOOTAGE

All journalists, media photographers, and any other members of the press are required to display an official Anthrocon Press Badge or be accompanied by a senior Anthrocon staff member at all times while in convention space. Members of the press who have not been issued a Press Badge may not conduct interviews or take photographs, audio or video footage without an escort.

If members of the media are present, attendees must act responsibly. Media representatives who do not have Press Badges and are not escorted by an Anthrocon staff member should be reported to Anthrocon Security staff or to Convention Operations immediately. Do not speak to any unbadged and unescorted members of the press!

Anthrocon members should be aware that audio and/or video recordings are frequently made in convention space and that their likenesses may appear in those recordings. Individual members agree to assign without compensation the use of their likeness(es) at Anthrocon for the use of promotional material such as the highlights videos.

The name "Anthrocon" and the Anthrocon logo are registered service marks of Anthrocon, Inc., and must not be used in any fashion that disparages or dilutes that mark. Members agree to remove from circulation or publication any image or recording that in the sole opinion of Anthrocon, Inc. misrepresents or defames its service mark.

PAYMENTS TO ANTHROCON AND OTHER MONEY MATTERS

Please note that Anthrocon is a 501(c)7 nonprofit organization. As such, donations to the organization are not deductible from individual U.S. Federal income taxes.

Checks that are presented against insufficient funds will be charged a fee of \$30 per check.

Anthrocon accepts most major credit and debit cards. Chargebacks (denying a charge) that are made for the sole purpose of avoiding payment, that are made without sufficient cause, or that are made without first attempting to resolve the dispute with Anthrocon may result in permanent revocation of membership privileges and possible legal action.

Members who have an outstanding balance due to Anthrocon must settle that balance before being permitted to attend the convention.

Anthrocon cannot involve itself in financial disputes between individual members, and cannot divulge information about an individual member to any party other than to banking officials or legal authorities.

MISCELLANEOUS NOTES

The standards of conduct for Anthrocon will be enforced by Anthrocon security Staff. Please remember that your membership badge is the property of Anthrocon, Inc. and must be presented and/or surrendered to any Staff member requesting it. If you have any problem with any action taken by a Staff member you may take the matter up with the Chief of Security or with Anthrocon's Chairman.

Please be reminded that these rules involve "worst-case" scenarios and are put into place to ensure the safety and comfort of our members. They are also not all-inclusive; in all cases, the singular rule that supersedes all others is, "Any action or behavior that causes significant interference with convention operations, excessive discomfort to other attendees, or adversely affects Anthrocon's relationship with its guests, its venue, or the public is strictly forbidden and may result in revocation of membership privileges."

We anticipate no difficulties, as our members as a whole are rational and responsible adults. Anthrocon is prepared to handle difficulties as efficiently as possible should they occur. We thank our members for their past cooperation and for their continued assistance in making this a safe and enjoyable experience for everyone. Please remember to be courteous of those around you, and have fun!

Samuel Conway

Chairman, Anthrocon Inc.

ANTHROCON 2018 DINING GUIDE

Welcome to Anthrocon 2018's dining guide, from which emerges opportunities to satisfy your monstrous appetites! How well do you know your creature feature cuisine?

- * In what film might you "awoo" for English pub fare?
- * Which famous toothy pescatarian might nibble on New England chowdah?
- * Surely you can guess which atomic lizard might carouse Japan for some sushi?
- * Jeff Goldblum could tell you whether he's abuzz for a knish in which movie?
- * Grab your popcorn for bad movie night - it's a giant rabbit attack in...?
- * And which cuisine would be inhabited by murderous, red, round garden vegetables?

Let's all go to the lobby, and grab ourselves a snack!

This Guide is sorted by type of cuisine, and includes addresses and phone numbers (updated as of May 2018), as well as ratings gathered from *Yelp.com*.

Whether you're just looking for an inexpensive quick snack or want to have a fancy dinner, this Guide has more than 140 nearby dining options within a 15-minute walking radius to choose from. Listed after the dining options are services such as convenience stores, copy and shipping shops, nearby ATMs, etc. The figure below shows a sample entry:

Est. Average Price
Price range is the approximate cost per person for a meal including one drink, tax, and tip.
\$ = Cheap, Under \$10
\$\$ = Moderate, \$11 - \$30
\$\$\$ = Spendy, \$31 - \$60
\$\$\$\$ = Splurge, Above \$61

Follow us on Twitter! @AnthroconDining

Map Grid #
Location on map in center of this Guide.

Location #

Location Name
Rating

Gay-friendly
Delivery
Vegetarian Options
Gluten-free Options

Munstaurant ★★★★★ \$ 🇺🇸 🚚 V G C-3 ■ 182

1313 Mockingbird Lane, 412-555-2018 - Be good, have fun.

Th: 9a-5p F: 9a-5p Sa: 9a-5p Su: closed

Street Address & Phone Number
Operating Hours
Additional Information

WITHIN 5 MINUTE WALK FROM DLCC
WITHIN 10 MINUTE WALK FROM DLCC
MORE THAN 10 MINUTE WALK FROM DLCC

WALKING DISTANCE FROM DLCC IS INDICATED BY COLOR CODES

More food options at these shopping districts:

- Market Square: www.marketsquarepgh.com
- The Strip: www.stripdistrictneighbors.com (see back cover)
- Station Square: www.stationsquare.com (see back cover)

AMERICAN

August Henry's City Saloon ★★★★★☆ \$\$	B-2 • 1
946 Penn Ave, 412-765-3270 - casual attire, kitchen closes earlier than bar	
Th: 11a-2a	Fr: 11a-2a
Sa: 11a-2a	Su: closed
Bigelow Grille ★★★★★☆ \$\$	B-3 • 2
1 Bigelow Sq, 412-281-5013	
Th: 6a-11p	Fr: 6a-11p
Sa: 7a-11p	Su: 7a-11p
Bill's Bar and Burger ★★★★★☆ \$\$	C-2 • 3
1001 Liberty Ave, 412-567-2300	
Th: 11a-11p	Fr: 11a-12
Sa: 11a-12	Su: 11a-11p
Bluebird Kitchen ★★★★★☆ 🚚 \$\$	A-2 • 4
221 Forbes Ave, 412-642-4414	
Th: 7a-3p	Fr: 7a-3p
Sa: closed	Su: closed
Braddock's Pittsburgh Brasserie ★★★★★☆ \$\$	A-1 • 5
107 6th St, 412-992-2005	
Th: 7a-11p	Fr: 7a-12a
Sa: 7a-12a	Su: 7a-11p
BRGR ★★★★★☆ \$\$	A-2 • 6
535 Liberty Ave, 412-281-4748	
Th: 11a-11p	Fr: 11a-11p
Sa: 11a-11p	Su: 11a-11p
Butcher and the Rye ★★★★★☆ \$\$\$	A-2 • 7
212 6th St, 412-391-2752 - casual attire, kitchen closes earlier than bar	
Th: 5p-1a	Fr: 5p-2a
Sa: 5p-2a	Su: closed
Carlton, The ★★★★★☆ \$\$\$	B-3 • 8
500 Grant St, 412-391-4099 - dressy (Website notes that their dress code is "Whatever you are comfortable with is fine with us.")	
Th: 11a-2:30p, 5p-10p	Fr: 11a-2:30p, 5p-10p
Sa: 5p-10p	Su: closed
Cherries Diner ★★★★★☆ \$	A-2 • 9
212 Forbes Ave, 412-281-8182	
Th: 7a-3p	Fr: 7a-3p
Sa: 8a-3p	Su: 8a-3p
Courthouse Tavern ★★★★★☆ \$\$	A-3 • 10
310 Forbes Ave, 412-338-8608	
Th: 10:30a-2a	Fr: 10:30a-2a
Sa: 10:30a-2a	Su: 12p-12a
Crafted North ★★★★★☆ \$\$	C-3 • 11
112 Washington Place, 412-471-4000	
Th: 11a-1a	Fr: 11a-2a
Sa: 11a-2a	Su: 11a-1a
Craftwork Kitchen ★★★★★☆ 🚚 \$	B-3 • 12
600 Grant St, 412-979-4754 - Number listed on Facebook is 412-281-6230 Number on Yelp is 412-281-1460	
Th: 7a-2p	Fr: 7a-2p
Sa: closed	Su: closed
DeLuca's Restaurant ★★★★★☆ \$	Strip • 13
2015 Penn Ave, 412-566-2195 - known for breakfasts, cash only	
Th: 6:30a-2:30p	Fr: 6:30a-2:30p
Sa: 6a-3p	Su: 7a-3p

AMERICAN

Diamond Market Bar & Grill ★★★★★ \$ 430 Market St, 412-325-2000 Th: 11a-10p Fr: 11a-11p Sa: 11a-11p Su: 11a-10p	A-2 • 14
Elevation ★★★★★ \$ 535 Smithfield St 25th Fl, 412-338-2200 Th: 7:30a-10:30a, 11a-10p Fr: 7:30a-10:30a, 11a-10p Sa: 7:30a-10:30a, 11a-10p Su: 7:30a-10:30a, 11a-10p	B-2 • 15
Eleven ★★★★★ \$\$\$ 1150 Smallman St, 412-201-5656 - upscale, business casual attire, reservations recommended Th: 11:30a-10p Fr: 11:30a-11p Sa: 11:30a-2p, 5p-11p Su: 5p-9p	C-1 • 16
Garden Café, The ★★★★★ \$ 600 Penn Ave, 412-392-4879 Th: 11:30a - 2:30p Fr: 11:30a - 2:30p Sa: closed Su: closed	A-2 • 17
Meat & Potatoes ★★★★★ G \$\$\$ 649 Penn Ave, 412-325-7007 Th: 5p-11p Fr: 5p-12a Sa: 10:30a-2p, 5p-12a Su: 10:30a-2p, 5p-10p	A-2 • 18
Mozart Room, The ★★★★★ \$\$\$ 600 Penn Ave, 412-392-4882 - formal attire, RESERVATIONS ONLY Th: 5:30p-8p Fr: 5:30p-8p Sa: 5:30p-8p Su: 5:30p-8p	A-2 • 19
Nine On Nine ★★★★★ G \$\$\$ 900 Penn Ave, 412-338-6463 - business-casual attire, fine dining, reservations recommended Th: 5p-10p Fr: 5p-11p Sa: 5p-11p Su:	B-2 • 20
P&G's Pamela's Diner ★★★★★ \$ 60 21st St, 412-281-6366 - good for breakfast, cash only Th: 7a-3p Fr: 7a-3p Sa: 7a-3p Su: 8a-3p	Strip • 21
Palm Court ★★★★★ 530 William Penn Pl, 412-281-7100 - serves traditional afternoon tea 2:30p-4p Th: 11:30a-11:30p Fr: 11:30a-11:30p Sa: 11:30a-11:30p Su: 11:30a-11:30p	B-3 • 22
Penn City Grille ★★★★★ \$\$\$ Westin Convention Center Hotel, 412-281-3700 Th: 6:30a-11a Fr: 6:30a-11a Sa: 6:30a-2p Su: 6:30a-2p	C-2 • 23
Redbeard's on Sixth ★★★★★ \$ 144 6th St, 412-261-2324 - Kitchen closes at 1 am. Th: 11a-2a Fr: 11a-2a Sa: 11a-2a Su: 11a-2a	A-2 • 24
Roost ★★★★★ 242 Forbes Ave, second floor, 412-281-1616 Th: 6a-10a, 5p-11p Fr: 6a-10a, 5p-11p Sa: 7a-11a, 5-10 Su: 7a-11a	A-2 • 25
Revel ★★★★★ \$ 242 Forbes Ave, street level, 412-281-1134 Th: 11a-11p Fr: 11a-12a Sa: 11a-12a Su: 10a-10p	A-2 • 26

AMERICAN

Ten Penny ★★☆☆☆☆ \$\$ **B-2 • 27**
960 Penn Ave, 412-318-8000
Th: 11a-12a Fr: 11a-12a Sa: 10a-12a Su: 10a-9p

Terrace Room ★★☆☆☆☆ \$\$\$ **B-3 • 28**
Omni William Penn Hotel, 412-553-5235 - dressy
Th: 6:30a-11a, 11:30a-2p, 5p-9p Fr: 6:30a-11a, 11:30a-2p, 5p-10p
Sa: 6:30a-2p, 5p-10p Su: 6:30a-2p

The Commoner ★★☆☆☆☆ \$\$ **B-2 • 29**
458 Strawberry Way, 412-230-4800
Th: 6:30a-10:30a, 11a-2p, 5p-11p Fr: 6:30a-10:30a, 11a-2p, 5p-12a
Sa: 7:30a-3p, 5p-12a Su: 7:30a-3p, 5p-10p

The Yard ★★☆☆☆☆ \$\$ **A-2 • 30**
100 Fifth Ave, 412-291-8182 - Kitchen closes before bar
Th: 11a-11p Fr: 11a-1a Sa: 10a-1a Su: 10a-10p

Union Standard ★★☆☆☆☆ \$\$\$ **B-3 • 31**
524 William Penn Pl, 412-281-0738
Th: 11a-2:30p, 5p-10p Fr: 11a-2:30p, 5p-11p Sa: 10a-2p, 5p-11p Su: 10a-2p, 5p-9p

Winghart's Burger & Whiskey Bar ★★☆☆☆☆ \$\$ **A-2 • 32**
5 Market Sq, 412-434-5600
Th: 11a-12a Fr: 11a-2a Sa: 11a-2a Su: 12p-12a

ASIAN

Bae Bae's Kitchen ★★☆☆☆☆  \$\$ **B-2 • 33**
951 Liberty Ave, 412-391-1890
Th: 11:30a-8p Fr: 11:30a-8p Sa: 12p-8p Su: 12p-3p

Fu Lai Chinese Restaurant ★★☆☆☆☆  \$ **A-2 • 34**
525 Penn Ave, 412-471-6338
Th: 1:30p-9:30p Fr: 1:30p-9:30p Sa: 12p-9:30p Su: 12p-9p

Noodles & Company ★★☆☆☆☆ \$ **A-2 • 35**
476 McMaster Way, 412-562-2191
Th: 11a-9p Fr: 11a-9p Sa: 11a-9p Su: 11a-9p

Social House Seven ★★☆☆☆☆ \$\$ **A-1 • 36**
123 7th St, 512-709-6808
Th: 11a-11p Fr: 11a-2a Sa: 11a-2a Su: 11a-10p

Sushi Kim ★★☆☆☆☆ \$\$ **C-1 • 37**
1241 Penn Ave, 412-281-9956 - Fri-Sat 5-10p: BBQ buffet ~ Mon: sushi only
Th: 11:30a-9:30p Fr: 11:30a-10:00p Sa: 11:30a-10:00p Su: 12p-9p

BARs

941 Saloon ★★☆☆☆☆  \$\$ **B-2 • 38**
941 Liberty Ave, 412-281-5222
Th: 2p-2a Fr: 2p-2a Sa: 2p-2a Su: 2p-2a

BARS

Mahoney's Restaurant & Lounge ★★☆☆☆☆ \$\$	B-2 • 39
949 Liberty Ave, 412-471-4243 - Ambience described as "Divey"	
Th: 11a-1a	Su: closed
Fr: 11a-1a	
Sa: 12p-1a	
Olive or Twist ★★☆☆☆☆ V \$\$	A-1 • 40
140 6th St, 412-255-0525 - Takes reservations, kitchen open until 11p on Thurs, midnight Fri & Sat	
Th: 3:30p-2a	Su: closed
Fr: 3:30p-2a	
Sa: 3p-2a	
Sharp Edge Bistro on Penn ★★☆☆☆☆ V \$\$	B-2 • 41
922 Penn Ave, 412-338-2437 - kitchen closes at midnight on Fri & Sat	
Th: 11a-12a	Su: 9a-12a
Fr: 11a-1a	
Sa: 9a-1a	
Speakeasy ★★☆☆☆☆ \$	B-3 • 42
530 William Penn Pl, 412-281-7100	
Th: 5p-11p	Su: closed
Fr: 5p-12:30a	
Sa: 5p-12:30a	
The Warren ★★☆☆☆☆ \$	A-2 • 43
245 7th St, 412-201-1110	
Th: 11a-2a	Su: 5p-2a
Fr: 11a-2a	
Sa: 5p-2a	
BARS WITH NIGHTLIFE	
Andys Wine Bar ★★☆☆☆☆ \$	A-2 • 44
510 Market St, 412-773-8800	
Th: 4pm-12a	Su: closed
Fr: 4p-1a	
Sa: 3pm-1a	
Cavo Nightclub ★★☆☆☆☆ \$	Strip • 45
1916 Smallman St, 412-606-7143	
Th: closed	Su: closed
Fr: 9p-2a	
Sa: 9p-2a	
Howl at the Moon ★★☆☆☆☆ \$	A-1 • 46
125 7th St, 412-586-5692	
Th: 5p-2a	Su: closed
Fr: 5p-2a	
Sa: 5p-2a	
Images Bar ★★☆☆☆☆ 🏳️ \$	B-2 • 47
965 Liberty Ave, 412-391-9990 - Permits smoking.	
Th: 2p-2a	Su: 2p-2a
Fr: 2p-2a	
Sa: 2p-2a	
Real Luck Café ★★☆☆☆☆ 🏳️ \$	Strip • 48
1519 Penn Ave, 412-471-7832 - Permits smoking.	
Th: 4p-2a	Su: 4p-2a
Fr: 4p-2a	
Sa: 4p-2a	
Tap Room ★★☆☆☆☆ \$	B-3 • 49
Omni William Penn Hotel, 412-281-7100 - casual attire, dining available until 11p	
Th: 11:30a-12a	Su: 11:30a-12a
Fr: 11:30a-1a	
Sa: 11:30a-1a	
There Ultra Lounge ★★☆☆☆☆ 🏳️ \$	B-2 • 50
931 Liberty Ave, 412-642-4435	
Th: 3:30pm-2am	Su: 7:30pm-2am
Fr: 3:30pm-2am	
Sa: 7:30pm-2am	

YOUR feedback helps improve our Dining Guide.

Comments are always welcome! Let us know what you liked or didn't like!

E-mail book@anthrocon.org or visit www.anthrocon.org/survey

Follow us on Twitter!



@AnthroconDining

CAJUN & CREOLE

NOLA ★★☆☆☆☆ **\$\$**

A-2 • 51

24 Market Sq, 412-471-9100

Th: 11:30a-10p

Fr: 11:30a-11p

Sa: 4p-11p

Su: 11a-a-3p, 4p-8p

CARIBBEAN & SOUTH AMERICAN

Fogo de Chao Brazilian ★★☆☆☆☆ **\$\$\$**

B-3 • 52

525 Smithfield St, 412-312-5001

Th: 11a-3p, 5p-10:30p

Fr: 11a-3p, 5p-11p

Sa: 11a-11p

Su: 11a-11p

Gaucha Parrilla Argentina ★★☆☆☆☆ **\$\$**

Strip • 53

1601 Penn Ave, 412-709-6622

Th: 11a-9p

Fr: 11a-10p

Sa: 11a-10p

Su: closed

Kaya ★★☆☆☆☆ **\$\$**

Strip • 54

2000 Smallman St, Suite 9, 412-261-6565

Th: 11:30a-11p

Fr: 11:30a-11p

Sa: 11:30a-11p

Su: 11a-9p

COFFEE

Crazy Mocha

B-2 • 55

425 Sixth Ave

Th: 6:30a-4p

Fr: 6:30a-4p

Sa: closed

Su: closed

Crazy Mocha ★★☆☆☆☆ **\$**

B-3 • 56

500 Grant St Steel Plaza, 412-434-0203

Th: 6a-4p

Fr: 6a-4p

Sa: closed

Su: closed

Crazy Mocha ★★☆☆☆☆ **\$**

B-3 • 57

500 Grant St 1 Mellon Ctr, 412-281-1981

Th: 6a-5p

Fr: 6a-5p

Sa: closed

Su: closed

Crazy Mocha ★★☆☆☆☆ **\$**

C-2 • 58

1001 Liberty Ave, 412-281-1065 - select Sunday hours during events

Th: 6a-6p

Fr: 6a-6p

Sa: 8a-2p

Su: 8a-noon

Crazy Mocha ★★☆☆☆☆ **\$**

B-2 • 59

801 Liberty Ave, 412-281-3940

Th: 6a-8p

Fr: 6a-11p

Sa: 8a-11p

Su: 8a-6p

Dunkin' Donuts ★★☆☆☆☆ **\$**

B-3 • 60

601 Grant St, 412-281-4070

Th: 6a-7p

Fr: 6a-7p

Sa: 7a-3p

Su: 8a-1p

Nicholas Coffee Company ★★☆☆☆☆ **\$**

A-2 • 61

23 Market Sq, 412-261-4225

Th: 7a-5:30p

Fr: 7a-5:30p

Sa: 9a-4p

Su: closed

Starbucks Coffee Company ★★☆☆☆☆ **\$\$**

B-3 • 62

600 Grant St, 412-765-3125

Th: 5:30a-6p

Fr: 5:30a-6p

Sa: closed

Su: closed

Starbucks Coffee Company ★★☆☆☆☆ **\$\$**

A-2 • 63

210 6th Ave, 412-642-9066

Th: 5a-5:30p

Fr: 5a-5:30p

Sa: closed

Su: closed

COFFEE

Starbucks Coffee Company ★★★★★☆ \$ **B-3 • 64**
530 William Penn Pl, 412-201-2004
Th: 5a-8p Fr: 5a-8p Sa: 6:30a-6:30p Su: 6:30a-3p

Starbucks Coffee Company ★★★★★☆ \$\$ **A-2 • 65**
202 6th St, 412-281-2380
Th: 5:30a-8p Fr: 5:30a-11p Sa: 6:30a-11p Su: 7:30a-8p

COFFEE SHOP, WINE BAR, & CAT CAFE!

Colony Cafe ★★★★★☆ \$\$ **C-1 • 66**
1125 Penn Ave, 412-586-4850 - Cat loft is open 11a-8p with a catnap closure
from 2p-3p. Reservations recommended!
Th: 10:30a-9p Fr: 10:30a-9p Sa: 9a-9p Su: closed

DELI

Au Bon Pain ★★★★★☆ \$ **B-2 • 67**
535 Smithfield St, 412-263-2772
Th: 6a-5p Fr: 6a-5p Sa: closed Su: closed

Au Bon Pain ★★★★★☆ \$ **B-3 • 68**
600 Grant St, 412-456-2906
Th: 6a-4p Fr: 6a-4p Sa: closed Su: closed

Au Bon Pain ★★★★★☆ \$\$ **B-2 • 69**
707 Grant St, 412-456-4309
Th: 6a-4p Fr: 6a-4p Sa: closed Su: closed

Bruegger's Bagels ★★★★★☆ \$ **B-3 • 70**
531 Grant St, 412-471-9249
Th: 5:30a-7p Fr: 5:30a-7p Sa: 6a-7p Su: 6a-7p

Eadie's Kitchen and Market ★★★★★☆ \$\$ **B-3 • 71**
500 Grant St - Mellon Bank Building, 412-391-3993
Th: 6:30a-3p Fr: 6:30a-3p Sa: closed Su: closed

Einstein Bros Bagels ★★★★★☆ \$ **B-2 • 72**
436 Seventh Ave, 412-904-1491
Th: 5:30a-5p Fr: 5:30a-5p Sa: closed Su: closed

Erin's Fine Foods ★★★★★☆ \$ **A-2 • 73**
210 6th Ave, 412-315-7052 - Alternate Phone 412-366-5095
Th: 6a-4p Fr: 6a-4p Sa: closed Su: closed

MixStir's Café ★★★★★☆ \$\$ **C-1 • 74**
1212 Smallman St, 412-454-6310
Th: 10a-5p Fr: 10a-5p Sa: 10a-5p Su: 10a-5p

FAST FOOD

Arby's ★★★★★☆ \$ **B-2 • 75**
808 Liberty Ave, 412-281-1425
Th: 6a-9p Fr: 6a-9p Sa: 10a-8p Su: 10a-8p

FAST FOOD

Burger King ★★☆☆☆ \$ **B-2 • 76**
647 Smithfield St, 412-291-9176
Th: 5a-12a Fr: 5a-12a Sa: 6a-12a Su: 7a-12a

Five Guys Burgers and Fries ★★☆☆☆ \$\$ **A-2 • 77**
3 PPG PL, 412-227-0206
Th: 11a-10p Fr: 11a-10p Sa: 11a-10p Su: 11a-10p

McDonald's ★★☆☆☆ \$ **A-3 • 78**
505 Smithfield St, 412-281-1777
Th: 5a-8p Fr: 5a-8p Sa: 5:30a-8p Su: 6a-9p

McDonald's ★★☆☆☆ \$ **Strip • 79**
1630 Penn Ave, 412-471-1747
Th: 6a-11p Fr: 6a-11p Sa: 6a-11p Su: 7a-10p

Wiener World ★★☆☆☆ \$ **B-2 • 80**
626 Smithfield St, 412-471-3013
Th: 9a-4p Fr: 9a-4p Sa: closed Su: closed

FUSION

Tako Pittsburgh ★★☆☆☆ \$\$ **A-2 • 81**
214 6th St, 412-471-8256
Th: 5p-11p Fr: 5p-12a Sa: 5p-12a Su: 3p-9p

GREEK

Apollo Café ★★☆☆☆ \$ **B-3 • 82**
429 Forbes Ave, 412-471-3033
Th: 7a-3p Fr: 7a-3p Sa: closed Su: closed

Mike & Tony's Gyro and Shish-Kabob ★★☆☆☆ \$ **B-2 • 83**
927 Liberty Ave, 412-391-4077 - cash only
Th: 10a-4:30p Fr: 10a-4:30p Sa: closed Su: closed

Salonika Gyros ★★☆☆☆  \$ **A-1 • 84**
133 6th St, 412-261-4770 - casual attire
Th: 10:30a-12a Fr: 10:30a-12a Sa: 11a-12a Su: 11a-7p

Zorba's Gyros ★★☆☆☆ \$ **A-3 • 85**
400 Smithfield St, 412-471-9930
Th: 10:30a-4:30p Fr: 10:30a-3p Sa: closed Su: closed

GROCERY

Market Street Grocery ★★☆☆☆  \$\$ **A-2 • 86**
435 Market St, 412-281-3818 -
Th: 7a-9p Fr: 7a-9p Sa: 9a-7p Su: 9a-7p

Two Louie's Market ★★☆☆☆ \$ **C-1 • 87**
1233 Penn Ave, 412-586-5593 - Grocery
Th: 7a-6p Fr: 7a-6p Sa: closed Su: closed

INDIAN

India Palace ★★★★★ 🚚 \$\$ **A-1 • 88**
 137 6th St, 412-471-0660
 Th: 11a-3p, 5p-10p Fr: 11a-3p, 5p-10p Sa: 11a-3p, 5p-10p Su: closed

Indian Spices ★★★★★ \$ \$ **A-1 • 89**
 129 6th St, 412-281-1364 - casual attire
 Th: 11a-3pm, 5p-10p Fr: 11a-3pm, 5p-10p Sa: 12p-10p Su: 5p-9p

Sree's Authentic Indian Cuisine ★★★★★ 🟢 \$ **B-2 • 90**
 701 Smithfield St, 412-860-9181 - cash only
 Th: 11:30a-3p Fr: 11:30a-3p Sa: closed Su: closed

ITALIAN

Bella Notte Pizza Pasta & More ★★★★★ 🚚 \$\$ **Strip • 91**
 1914 Penn Ave, 412-281-4488
 Th: 11a-7p Fr: 11a-9p Sa: 9a-9p Su: 10a-5p

Buca di Beppo ★★★★★ \$ \$ **Off Map • 92**
 3 Station Sq, 412-471-9463 - See directions to Station Square on back cover
 Th: 11:00a-10p Fr: 11a-11p Sa: 11a-11p Su: 11a-9p

Lidia's Pittsburgh ★★★★★ 🇺🇸 \$ \$ **Strip • 93**
 1400 Smallman St, 412-552-0150
 Th: 11:30a-2p, 5p-9p Fr: 11:30a-2p, 5p-10p
 Sa: 11a-2:30p, 4:30p-10p Su: 11a-2:30p, 4:30p-9p

Peter Allen's ★★★★★ \$ \$ **A-2 • 94**
 613 Penn Ave, 412-642-6677
 Th: 11a-11p Fr: 11a-12a Sa: 11a-12a Su: 12p-7p

Pizzaiolo Primo ★★★★★ \$ \$ **A-2 • 95**
 8 Market Sq, 412-307-5263
 Th: 11a-11p Fr: 11a-11p Sa: 11a-11p Su: 12p-9p

Proper Brick Oven & Tap Room ★★★★★ \$ \$ **A-1 • 96**
 139 7th St, 412-281-5700
 Th: 11:30a-11p Fr: 11:30a-12a Sa: 11:30a-12a Su: 11a-9p

Sienna Mercato ★★★★★ \$ \$ **B-2 • 97**
 942 Penn Ave, 412-281-2810 - Bar remains open after Kitchen
 Th: 11a-12a Fr: 11a-12a Sa: 11a-12a Su: 11a-10p

Sunseri Jimmy & Nino ★★★★★ \$ **Strip • 98**
 1901 Penn Ave, 412-255-1100
 Th: 7:30a-3:45p Fr: 7:30a-3:45p Sa: 7:30a-3:45p Su: closed

Vallozzi's Pittsburgh ★★★★★ \$ \$ \$ **A-2 • 99**
 220 Fifth Ave, 412-394-3400
 Th: 11:30a-11p Fr: 11:30a-11p Sa: 4p-11p Su: closed

Villa Reale Restaurant ★★★★★ 🚚 \$ \$ **B-2 • 100**
 628 Smithfield St, 412-391-3963
 Th: 11a-10p Fr: 11a-10p Sa: 11a-6p Su: closed

MEDITERRANEAN

Alihan's Mediterranean Cuisine ★★★★★ 🚚 \$\$ **A-1 • 101**

124 6th St, 412-888-0630

Th: 11a-10p

Fr: 11a-11p

Sa: 11a-11p

Su: 11a-10p

Christos Mediterranean Grille ★★★★☆ 🟢 \$\$ **A-1 • 102**

130 6th St, 412-261-6442 - casual attire

Th: 11a-10:30p

Fr: 11a-10:30p

Sa: 11a-10:30p

Su: 11a-10:30p

Crystal ★★★★☆ 🚚 \$\$ **C-1 • 103**

1211 Penn Ave, 412-434-0480

Th: 11a-10p

Fr: 11a-11p

Sa: 12p-10p

Su: closed

Madonna's Mediterranean Cuisine ★★★★★ 🟢 \$ **A-3 • 104**

408 Smithfield St, 412-281-4693

Th: 10:30a-4p

Fr: 10:30a-4p

Sa: closed

Su: closed

MEXICAN

Bakersfield ★★★★★ \$\$ **B-2 • 105**

940 Penn Ave, 512-586-5024

Th: 11a-12a

Fr: 11a-2a

Sa: 11a-2a

Su: 11a-10p

Bea Taco Town ★★★★★ 🚚 🟢 \$ **B-2 • 106**

633 Smithfield St, 412-471-8361

Th: 11a-6p

Fr: 11a-6p

Sa: 11a-4p

Su: closed

Chipotle ★★★★★ 🟢 \$ **A-2 • 107**

211 Forbes Ave, 412-224-5586

Th: 10:45a-10p

Fr: 10:45a-10p

Sa: 10:45a-10p

Su: 10:45a-10p

Condado Tacos ★★★★★ \$\$ **B-2 • 108**

971 Liberty Ave, 412-281-9111 - Happy Hour 5p-7p

Th: 11a-2a

Fr: 11a-2a

Sa: 11a-2a

Su: 11a-2a

Las Velas ★★★★★ \$\$ **A-2 • 109**

21 Market Sq, 412-251-0031 - Happy Hour M-F 4p-6p, Bar open late Mon-Sat

Th: 11a-10p

Fr: 11a-11p

Sa: 11a-11p

Su: 12p-9p

Moe's Southwest Grill ★★★★★ 🟢 G \$ **A-2 • 110**

210 Forbes Ave, 412-224-4422

Th: 11a-9p

Fr: 11a-9p

Sa: 11a-9p

Su: 11a-9p

Qdoba Mexican ★★★★★ \$ **B-2 • 111**

808 Liberty Ave, 412-281-2415

Th: 10:30a-7p

Fr: 10:30a-7p

Sa: closed

Su: closed

Qdoba Mexican ★★★★★ \$ **B-3 • 112**

601 Grant St, 412-281-3143

Th: 11a-6p

Fr: 11a-6p

Sa: closed

Su: closed

MIDDLE EASTERN

Istanbul Grille ★★★★★ 🟢 \$ **B-3 • 113**

600 Grant St, 412-325-3346 - Can be hard to find; go down escalator, through glass doors, and down a long hallway

Th: 10:30a-3p

Fr: 10:30a-3p

Sa: closed

Su: closed

PIZZA

Café Milano ★★☆☆☆ 🚚 \$\$	A-1 • 114
134 6th St, 412-281-3131 - casual attire	
Th: 10a-2a	Fr: 10a-3a
Sa: 10a-3a	Su: 10a-2a
Domino's Pizza ★★☆☆☆ 🚚 \$	A-2 • 115
300 6th Ave, 412-288-8989	
Th: 10a-2a	Fr: 10a-4a
Sa: 10a-4a	Su: 10a-2a
Giovanni's Pizza and Pasta ★★☆☆☆ 🚚 \$\$	A-1 • 116
123 6th St, 412-281-7060	
Th: 9a-1a	Fr: 9a-2a
Sa: 10a-2a	Su: 10a-1a
Joe & Pie ★★☆☆☆ 🚚 \$	B-2 • 117
955 Liberty Ave, 412-402-0444	
Th: 7a-11p	Fr: 7a-1p,2:30p-12a
Sa: 7a-12a	Su: 8a-11p
La Gondola Pizzeria Restaurant ★★☆☆☆ 🚚 \$	A-2 • 118
4 Market Sq, 412-261-5252	
Th: 10:30a-8p	Fr: 10:30a-8p
Sa: closed	Su: closed
Mamma Lucia's ★★☆☆☆ 🚚 \$	A-2 • 119
433 Wood St, 412-281-0416	
Th: 9a-6p	Fr: 9a-6p
Sa: 11a-5p	Su: closed
Pizza Parma ★★☆☆☆ 🚚 \$	B-2 • 120
823 Penn Ave, 412-577-7300 - casual attire	
Th: 10a-1a	Fr: 10a-2a
Sa: 10a-2a	Su: 10a-1a

POLISH

Stuff'd ★★☆☆☆ \$\$	A-1 • 121
130 7th St, 412-567-5077	
Th: 11a-11p	Fr: 11a-2a
Sa: 11a-2a	Su: 11a-11p

SALADS

Earth Inspired Salads ★★☆☆☆ 🟩 \$\$	A-2 • 122
218 Fifth Ave, 412-281-1113	
Th: 7a-5p	Fr: 7a-5p
Sa: closed	Su: closed
Earth Inspired Salads ★★☆☆☆ 🟩 \$\$	B-2 • 123
611 William Penn Pl, 412-471-1927	
Th: 7a-6p	Fr: 7a-6p
Sa: closed	Su: closed
Hello Bistro ★★☆☆☆ 🟩 \$	A-3 • 124
292 Forbes Ave, 412-434-0100	
Th: 6a-8p	Fr: 6a-8p
Sa: 9a-7p	Su: 9a-7p

SANDWICHES

Cafe 808 ★★☆☆☆ 🚚 \$	B-2 • 125
808 Penn Ave, 412-745-2233	
Th: 7a-2p	Fr: 7a-2p
Sa: closed	Su: closed

NOTE: Dining Guide listings continue after maps on the following pages.

A

E

1

2

3

TENTH ST BYPASS

FORT DUQUESNE BLVD

PENN AVE

LIBERTY AVE

Wood Street

WOOD ST

SMITHFIELD ST

FIFTH AVE

FORBES AVE

SIXTH ST

SEVENTH ST

EIGHTH ST

NINTH ST

FIFTH AVE

129
145

61

51

135
118

77

110

9

25,26

124

156

10

145

30

14

109

143

144

122

35

99

126

107

65

17

7

81

6

157

17

19

150

160

137

116

89

84

88

94

18

36

46

96

121

120

101

102

114

40

133

24

34

165

44

63

73

129

61

51

135

118

110

9

25,26

124

156

10

145

30

14

109

143

144

122

35

99

126

107

65

17

7

81

6

157

17

19

150

160

137

116

89

84

88

94

18

36

46

96

121

120

101

102

114

40

133

24

34

165

44

63

73

129

61

51

135

118

110

9

25,26

124

156

10

145

30

14

109

143

144

122

35

99

126

107

65

17

7

81

6

157

17

19

150

160

137

116

89

84

88

94

18

36

46

96

121

120

101

102

114

40

133

24

34

165

44

63

73

129

61

51

135

118

110

9

25,26

124

156

10

145

30

14

109

143

144

122

35

99

126

107

65

17

7

81

6

157

17

19

150

160

137

116

89

84

88

94

18

36

46

96

121

120

101

102

114

40

133

24

34

165

44

63

73

129

61

51

135

118

110

9

25,26

124

156

10

145

30

14

109

143

144

122

35

99

126

107

65

17

7

81

6

157

17

19

150

160

137

116

89

84

88

94

18

36

46

96

121

120

101

102

114

40

133

24

34

165

44

63

73

129

61

51

135

118

110

9

25,26

124

156

10

145

30

14

109

143

144

122

35

99

126

107

65

17

7

81

6

157

17

19

150

160

137

116

89

84

88

94

18

36

46

96

121

120

101

Allegheny River

3

C

For continuation see Strip District map on back cover

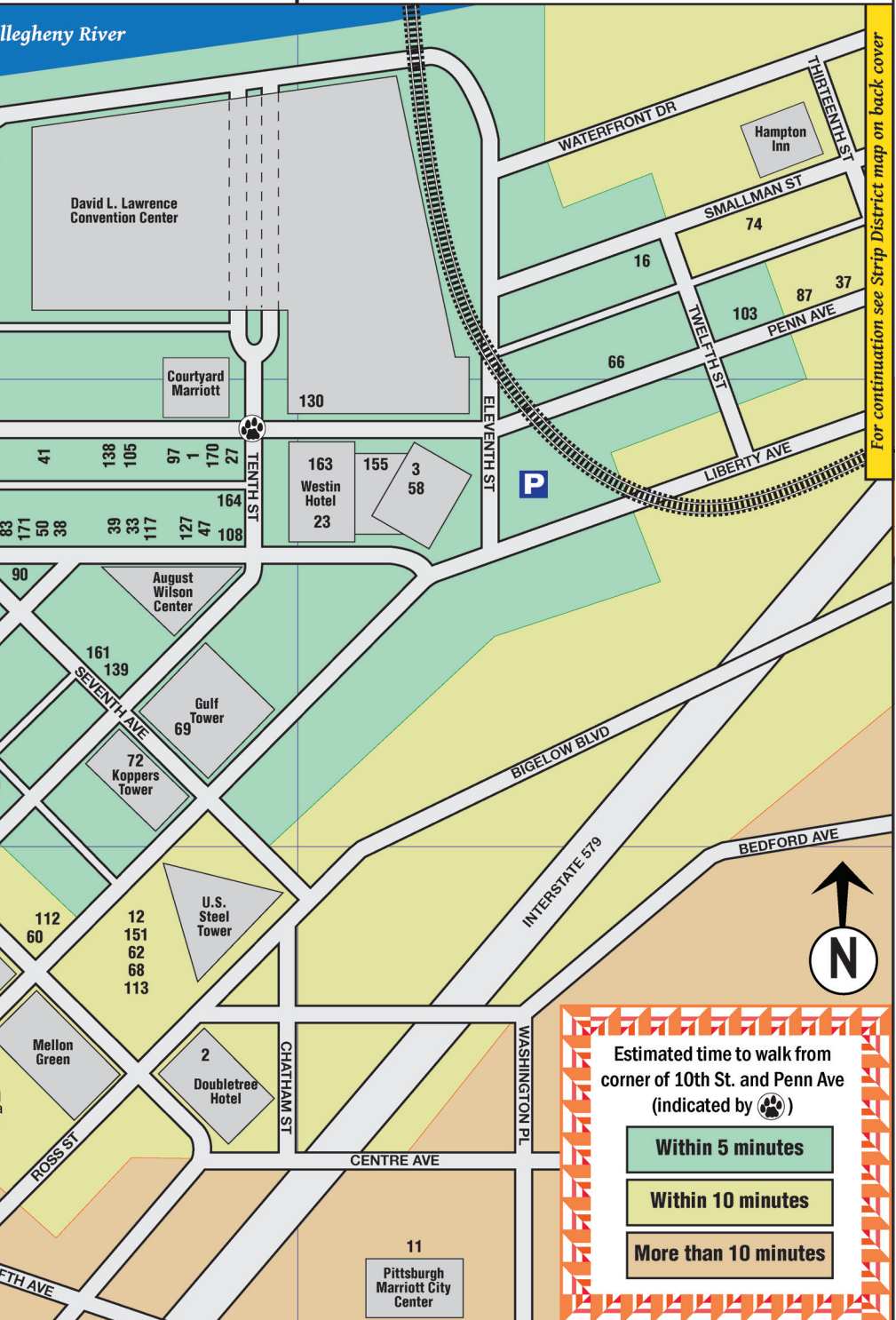

Estimated time to walk from
corner of 10th St. and Penn Ave
(indicated by 🐾)

- Within 5 minutes
- Within 10 minutes
- More than 10 minutes

SANDWICHES

DiBella's Old Fashioned Subs ★★★★★☆ 🚚 \$	A-2 • 126
16 Market Sq, 412-338-8634 - limited selection for vegetarians	
Th: 10a-9p	Fr: 10a-9p
Sa: 10a-9p	Su: 10a-7p
Fernando's Café ★★★★★☆ 🚚 \$	B-2 • 127
963 Liberty Ave, 412-281-4522	
Th: 10a-10:45p	Fr: 10a-10:45p
Sa: 10a-10:45p	Su: 10a-10:45p
Jimmy John's ★★★★★☆ 🚚 \$	B-3 • 128
501 Grant St, 412-281-3474	
Th: 11a-9p	Fr: 11a-9p
Sa: 11a-9p	Su: 11a-9p
Jimmy John's ★★★★★☆ 🚚 \$	A-2 • 129
506 Liberty Ave, 412-697-0999	
Th: 10:30a-7:30p	Fr: 10:30a-7:30p
Sa: 10:30a-6p	Su: closed
Jimmy John's ★★★★★☆ 🚚 \$	C-2 • 130
1027 Penn Ave, 412-224-6440	
Th: 11a-9p	Fr: 11a-9p
Sa: 11a-9p	Su: 11a-9p
Penn Station East Coast Subs ★★★★★☆ \$	B-2 • 131
808 Liberty Ave, 412-803-7366	
Th: 10a-8p	Fr: 10a-8p
Sa: 10a-8p	Su: closed
Peppi's Old Tyme Sandwich Shoppe ★★★★★☆ 🚚 \$	Strip • 132
1721 Penn Ave, 412-562-0125 - casual attire	
Th: 10a-5p	Fr: 10a-5p
Sa: 10a-8p	Su: 11a-3:30p
Pork & Beans ★★★★★☆ \$\$	A-1 • 133
136 6th St, 412-338-1876	
Th: 11:30a-2p, 4p-10p	Fr: 11:30a-11p
Sa: 11:30a-11p	Su: 3p-9p
Primanti Brothers ★★★★★☆ \$	Strip • 134
46 18th St, 412-263-2142 - Accepts Credit cards	
Th: 24 hours	Fr: 24 hours
Sa: 24 hours	Su: 24 hours
Primanti Brothers ★★★★★☆ \$	A-2 • 135
2 Market Sq, 412-261-1599 - Accepts Credit cards	
Th: 10a-12a	Fr: 10a-2a
Sa: 10a-2a	Su: 10a-12a
Sammy's Famous Corned Beef ★★★★★☆ \$	B-2 • 136
901 Liberty Ave, 412-765-2244	
Th: 9a-11p	Fr: 9a-11p
Sa: 9a-11p	Su: closed
Subway ★★★★★☆ \$	A-2 • 137
703 Liberty Ave, 412-434-7827	
Th: 6:30a-10:30p	Fr: 6:30a-10:30p
Sa: 8a-9p	Su: 9a-9p
Subway ★★★★★☆ \$	B-2 • 138
930 Penn Ave, #2, 412-281-7335	
Th: 7a-10p	Fr: 7a-10p
Sa: 8a-10p	Su: 9a-8p
Subway ★★★★★☆ \$	B-2 • 139
411 7th Ave, 412-391-3177	
Th: 6a-10p	Fr: 7a-9p
Sa: 8a-6p	Su: 9a-5p

SEAFOOD

Andy's Sushi Bar at Wholey's ★★★★★☆ \$\$\$ **Strip • 140**
1711 Penn Ave, 412-281-8272
Th: 10a-5p Fr: 10a-5p Sa: 10a-5p Su: 10a-5p

Eddie V's Prime Seafood ★★★★★☆ \$\$\$ **B-3 • 141**
501 Grant St, 412-391-1714
Th: 4p-10p Fr: 4p-11p Sa: 4p-11p Su: 4p-9p

McCormick & Schmick's ★★★★★☆  \$\$\$ **A-2 • 142**
301 5th Ave, 412-201-6992
Th: 11a-9p Fr: 11a-10p Sa: 4p-10p Su: 4p-8p

No 1. Sushi Sushi ★★★★★☆ \$\$\$ **A-2 • 143**
436 Market St, 412-251-5510
Th: 11a-8p Fr: 11a-8p Sa: closed Su: closed

Original Oyster House ★★★★★☆ \$ **A-2 • 144**
20 Market Sq, 412-566-7925 - cash only
Th: 10a-10p Fr: 10a-10p Sa: 10a-10p Su: 11a-7p

Pittsburgh Poke ★★★★★☆ \$\$\$ **A-2 • 145**
500 Liberty Ave, 412-338-2199
Th: 11a-7p Fr: 11a-7p Sa: 11a-7p Su: closed

Robert Wholey and Co. Fish Market ★★★★★☆ \$\$\$ **Strip • 146**
1711 Penn Ave, 412-391-3737
Th: 8a-5:30p Fr: 8a-6p Sa: 8a-5p Su: 9a-4p

Roland's Seafood Grill ★★★★★☆ \$\$\$ **Strip • 147**
1904 Penn Ave, 412-261-3401 - Kitchen closes earlier than bar
Th: 11a-12a Fr: 11a-2a Sa: 11a-2a Su: 11a-12a

STEAKHOUSES

Capital Grille, The ★★★★★☆ \$\$\$\$ **A-2 • 148**
301 5th Ave, 412-338-9100 - dressy
Th: 11a-10p Fr: 11a-11p Sa: 4p-11p Su: 4p-9p

Fogo de Chao Brazilian Steakhouse ★★★★★☆ \$\$\$ **B-3 • 149**
525 Smithfield St, 412-312-5001
Th: 11a-3p, 5p-10:30p Fr: 11a-3p, 5p-11p Sa: 11a-11p Su: 11a-10p

Morton's The Steakhouse ★★★★★☆ \$\$\$\$ **A-2 • 150**
625 Liberty Ave, #180, 412-261-7141
Th: 5p-10p Fr: 5p-11p Sa: 5p-11p Su: 5p-10p

Red The Steakhouse ★★★★★☆ \$\$\$\$ **B-3 • 151**
600 Grant St, 412-745-6328
Th: 3p-10p Fr: 3p-11p Sa: 3p-11p Su: closed

SWEETS AND TREATS

Katie's Kandy ★★★★★☆ \$\$\$ **A-3 • 152**
422 Wood St, 412-227-0999 -
Th: 10a-8p Fr: 10a-8p Sa: 11a-5p Su: 11a-5p

SWEETS AND TREATS

Katie's Kandy ★★☆☆☆☆ \$\$ **A-2 • 153**
 120 Fifth Ave, 412-594-7039 - Fifth Avenue Place, Lower Level
 Th: 10a-6p Fr: 10a-6p Sa: 10a-3p Su: closed

Katie's Kandy **B-2 • 154**
 709 Liberty Ave, 412-594-7039
 Th: 10a-8p Fr: 10a-8p Sa: 11a-5p Su: 11a-5p

Katie's Kandy **C-2 • 155**
 1000 Penn Ave, 412-734-5586 - Federated Building, Westin Lobby
 Th: 9a-7p Fr: 9a-7p Sa: 8a-5p Su: 8a-3p

Millie's Homemade Ice Cream ★★☆☆☆☆ \$ **A-3 • 156**
 264 Forbes Ave, 412-709-6579
 Th: 11a-10p Fr: 11a-11p Sa: 11a-11p Su: 11a-10p

Sinful Sweets Chocolate Company ★★☆☆☆☆ \$\$ **A-2 • 157**
 539 Liberty Ave, 412-720-1381
 Th: 11a-9p Fr: 11a-9p Sa: 11a-9p Su: 12p-5p

THAI

Little Bangkok on the Strip ★★☆☆☆☆ \$\$ **Strip • 158**
 1906 Penn Ave, 412-586-4107
 Th: 11:30a-3p, 5p-9p Fr: 11a-2p, 5p-9p Sa: 11a-3p, 5p-9p Su: closed

Nicky's Thai Kitchen ★★☆☆☆☆ V G \$\$ **B-2 • 159**
 903 Penn Ave, 412-471-8424
 Th: 11:30a-3,5-10p Fr: 11:30a-3,5-10:30p Sa: 11:30a-3,5-10:30p Su: 5p-9p

CONVENIENCE & NEWSSTANDS

7-Eleven Stores ★★☆☆☆☆ \$ **A-2 • 160**
 643 Liberty Ave, 412-261-3248
 Th: 24 hours Fr: 24 hours Sa: 24 hours Su: 24 hours

Extra Extra News & Variety **B-2 • 161**
 413 7th Ave, 412-471-7655
 Th: 6:15a-6p Fr: 6:15a-6p Sa: closed Su: closed

Faber, Coe, & Gregg **B-3 • 162**
 600 Grant St, 412-471-4795
 Th: 7a-6p Fr: 7a-6p Sa: closed Su: closed

Faber, Coe, & Gregg **C-2 • 163**
 1000 Penn Ave, 412-261-4449
 Th: 7a-6p Fr: 7a-6p Sa: closed Su: closed

Kwik-E-Mart **B-2 • 164**
 212 10th St, 412-246-2000
 Th: 6a-9:30p Fr: 6a-9:30p Sa: 6a-5p Su: 8a-5p

Liberty News **A-2 • 165**
 602 Liberty Ave, 412-281-9772
 Th: 7a-7p Fr: 7a-7p Sa: 8:30a-7 Su: closed

DRUG STORES

CVS Pharmacy **A-3 • 166**
429 Smithfield St, 412-261-4846
Th: 6a-7p Fr: 6a-7p Sa: 8a-6p Su: 10a-6p

CVS Pharmacy **A-2 • 167**
242 Fifth Ave, 412-566-2619
Th: 6a-7p Fr: 6a-7p Sa: 8a-6p Su: 10a-6p

Rite-Aid **B-2 • 168**
623 Smithfield St, 412-471-8882
Th: 7a-8p Fr: 7a-8p Sa: 9a-6p Su: 11a-4p

PHOTOCOPIES & SHIPPING

ColorPerfect Printing **B-2 • 169**
804 Penn Ave, 412-288-2525
Th: 8:30a-5p Fr: 8:30a-5p Sa: closed Su: closed

FedEx Copy Print & Ship Center **B-2 • 170**
960 Penn Ave, 412-391-2014
Th: 7:30a-9p Fr: 7:30a-9p Sa: 8a-6p Su: closed

Minuteman Press **B-2 • 171**
905 Liberty Ave, 412-471-5599
Th: 8:30a-4:30p Fr: 8:30a-4:30p Sa: closed Su: closed

POINTS OF INTEREST

National Aviary **Off Map • 172**
700 Arch St, 412-323-7235 - www.aviary.org - Show badge for \$10 admission!
Th: 10a-5p Fr: 10a-5p Sa: 10a-5p Su: 10a-5p

Pittsburgh Zoo & PPG Aquarium **Off Map • 173**
7340 Butler St, 412-665-3640 - www.pittsburghzoo.org
Th: 9a-5p Fr: 9a-5p Sa: 9a-5p Su: 9a-5p

ATM LOCATIONS

Bank of America
301 Fifth Ave

Citizen's Bank
525 William Penn Pl

Dollar Bank
400 5th Ave - Kaufmann's
340 4th Ave
537 Smithfield St - Oliver Building
David Lawrence Conv. Center, DLCC

First Commonwealth Bank
501 Grant St - August Wilson Center

First National Bank
559 Grant St - Smithfield Street Cafe
210 Sixth Ave - Cricket
707 Grant St - Gulf Tower

Huntington Bank
650 Smithfield St
0 Wood St
429 Smithfield St

PNC Bank
1000 Liberty Ave - Moorehead Fed. Bldg.
1001 Liberty Ave - Liberty Center
411 7th Ave - Duquesne Light
436 7th Ave - Koppers Building
600 Grant St - Steel Plaza Office
625 Liberty Ave - Dominion Tower
643 Liberty Ave - 7-Eleven
6th Ave & Wood St - T - Wood St. Station

Please Note

The skybridge stairs lead to the Ballroom only. For easier access to the Dealers' Room, Art Show, or Artists' Alley, please use the ground-level entrance to the Convention Center. Please reserve the elevators in the Skybridge for fursuiters and persons with physical disabilities.

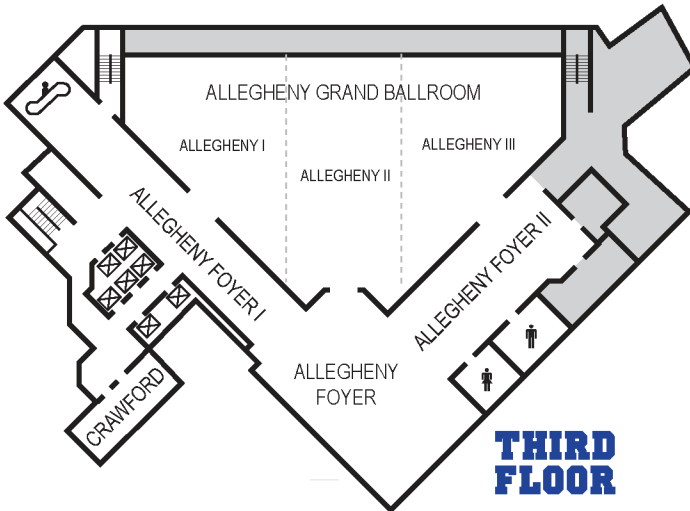
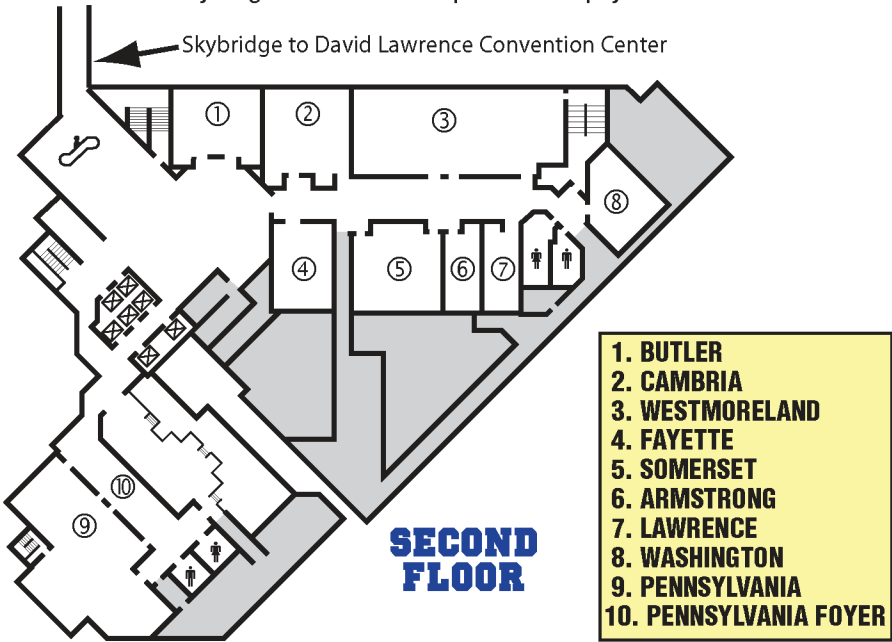

YOUR feedback helps improve our Dining Guide.

Comments are always welcome! Let us know what you liked or didn't like!

E-mail book@anthrocon.org or visit www.anthrocon.org/survey

Follow us on Twitter!



@AnthroconDining

DEALERS' ROOM MAP & INDEX

ART SHOW (Hall B/C)

Friday, July 6:

10am: Artist check-in begins

2-6pm: Art Show open to bidders

9-11pm: Artists & Dealers Reception (by invitation only)

Saturday, July 7:

10am-6pm: Art Show open to bidders

6pm: Mature Gallery written bidding closes

11pm: Mature Gallery voice auction begins (DLCC 413-415)

Sunday, July 8:

10am-Noon: General Gallery open to bidders

Noon: General Gallery written bidding closes

2pm: General Gallery voice auction begins (DLCC 413-415)

2-5pm: Sales, artist check-out

DEALERS' ROOM (Hall B)

Friday, July 6:

Noon – 6 p.m.: (11:45 a.m. Sponsor Admission)

Saturday, July 7:

10 a.m. – 6 p.m.: (9:50 a.m. Sponsor Admission)

Sunday, July 8:

10 a.m. – 4 p.m.: (9:50 a.m. Sponsor Admission)

ARTISTS' ALLEY/CON STORE (Hall C)

Friday, July 6: 12 p.m. – 5 p.m.

Saturday, July 7: 10 a.m. – 5 p.m.

Sunday, July 8: 10 a.m. – 3 p.m.

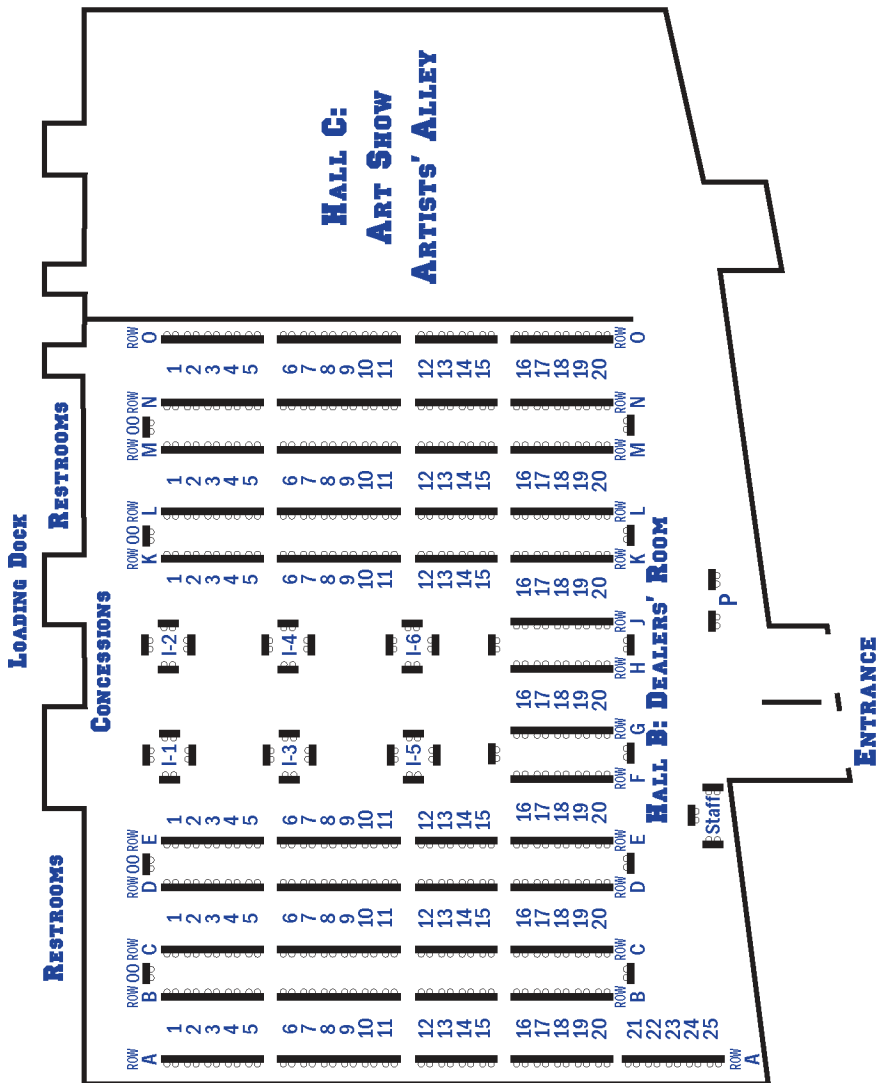

The table below lists the dealers who are confirmed for the 2018 convention as of May 22nd, 2018. Note that the table locations are denoted by a letter followed by a number (such as A15). This represents the row (A through P) and the table number in that row (1 through 25). Tables at the end of a row are listed by both row numbers and the table number (such as B00C or D21E). **TABLES MAY CHANGE BEFORE THE CONVENTION!**

Dealer NameLocation

123 Paprika	O11
A Thousand Raspas	J20
A True Blue Artist.....	L09
Aisu Art	N08
Apricity Hats & Cosplay Wear	E13/E14
AR.GI.BI Creative Studio.....	M16
Art by Sandy Schreiber.....	B16
Art of Lovewin.....	K08
ArtKour	N09
Ask Jam/Peaches and Cream	K02/K03
B3Mascots.....	B02/B03
Beta Raptor Creations	E16
Bill Holbrook	A25
Boneitis Industries	O06/O07
Bunnies And Cream.....	D08/09
Byrnas Books	B08
Cabbits Co.....	K16
Candyfoxy.....	B05
Caribou Ink	B17
Carpet Shark Studio	F18
Carriou Cupcake.....	E17
Chakat Windshear's Wares	M06/M07
Chakat's Den.....	M08
Chance and SkippyLynn.....	N02
Charity - South Hills Pet Rescue	H21J
Charity Auction & Information	H16-H20
Chantal Moosher	L02
Chibi Tsubame Creations	O16/O17
Cinnamon Cune.....	E04
CloverPuff.....	K14/K15
Coey & Shy.....	N16/N17
Cooner Arts!.....	K07
Crazdude.....	O13/O14
Cryptovolans.....	M15
CrocShop.....	J16
Cross' Critters.....	D13
D'ahnya R Trainer.....	A19
Dark Natasha.....	B18
David Lillie	N04
Dead Dragon Designs	C17
Diana Stein.....	C15

Dealer NameLocation

DiZZiNESS	C18
Dreamvision Creations	C06/C07/C08/C09
Dutch	E05
Eric Strother.....	K00L
Fay V.	M04
FeretStudios	N03
Flinters' RudeRoo Design.....	K12/K13
Foxes and Peppers	K18
Fuzzimutt Creations.....	K09
Furplanet Productions	A13/A14/A15
FurScience	P03
FursuitSupplies.com	M00N/M01/N01
gBlazeWear, LLC.....	L11/L12
Guest Of Honor - Ursula Vernon	D21E
Guest Of Honor - Len Simon	F21G
Gideon's Corral.....	K04
Gold Star Anime and Games.....	D00E/D01/E01
GoldenDruid	K19
GreyElf Graphics	L14/L15
Health and Mana Studios	B06
Heliopause Productions (Agent Elrond)	C19
Heather Bruton Illustration.....	C16
Hibbary	L01
Honeck Sculpture	E11/E12
Hopeful Monster Studios	B21C
How Bout Meow	E18
Hyena Agenda	I04
Inanimorphs and Choco Pony Tarot	B13/B14
INKtiger	D02
Ishaway	C02
Jarlidium Press	K11/K12
Joshiah's Written Works	K17
Just Peachie.....	C11/C12
Kacey Miyagami	D05
Kaitlin J Conrad	E07
Kaysha Siemens Illustration	N19
Keedot	M19
Kirsten "Tidma" Fugett Illustrations.....	C04
Kopes Kreations	M21N
Kozy Koza	E20
Lagarto Custom Leather.....	I05
Lemonbrat Studios	O01/O02/O03
Len Simon	F21G
Likeshine	J17
Lithe-Fider Creatures.....	J18
Lizardbeth.....	D20
Lizard Lamination	E06
Lock & Key Curiosities.....	A12
Lydiarts and Crafts	L13
M & T Comics	M02/M03
Made by Muttmix / Kawaiiidoggo.....	N13/N14
MajikCraft	A23/A24
Mango Island	O04/O05

Dealer NameLocation

Mangopoptart A20A
 Marci McAdam B16
 Mariposa Miniatures L19
 Mary Mouse - Certified Tags E10
 Massage Therapy - Paws And Relax P02
 Mastergodai O12
 Melissa Mendelson Art L14
 Michelle Light B19
 Misc Etc N06/N07
 Mitch DLG E09
 Monster Cat Creations G18
 Moss D07
 Moth Monarch C20
 Naomi Romero C10
 Naughty By Nature A11
 NeonSlushie D10
 Nightengale Needles D06/D07
 NightlineZ G17
 Northwest Furry Trading Company Ltd K06
 OffWorld Designs B01/B00C/C01
 Out of the Blue Creation O17/O18
 Otterly Amazing I06
 Pacific Autumn L16
 Padma Bhujaga - The Art of SoulsPoison C05
 Painted Dog K20
 Panda Fuzz K21L
 Paw to Press A06/A07
 Pawesomecostumes M04/M05
 Paws and Relax Massage P01
 Penndarr A05
 Pinku Shika Art N11/N12
 Pixel And The Wolf L05
 Pixel Visions B20
 Plaguerat's Baubles M17
 PlanetPlush E19
 Plesiosaur Bones B15
 Pocket Sushi D15
 PomGon's Printing Service B09
 Poofinburd B08
 Pookatdinocrafts M09
 Positive Elegance Studios F20
 Princess Rei K10
 Pupcakes and Cupcats E15
 RabbiTom M12
 Rage Studios LLC B10
 RCSI Publishing M11
 Rebecca Rodriguez A23
 Red Falcon I02
 RedCoatCat D03
 Roan RPG D14
 Robyn Rewynd Williams K05
 Royalty A20B
 Roz Gibson D11

Dealer NameLocation

Rukis O19/O20
 Rysingson Accessories B12
 S.Radcid J19
 Samantha Laviola N14/N15
 Sanguine Games f17
 Sarahcat O15
 Sassypants L17
 ScrapTeeth D09
 Scrolling Fantasy M20
 Sew & Tell L20
 Seward Street Studios K06/K07/K08
 Shannon Hall N05
 Shawntae Howard D12
 Sheepingly N20
 ShinigamiGirl D04
 Shottsy Arts M13/M14
 SixthLeafClover N10
 SkieBorne Art B11
 Skulldog Studio C03
 Snaggy Peets O13
 Snow Paws C13
 Sofawolf Press, Inc A16/A17/A18
 Space Cat Creations B07
 Sparkle Kreations I03
 SpartaDog Illustration M17/M18
 Stablercake Art+Illustration N18
 Static Claws F15G/F16/G16
 Steamed & Punk'd I01
 Stephen M. Scott C14
 Stone Studios A22
 Stormfire's Eyrie E08
 Studio Cute K01/K02
 Sugar Bunny Shop A08/A09/A10
 Tail Kiss Studio A21
 Talenshi Illustration & Design A19B
 Tani Da Real B14
 Teaberry Workshop F19
 Tentaclefriendly L10
 The Bead Shoppe P02
 The Dragon's Lair A01/A02/A03/A04
 The Gneech/Suburban Jungle K16
 The Garment Goddess D16/D17
 The Katbox O08/O09/O10
 The Knotty Fox Creations L03/L04
 Tiger Torre Art H15J
 Tomo Creations B04
 Toy Pony Studios G19/G20
 Ursula Vernon B14/B15
 Whinges L18
 Windfalcon D19

CONVENTION CENTER [1ST FLOOR]

DLCC FIRST FLOOR

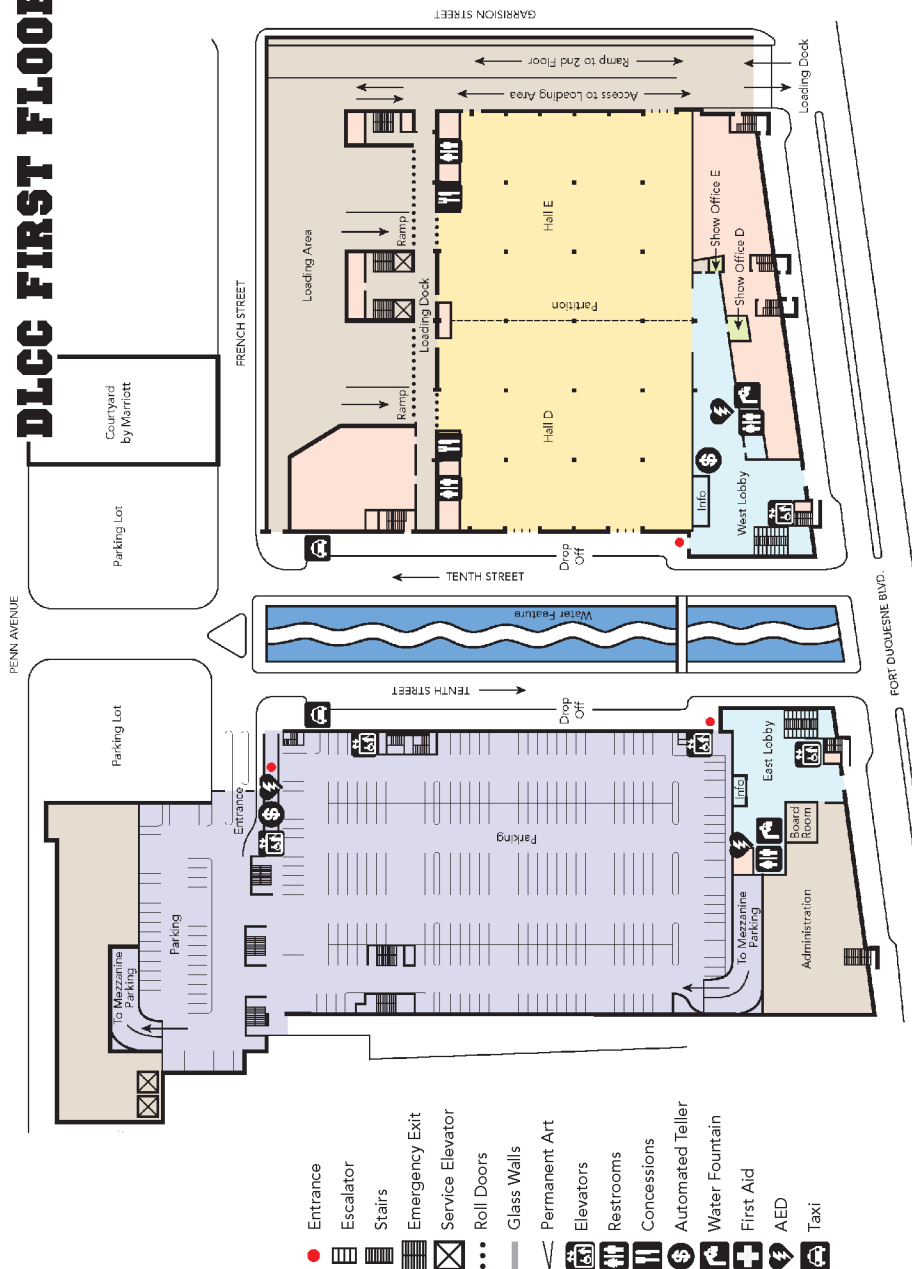

YOUR feedback helps improve our Dining Guide.

Comments are always welcome! Let us know what you liked or didn't like!
E-mail book@anthrocon.org or visit www.anthrocon.org/survey

Follow us on Twitter!

 @AnthroconDining

CONVENTION CENTER [2ND FLOOR]

DLCC SECOND FLOOR

Skywalk to the Westin Hotel

NOTICE

The skywalk stairs lead to the Ballroom only. For easier access to the Dealers' Room, Art Show, and Artists' Alley, please use the ground-level entrance. Please reserve the elevators in the skywalk for fursuiters and persons with physical disabilities.

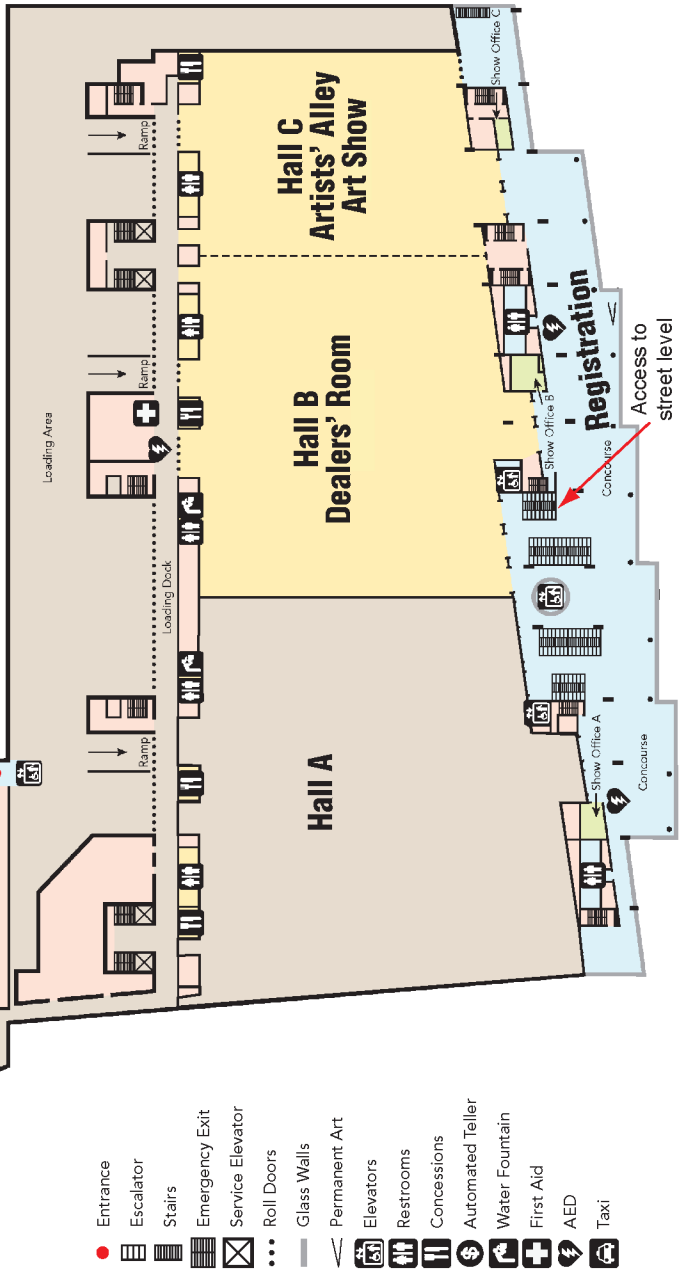

- Entrance
- Escalator
- Stairs
- Emergency Exit
- Service Elevator
- Roll Doors
- Glass Walls
- Permanent Art
- Elevators
- Restrooms
- Concessions
- Automated Teller
- Water Fountain
- First Aid
- AED
- Taxi

Registration: Concourse B

Thursday, July 5: Pre-registration only: Noon-2 p.m.
 On-site registration: 2 p.m.-10 p.m.
 Friday, July 6: 9 a.m.-10 p.m.
 Saturday, July 7: 10 a.m.-6 p.m.
 Sunday, July 8: 10 a.m.-4 p.m.

After hours pre-reg badge pick-up:
 Pre-registered badges are brought to Con Ops (DLCC Room 309) after registration closes and are available for after hours pick up until Con Ops closes.

CONVENTION CENTER [3RD FLOOR]

DLCC THIRD FLOOR Con Ops: Room 309

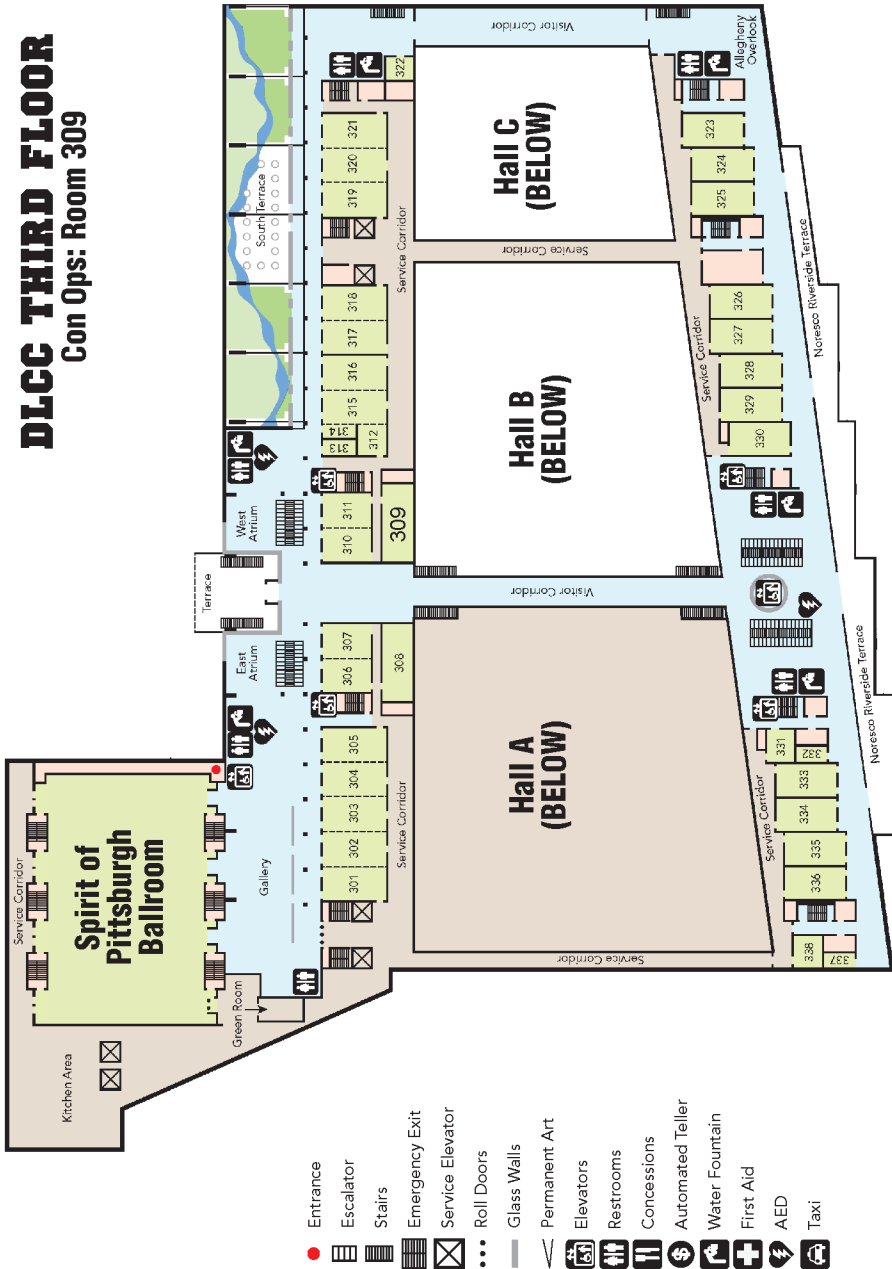

Con Ops will be open in Room 309 the following hours:

Thu: 9 a.m.-2 a.m. • Fri: 9 a.m.-2 a.m. • Sat: 9 a.m.-2 a.m. • Sun: 9 a.m.-7 p.m.
 At all other times, including all Wednesday, 2 a.m.-9 a.m. Thursday-Saturday, and Sunday after 7 p.m., Con Ops will also be in the Crawford Room, located on the third floor of the Westin Hotel, just off of the elevators.

CONVENTION CENTER [4TH FLOOR]

DLCC FOURTH FLOOR

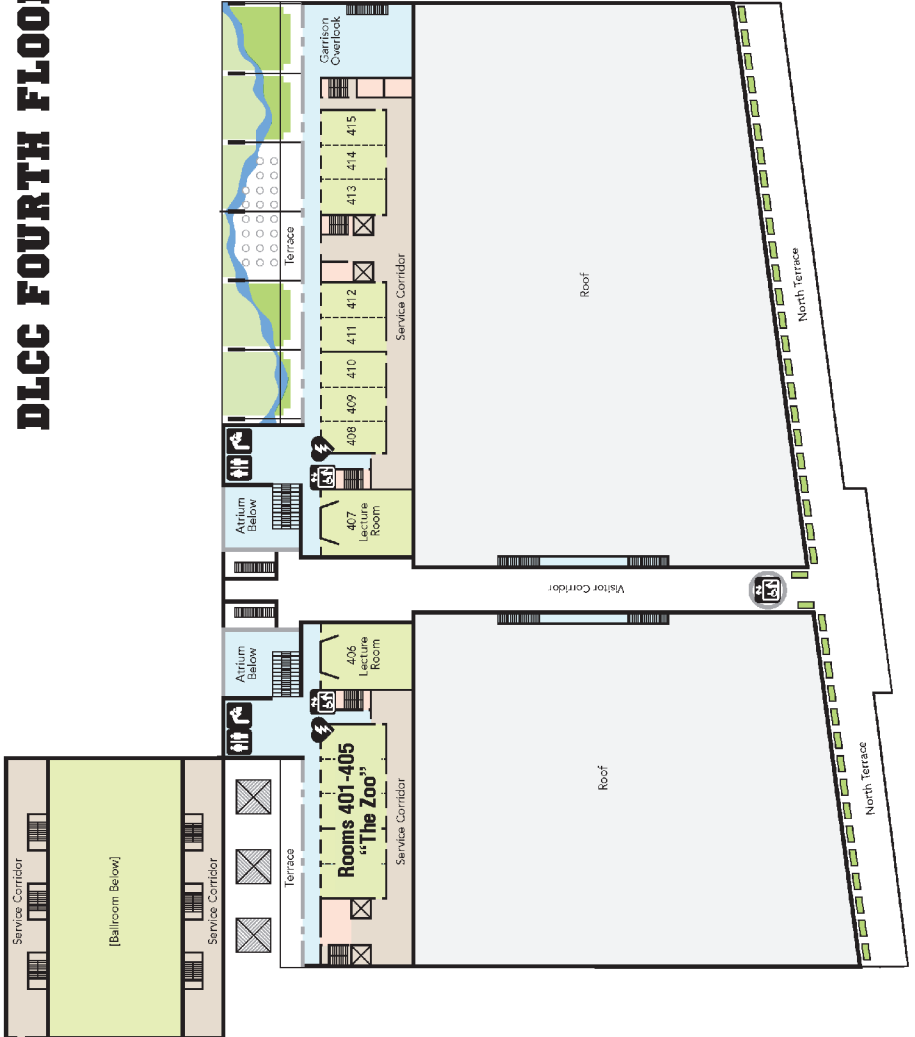

- Entrance
- ▤ Escalator
- ▥ Stairs
- ▧ Emergency Exit
- ▨ Service Elevator
- ⋯ Roll Doors
- ▬ Glass Walls
- ▭ Permanent Art
- ♿ Elevators
- ♿ Restrooms
- ♿ Concessions
- ♿ Automated Teller
- ♿ Water Fountain
- ♿ First Aid
- ♿ AED
- ♿ Taxi

YOUR feedback helps improve our Dining Guide.

Comments are always welcome! Let us know what you liked or didn't like!
 E-mail book@anthrocon.org or visit www.anthrocon.org/survey

Follow us on Twitter!

 @AnthroconDining

CHARITY AUCTION & RAFFLE

Auction:

- Display: Charity's Table in the Dealers' Room, during Dealers' Room hours until auction.
- Donations accepted at the Display when available Thursday, and from 9 a.m.-Dealers' Room close on Friday.
- Event: Sunday, 12:00 p.m.-1:00 p.m., DLCC 413-415.

Raffle:

- Display: Charity's Table in the Dealers' Room, during Dealers' Room hours from Friday through Saturday.
- Donations accepted at the Display when available Thursday, and from 9am-Dealers' Room close on Friday.
- Buy tickets at Charity table and place tickets at the Display.
- Winning ticket numbers displayed on Sunday.
- Items must be claimed at Display on Sunday.



Ashley Rittle, President, South Hills Pet Rescue

The genre of anthropomorphics is a field that deals heavily in the thematic appreciation of animals crossed to varying degrees with humans resulting in fantastic, intelligent characters and marvelous new imaginary species. However, we should never overlook the real-life counterparts to this mix and assist our animal friends in any way we can to ensure a better future for all of us.

This year, Anthrocon has chosen to support South Hills Pet Rescue (SHPR). SHPR strives to rescue, rehabilitate, and rehome dogs of all breeds, with all needs. From their representatives:

Nick Ferraro ran South Hills Pet Resort, a boarding and training facility, and purchased it in 2012. Ashley Rittle was having a hard time with her dog, and called Nick to request his training services. Little did they know the adventure ahead; they were married in June 2013, and that August, they were asked to help a local animal rescue that had been overwhelmed with dogs pulled from high-kill shelters set to be euthanized for behavioral issues. They agreed to take 13 dogs, but 62 dogs were dropped off at their door filling all of the Resort's boarding kennels. Nick and

Ashley cared for all 62 of these dogs in need, rehabilitating them before finding each dog a forever home. Ashley will tell you this is the moment they knew what they had to do. The plan was to dedicate ten of the Resort's boarding kennels to dog rescue, but as we all know, plans often change.

Today, South Hills Pet Rescue (SHPR), an independent 501(c)3 nonprofit organization, houses an average of 50 rescue dogs at all times. Apart from three part-time staff members who care for the dogs onsite, SHPR is run by volunteers. Your support of SHPR directly helps dogs in need!

You can visit the South Hills Pet Rescue website at southhillspetrescue.org for more information.

South Hills Pet Rescue's representatives will be on hand during the Charity Auction to receive bidders' payments, and throughout the weekend at their Dealers' Room table and Raffle display selling tickets and accepting donations. Anthrocon staff does not handle Auction payments or ticket sales. At South Hills Pet Rescue's table in the Dealers' Room, you can also receive further information on their organization.

The Anthrocon Charity Auction & Raffle will be supporting this beneficial charity by auctioning and raffling items donated by artists, dealers, and other generous donors who have provided us with artwork, merchandise, and other items without requesting anything in return to help raise money for this year's chosen charity.

Last year, the event raised over \$16,300 (events total; convention total: \$37,598) for Hope Haven Farm Sanctuary. Since 1997, Anthrocon has raised over \$310,000 for various charities, including Therapy Dogs, Whiskers, the Great Valley Nature Center, the National Greyhound Adoption Program, Reins of Life, Canine Partners for Life, Support Our Shelters, Forgotten Felines & Fidos, Greater Philadelphia Search & Rescue, Western Pennsylvania National Wild Animal Orphanage, Animal Friends, Pittsburgh Parrot Rescue, the Animal Rescue League of Western PA Wildlife Rehabilitation Center, Fayette Friends of Animals, The Toonseum, Hello Bully, Equine Angels Rescue, The National Aviary, the Western PA Humane Society, and the Pittsburgh Zoo & PPG Aquarium.

Raffle tickets can be bought and submitted at South Hills Pet Rescue's table's raffle display in the Dealers' Room. Drawings for each item will occur after the Dealers' Room closes on Saturday and results will be posted there through Sunday for claims and prize pickup.

Before the Charity Auction on Saturday, donations will also be on display at South Hills Pet Rescue's table in the Dealers' Room. The Charity Auction itself will occur on Sunday afternoon (please consult your program/schedule) and will run for approximately 1 hour. Donated items and services will be offered in the Charity Auction for bargain prices designed to stimulate your interest in contributing to a worthy cause as well as receiving a quality product that you won't be able to find anywhere else at Anthrocon.

If you would like to participate by donating an item to the Charity Auction or Raffle, see the Charity Director, Brian Harris, at the charity table in the Dealers' Room on Friday, July 6th. Please help us support South Hills Pet Rescue by participating in the 2018 Anthrocon Charity Auction & Raffle.



ART SHOW INFORMATION

ANTHROCON ART SHOW BIDDING RULES

The Anthrocon Art Show is an exhibit of original artworks of a science fiction, fantasy and/or “fannish” nature, especially relating to anthropomorphic animals. Here you will find for sale both flat (e.g. sketches and paintings) and 3-dimensional (e.g. sculpture and costumes) artwork created by professional and amateur artists.

To be a “bidder” (i.e. a prospective buyer of original artwork) you must:

1. Be a registered member of Anthrocon, as evidenced by your convention badge;
2. Obtain a bidder number at the Art Show table by filling out and signing a bidder information sheet, acknowledging that you agree to abide by these bidding rules.

If you wish to place “proxy” bids on behalf of someone not in attendance, please see the Art Show Director.

Significant changes from previous versions of these rules are indicated in **bold type**.

Areas of the Art Show

There are two distinct areas of the Art Show.

1. In the General Gallery, you will see original artwork depicting subjects suitable for all ages to view. This will be open for silent (written) bidding during the day and early evening Friday and Saturday, and Sunday morning. If a piece receives enough written bids by noon Sunday, it will be sent to the general voice auction Sunday afternoon.

2. The Mature Gallery is set aside for the display of original artwork depicting mature subject matter. This will be open during the same hours as the rest of the Art Show Friday and Saturday, and monitored to keep minors out. Pieces in this area which receive enough written bids by Saturday evening will be sent to a separate voice auction later that evening.

Bidding

Each piece of artwork is tagged with a Bid Sheet which provides information about that piece, including its title, the medium, the name of the artist, and the minimum bid at which the artist is willing to sell the piece. If an artist does not wish to sell a given piece, it is listed as “nfs” (Not For Sale).

On the Bid Sheet are several lines where you may write down your name, bidder number, and the amount you wish to bid for that item. The amount of the bid must be in whole dollars, at least as much as the minimum bid specified by the artist, and larger than any preceding bid on the bid sheet. Write *legibly* on the next numbered bid line. *Do not cross out any previously written bids, including your own.* If you make a mistake in bidding, please inform an Art Show crew member so we may fix the bid sheet so there are the correct number of empty bid lines.

You may not interfere with or intimidate someone who wants to outbid you. Allow them

to place their bid, and then outbid them on the next bid line. If someone tries to keep you from placing a bid, seek assistance from an Art Show crew member. Anyone caught interfering with bidding will be asked to leave the Art Show, and their bidding privileges revoked.

Artists (or their associates) may not place bids on their own artwork with the intent of bidding up the price unfairly, or to keep other bidders from purchasing a piece in order to retain it to sell elsewhere under more favorable circumstances. However, they are allowed to place “proxy” bids on behalf of a customer not in attendance.

Written bidding for General Gallery artwork closes at noon Sunday. The Art Show will be cleared of all bidders at that time, as detailed below. Pieces with enough written bids (as shown on the bid sheet) will be placed in the voice auction, which begins Sunday at 2 pm; all other art will be sold to the person with the highest written bid, if any. At the voice auction, the art is open to further bids by other people. Therefore, you should attend the voice auction to defend your bids on pieces you still want to buy. If there are no voice bids, the art will be sold to the person with the highest written bid. Although there are “runners” showing off the auction pieces, this is for *identification*, not admiration. Please take the time to examine the artwork closely while the show is open for written bidding!

For pieces in the Mature Gallery, the procedure is similar, although the times are different. Written bidding ends Saturday at 6 pm. Artwork with enough written bids will be placed in a separate voice auction for mature artwork which begins at 11 pm Saturday, and runs similarly to the General Gallery voice auction, as noted above.

All artwork sold by written bid or in either voice auction will available for pickup Sunday during sales hours, 2 to 5 pm. Artists have the option of setting a “Price After Closing.” If a piece has received no written bids by closing time, it may be available at the indicated price Sunday afternoon if the artist still wishes to sell it. If this is the case, the blank bid line #1 will be circled in red. Fill in your name, bidder number, and the “Price After Closing” when collecting your artwork.

Be careful. When placing a written bid on items, assume that you will be the winning bidder on *all* of them. In this way, you will avoid having to pay for more art than you can afford to buy. If you have reached your limit for Art Show purchases, wait until you have lost an item to a higher bidder before bidding on another item. (Keep in mind that we must collect 7% sales tax on purchases, so allow for this in your figuring.) We provide handy Bidding Record forms so you can keep track of what you’ve bid on and where it’s located to make it easy for you to find again.

Also, return to the Art Show before closing (6 pm Saturday for mature artwork; noon Sunday for everything else) to check the bid sheets to see what items, if any, you have won by written bid and which items will be going to the voice auction. After closing, because the crew is busy getting ready for the auction, we cannot accommodate anyone who wants to check their bids at that time.

Be serious. Do not make a bid unless you mean it. A bid is a binding obligation to buy that art at that price.

If you are the winning bidder, you purchase only the physical possession of the artwork; the artist retains the copyright. If you wish to make copies of a piece you purchase for any purpose, you must negotiate for the right to do so with the artist, whose name and contact information are on the back of each piece or can be obtained from the Art Show Director. (Please Note: Artists are provided with the names and addresses of those who have purchased their artwork.)

Defending Your Bids

When the written bidding closes, crew members will form a “moving wall” starting at the back of a section and moving forward, closing bidding by artist (not by piece, not by panel, not by bay). The closeout path is shown on the Art Show map handout and poster. Closeout is done per artist in a bay: if there are three artists in a bay, there will be three closeouts in the bay; if one artist takes up the entire bay, the entire bay closes at once; and if an artist occupies more than one bay, each of their bays closes separately.

We move quickly, so when the “wall” gets to an artist you want to bid on, do your bidding *before* the auctioneer declares the artist “closed.” We will not close an artist while bidding is going on, but if there is no bidding, it will close quickly, so don’t be timid—if you want to bid, *bid!* We can’t wait for someone to make up their mind at the last second. We want you to get your chance to bid, but do it *quickly!*

You will be allowed to defend your bids, but you may not block anyone else from bidding on any piece—the auctioneer and Art Show crew will see that it doesn’t happen. If you are not actively guarding your bids, we ask that you clear the aisles at least 10 minutes before the show closes. There are a lot of people in the area, and we need to move them out as quickly as possible when closeout begins. If you are just having a conversation with someone, please take it outside the Art Show.

All this allows you to defend bids in more than one section. The Art Show crew follows close behind the “wall,” marking final bids to ensure that if you’re the last bid, you *are* the last bid. Once the “wall” passes a point, no one except Art Show crew are allowed beyond it.

Sales

Art Show Sales will take place Sunday from 2 to 5 pm. (If you have an afternoon ride, flight, train or bus to catch, please ask *in advance* about early sales pickup.) At this time you

must personally pick up and pay for all items of art you have won by written bid or voice auction. You must show your con badge for identification, and additional identification may be requested.

If you have items in the Mature Gallery, these pieces must be paid for and wrapped before you can take them out of the Mature Gallery.

Collect your art from the panels and tables. *Do not remove the bid sheets from the artwork!* There will be work tables set up where you then fill out a sales slip, writing in the artist name, piece title, and high bid amount for each piece, as well as your real name and bidder number. (Use more than one slip if necessary.)

If you have purchased more pieces than you can carry, or need access to a locked display case, ask for help from an Art Show crew member.

Once you have filled out your sales slips, go to a cashier, who will double-check the slip against the bid sheets, add up all the prices and calculate sales tax and total, and take your payment. We accept cash, traveler’s checks, personal checks, credit cards (Visa, MasterCard, American Express, Discover), and debit cards (all major networks). ID may be requested at time of payment.

You must pick up and pay for your own purchases, and show the receipt to the entrance guard when you leave the Art Show (so keep it handy). All sales are final and all items are sold as-is; refunds will not be issued for items purchased in the Art Show for any reason.

Occasionally there are errors in tallying sales slips. We always pay the artist based on the final bid sheet price; if it turns out we under- or overcharged you, in the weeks following the con we will bill you or refund the difference.

Remember: You bid, you buy. Your bid is a binding obligation with Anthrocon and the artist for the purchase of the artwork.

If you do not pick up your artwork and/or do not pay for it in full, we will contact you in the weeks after the convention and bill you for the price of the art plus packing and shipping costs (typically \$10–\$20 for those in the USA). You will be denied attendance at future Anthrocon conventions until you honor your payment obligation. Once you’ve paid, we will ship you the artwork **if available.** (After two years, unclaimed artwork is donated to the Charity Raffle/Auction, or otherwise bestowed; but this does not discharge your obligation; we have already paid the artist, so you must reimburse us.) Until you pay, your real name and badge name may be posted publicly so that others may be wary of doing business with you.

If you do not pick up and pay for your artwork at the con **more than once** without good reason, you will not be allowed to participate in future Anthrocon Art Shows.

Checks which do not clear the bank will be assessed a service charge of at least \$30. Persons who present fraudulent checks, unauthorized credit cards or counterfeit money will be reported to the authorities.

STATION SQUARE

Driving from 10th St. & Penn Ave.: Follow 10th St. south to **William Penn Place**, turn left onto **Sixth Avenue**, then first right onto **Grant Street**, turn right onto **Fort Pitt Blvd.**, then first left onto **Smithfield Street**. Cross **Smithfield Street Bridge**. After you cross the bridge, Station Square will be on the right.

The "T" (Pittsburgh Light Rail): Steel Plaza or Wood Street to Station Square.

Walking: Follow 10th St. south, turn right onto **Liberty Avenue**, then left onto **Smithfield Street**. Station Square is approximately 1 mile/20 minutes away.

STRIP DISTRICT

The Strip District is a one-half square mile area northeast of downtown Pittsburgh. "The Strip," as it is familiarly known, is just that—a narrow strip of land in a flood plain confined by natural boundaries: the Allegheny River to the north and the extension of Grant's Hill to the south. The Strip District's east and west boundaries are 11th and 33rd streets; the produce district runs from 16th to 22nd streets.

The area has developed into a historic market district with many ethnic food purveyors, some art studios, antique dealers, unique boutiques, and other businesses setting up shop where trains once delivered produce by the ton. The Strip District comes alive primarily on weekends during the summer months when street vendors are selling their wares, the open-air farmer's markets are in full swing, and party-goers sit outside and enjoy a drink.

For more information:
www.stripdistrictneighbors.com

<p>Estimated time to walk from corner of 10th St. and Penn Ave.</p>	
<p>Within 10 minutes</p>	<p>More than 10 minutes</p>

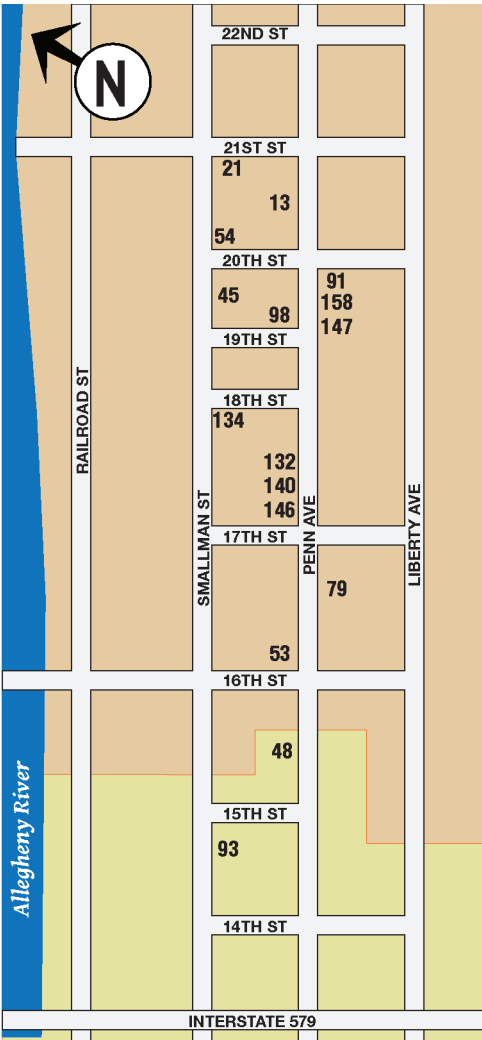

For continuation see Downtown map