

Station Square

Driving from 10th St. & Penn Ave.: Follow 10th St. south to **William Penn Place**, turn left onto **Sixth Avenue**, then first right onto **Grant Street**, turn right onto **Fort Pitt Blvd.**, then first left onto **Smithfield Street**. Cross **Smithfield Street Bridge**. After you cross the bridge, Station Square will be on the right.

The "T" (Pittsburgh Light Rail): Steel Plaza or Wood Street to Station Square.

Walking: Follow 10th St. south, turn right onto **Liberty Avenue**, then left onto **Smithfield Street**. Station Square is approximately 1 mile/20 minutes away.

Strip District



For continuation see Downtown map

The Strip District is a one-half square mile area northeast of downtown Pittsburgh. "The Strip," as it is familiarly known, is just that—a narrow strip of land in a flood plain confined by natural boundaries: the Allegheny River to the north and the extension of Grant's Hill to the south. The Strip District's east and west boundaries are 11th and 33rd streets; the produce district runs from 16th to 22nd streets.

The area has developed into a historic market district with many ethnic food purveyors, some art studios, antique dealers, unique boutiques, and other businesses setting up shop where trains once delivered produce by the ton. The Strip District comes alive primarily on weekends during the summer months when street vendors are selling their wares, the open-air farmer's markets are in full swing, and party-goers sit outside and enjoy a drink.

For more information:
www.stripdistrictneighbors.com

Estimated time to walk from corner of 10th St. and Penn Ave.

Within 10 minutes

More than 10 minutes

SURF PACIFIC



2019 Anthrocon

Convention Guide



Our Custom Pins:

Bring your fursona to life in the form of an enamel pin!

Starting at

\$185 /USD

for 50 pins

\$215 /USD

for 75 pins

\$265 /USD

for 100 pins

\$385 /USD

for 200 pins

add ons include glow in the dark, glitter, couple pins, etc.

[learn more at FursonaPins.com](http://FursonaPins.com)



PIN OF THE MONTH CLUB

Love pins?

Have them delivered to your home for one of the fandom's cheapest enamel pin prices.

\$15 for two (sometimes three) monthly pins

\$25 for five (sometimes six) monthly pins

Join the Club at Patreon.com/FursonaPins



www.FursonaPins.com

Anthrocon 2019 Convention & Dining Guide

Welcome to Anthrocon 2019! This Guide contains the following information which will be useful to you during the convention:

- ◆ Anthrocon 2019 Guests of Honor
- ◆ Anthrocon Standards of Conduct
- ◆ Dining Guide including Maps of Downtown & Strip District
- ◆ Dealers' Room Layout and Index
- ◆ David L. Lawrence Convention Center Floorplan
- ◆ Westin Convention Center Hotel Floorplan
- ◆ Art Show Hours & Bidding Rules
- ◆ Charity Auction & Raffle Information

The Friends of Anthrocon return!



Snap your photo with over a dozen Friends, including three new partners, and use the #Anthrocon hashtag!



"Friends of Anthrocon" artwork for our hotels and partners by Mary "Moth Monarch" Capaldi! Find them at table D16 or see more in the art show!

Cover artwork by Cuprohastes
Dining Guide information compiled by Greyse AKA Heidi
Edited by Kijani
Dining Guide maps by Xydexx Unicorn
Layout by Ysera She'nai
Composed by the Anthrocon Publications Department
Printed by Herrmann Printing, 1709 Douglass Drive, Pittsburgh, PA 15221

Guests of Honor

Steve Gallacci

Steve Gallacci always had a passion for art and illustration as a small child; however, it is in 1974 while serving in the U.S. Air Force as a Graphics Specialist that he developed his professional experience with illustration and found an interest in the science-fiction fandom. By 1978, Steve was creating fanzines and laying the foundation for Albedo Anthropomorphics which is cited as one of the greatest inspirations of what would become the foundation of furry fandom.

Steve Gallacci is also known for his illustrations with the retro sci-fi adventure comic Fusion, Elin Winkler's Tales of the Fehnnik, and short bits for Ken Fletcher's Spontoon fanzine. Steve also works with custom modeling, creating object in various mediums such as wood and metal.

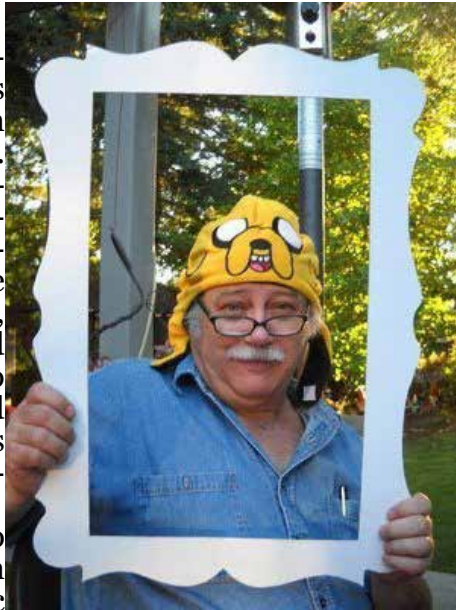

Ben Diskin

In his 30 years of voice acting experience, Ben Diskin has voiced a multitude of characters in anime, western animation, video games, and more.

In anime, he's known for the roles of Joseph Joestar in "JoJo's Bizarre Adventure: Battle Tendency," Sai in "Naruto Shippuden," Ban in "The Seven Deadly Sins," Death Gun in "Sword Art Online," Shoutmon and Cutemon in "Digimon Fusion," and many others.



In western animation, he starred as Numbuh 1 and Numbuh 2 in "Codename: Kids Next Door," Eddie Brock/Venom in "The Spectacular Spider-Man," Boris Badenov in "The Adventures of Rocky and Bullwinkle," and Baby Gonzo in the 2018 remake of "Muppet Babies."

He's been doing video game voice over since the early days

SonicFox

Four-time EVO champion and winner of the 2018 Best eSports Player award, Dominique "SonicFox" McLean is part of team Echo Fox, and is well known for competing while in fursuit and displaying a carefree attitude at tournaments. He is also known within the professional gaming world for his versatility to pick up a new game or character and master it for professional play quickly.

It was at the age of 3, through the influence of his older brother, that SonicFox first became interested in fighting games. Since the age of 13, he has found success in fighting games such as Injustice: Gods Among Us and Dragon Ball FighterZ. Most humbly in his Best eSports Player acceptance speech at the 2018 Games Awards, SonicFox said he "never did it for the fame," that he's "done all this just to make new friends and bonds in the community."



of the PlayStation 2. He was Eric Sparrow in "Tony Hawk's Underground," Young Master Xehanort in the "Kingdom Hearts" franchise, Daichi Shijima in "Devil Survivor 2: Record Breaker," Jakob, Saizo, Hayato, and Matthew in "Fire Emblem: Fates" and "Fire Emblem: Heroes," Rokuro in "Tales of Berseria," Sig and Lemres in "Puyo Puyo Tetris," and Mega Man in "Mega Man 11."

His most notable FURRY role is Haida in Sanrio's "Aggretsuko" and, real talk, he knows that's the only reason you'd want to meet him and he's totally cool with that. In fact, he's sitting in front of his computer right now, thinking, "Okay, I have no idea why I'm writing this bio. Let's face it, the only reason I got invited was because of Haida. I know it; they know it; why beat around the bush? I mean, ain't no one here to see the voice of Humphrey from the 'Alpha and Omega' sequels or Valefor from 'Magi: Adventure of Sinbad.' Although, I guess I should write those down somewhere just in case and waaaaaaait a minute...! I just did! Wow, good job, Me!"

He also writes terrible bios for convention appearances and clearly can't be trusted to tie his own shoes, let alone self-promote. ... Come say hi!!

Standards of Conduct

The following general rule supersedes all others listed below and may be invoked at any time:

Any action or behavior that causes significant interference with convention operations, excessive discomfort to other attendees, or adversely affects Anthrocon's relationship with its guests, its venues, or the public is strictly forbidden and may result in permanent suspension of membership.

INTRODUCTION

The primary purpose of Anthrocon is for our attendees to have fun. To ensure that the greatest number of people do so, we have established certain rules of conduct. These rules are to ensure that the behavior of any one small group does not disturb the membership as a whole, and does not detract from the relaxed and comfortable atmosphere of the convention. Anthrocon welcomes all parties with an interest in anthropomorphic animals; however, the convention's management reserves the right to deny or revoke the membership of any individual at any time for any reason. Anthrocon, Inc. also reserves the right to amend these rules at any time without prior or posted notice and reserves the sole right of interpretation. In any dispute, the general rule above will apply. If you have any questions, please contact the convention operations staff for assistance.

Anyone who accepts a membership agrees to indemnify and hold harmless Anthrocon, Inc. from any claim for personal injuries or other damages or equity arising out of any individual's activities at Anthrocon, even if such injury or damage is caused by negligence by or on the part of Anthrocon, Inc.

As a condition of membership, all Anthrocon attendees are required to abide by these standards of conduct for the entire duration of their stay, even prior to Opening Ceremonies or after Closing Ceremonies.

GENERAL RATING OF THE CONVENTION

All convention space is considered to be "PG" at all times, with the exception of events or exhibits that are specifically noted to be inappropriate for minors and access to which is controlled by Anthrocon staff.

When in public areas, attendees may not wear clothing or accessories which are overly revealing, inappropriate to the atmosphere of the convention, or likely to draw reasonable complaint or offense. This includes clothing or accessories that are fetish-related or restrict mobility, such as a leash attached to an otherwise acceptable collar. Some normally

inappropriate items may be included as part of a costume at the discretion of the Security Chief.

Shirts, pants/shorts/skirts, and footwear must be worn when in areas of hotels or the convention center that are accessible to non-Anthrocon attendees, such as lobbies, restaurants and concourses, except for hotel swimming pools. Full-body fursuits qualify as shirts, pants, and footwear provided that the costume is not unacceptably revealing. Fursuiters must respect the policies of hotels and other venues regarding areas where costumes are not allowed, which may include restaurants and hotel swimming pools.

Public displays of affection beyond what is appropriate for polite company are frowned upon. Please express your devotion to your significant other either in less conspicuous ways, or in private.

PUBLIC DECORUM

No items of any kind may be thrown, flown, or dropped from hotel or Convention Center balconies or patios.

No water pistols, silly string, or any thrown, flown, or projectile item may be used in any area of hotels or the Convention Center.

Lighter-than-air balloons may not be brought into the Convention Center.

For safety reasons, only handheld glowsticks are permitted in the dances. Glowsticks on strings or on polearms must be cleared with Security staff before being used. The decision of the Security staff on any particular item will be final.

Please do not sleep in convention space or hotel lobbies; return to your hotel room or home.

Anthrocon attendees must abide by instructions given by Anthrocon Security staff. Failure to do so will result in loss of membership privileges. Any disputes or concerns may be addressed onsite at Convention Operations.

Anthrocon functions are open only to members, and all attendees should wear their membership badges at all times. A badge is valid only for the person to whom it was issued; badges may not be shared under any circumstances.

Knowingly providing transportation or housing, or otherwise knowingly enabling an individual that is unwelcome at Anthrocon to attend or enter convention space will result in permanent revocation of Anthrocon membership privileges.

HARASSMENT

Harassment of any kind will not be tolerated at the convention. If you have been the target of harassment, we urge you to report the incident immediately to a member of Security or to Convention Operations. The sooner an issue is

reported to us, the more appropriately we can address it.

Harassment includes, but is not limited to:

(a) Physical assault, battery, stalking, or unwelcome physical attentions.

(b) Conduct, dress, or speech that targets, threatens, intimidates, or is otherwise intended to cause distress to other attendees or members of protected classes (such as those based on race, age, religion, national origin, disability, gender, or sexual identity).

If people tell you "no" or ask you to leave them alone, your business with them is done. If you continue to attempt to have contact with those people, you may be removed from the premises. Remember: "A costume does not imply consent."

ATTENDANCE BY MINORS

Anyone who is under the age of 18 years at any time during the convention must present a signed and notarized parental permission form unless accompanied by a parent or able to produce evidence of legal emancipation. There are no exceptions.

Minors are not permitted under any circumstances to enter areas designated for mature audiences.

Anyone providing false documentation of identity or age will be denied membership and reported to the police.

WEAPONS POLICY

No actual weapons or any item that can be easily mistaken for one may be carried either openly or concealed at any time in convention space, regardless of any government permits which you may possess. Exceptions may be made only for duly appointed law enforcement officers by prior arrangement with the Security Chief. Personal pocket knives with single-edged blades less than 4 inches long are permitted.

Realistic weapon replicas are permitted as part of a costume only during costume events such as the Fursuit Parade or Anthrocon Tonight, and must be appropriately peace-bonded; see the Security Chief for instruction on how to do so. They must be cased or otherwise secured when being carried outside of costume.

PET POLICY

Pets are not permitted in convention space. Service dogs (as defined by the Americans with Disabilities Act or ADA, Title II) are permitted in all convention space accessible to members provided that they are under appropriate control. Emotional Support Animals and Therapy Animals are NOT considered service dogs by the ADA, and are not permitted in convention space.

HOTEL PARTY POLICY

Gatherings in hotel rooms must not generate any noise that can be heard in neighboring rooms during nighttime hours. Hotel doors must be kept shut during such gatherings and

guests are not permitted to congregate in the hotel corridors.

Loud parties will be given a single warning to remain quiet. No second warnings will be given before action is taken by the hotel to remove the offending individuals.

Hotel guests who host any gathering are responsible for cleaning up afterward. Excessive amounts of unbagged trash must not be left for housekeeping staff to clean up (it's just plain rude). Trash bags are provided. Use them.

OTHER HOTEL MATTERS

Any act of vandalism, deliberate or excessive damage to hotel property, or interference with any hotel or Convention Center workers in the performance of their duties will result in permanent revocation of Anthrocon membership, criminal prosecution, fines, or any combination thereof.

Do not affix anything to the walls of any hotel or Convention Center, to the elevators, to Anthrocon signage, or to hotel room doors.

The person in whose name a room is rented is solely responsible for the conduct of all individuals in the room as well as for the condition of the room. Excessive trash, soiling or other damage to hotel property, or any circumstance that may present a hazard to hotel housekeeping staff may result in permanent loss of Anthrocon membership privileges.

Hotel Housekeeping staff are required by corporate policy to inspect every room once per day, even if the room is not to be serviced. In some of our partner hotels, Housekeepers will delay their rounds for our benefit, and will initially bypass rooms with "do not disturb" signs on the doors. At the end of their rounds they must return to those rooms and will knock on the door. Attendees must allow housekeeping staff access to the room to inspect it at that time, even if the "do not disturb" sign is displayed.

Requests for room amenities such as towels and pillows beyond the number that is reasonable and customary for a single room will not be honored. Kindly bring such extra items from home if you anticipate the need.

SALES OF GOODS AND SERVICES

The offering for sale of any goods or services at the convention may be undertaken only in appropriate and authorized areas of Halls "B" or "C" in the Convention Center; in all cases the sale will be governed by the rules applicable to those areas. Sales may only be made at authorized times, and by registered, authorized Dealerships or registered, authorized Artist's Alley participants. It is not permitted to sell any other goods or services in any other areas, including the Anthrocon "Zoo."

SMOKING, ALCOHOL, AND SUBSTANCE ABUSE

Smoking is not permitted in any area

Anthrocon 2019 Dining Guide

Welcome to Anthrocon 2019's dining guide, from which emerges opportunities to satisfy your bodacious appetites! Here's some fun tropical facts before you dine!

- * Most of the world's macadamia nuts are grown on the island of Hawaii.
- * One cup of unsweetened shredded coconut has about 25 grams fat and 280 calories.
- * Luau originally referred to only the leaves of the taro plant, which are eaten as a vegetable.
- * Although you can heat a can of ravioli in a lava flow, you will not be able to eat the contents afterwards.
- * While everyone is busy arguing about pineapples on pizza, the pineapples are busy consuming everyone that eats them.

This Guide is sorted by type of cuisine, and includes addresses and phone numbers (updated as of May 2019), as well as ratings gathered from *Yelp.com*.

Whether you're just looking for an inexpensive quick snack or want to have a fancy dinner, this Guide has more than 140 nearby dining options within a 15-minute walking radius to choose from. Listed after the dining options are services such as convenience stores, copy and shipping shops, nearby ATMs, etc. The figure below shows a sample entry:

Follow us on Twitter! @AnthroconDining

Est. Average Price: Price range is the approximate cost per person for a meal including one drink, tax, and tip.
 \$ = Cheap, Under \$10
 \$\$ = Moderate, \$11 - \$30
 \$\$\$ = Spendy, \$31 - \$60
 \$\$\$\$ = Splurge, Above \$61

Location Name: **Kiki's Coffee** Rating: ★★★★★ \$ Gay-friendly Delivery Vegetarian Gluten-free Map Grid # C-3 • 182 Location on map in center of this Guide. Location #

1313 Mockingbird Lane, 412-555-2019 - Also cute and FLUFFY!

Th: 9a-5p F: 9a-5p Sa: 9a-5p Su: closed

Street Address & Phone Number Additional Information

Within 5 minute walk from DLCC Within 10 minute walk from DLCC MORE THAN 10 minute walk from DLCC

walking distance from dlcc is indicated by color codes

More food options at these shopping districts:

- Market Square: www.marketsquarepgh.com
- The Strip: www.stripdistrictneighbors.com (see back cover)
- Station Square: www.stationsquare.com (see back cover)

within the Westin (including guest rooms) or the Convention Center. THIS INCLUDES ELECTRONIC CIGARETTES, at the request of the venue management. Smokers are asked to use designated smoking areas, and to comply with any other smoking rules of the facility. Cigarette butts must be disposed of properly.

Anthrocon asks that any bottled alcoholic beverages be brought promptly to hotel rooms for storage or responsible consumption. No alcoholic beverages may be brought into nor consumed in convention space, except during designated programming events.

Anyone knowingly or unknowingly providing alcohol to anyone under the age of 21 may be removed from the convention, be turned over to the authorities, and can be charged with a felony. It is the sole responsibility of persons serving alcohol in room parties to ensure that every person in attendance is over the age of 21, even if that person is not drinking alcohol. The Pennsylvania Liquor Control Board is extremely serious about this law and we ask our members to respect it.

The sale, distribution, or use of any illegal or controlled substances is not welcome at Anthrocon. Any individual found to be distributing such substances will be removed and reported directly to the authorities. For safety, any obviously intoxicated or impaired attendees will be asked to return to their room or seek medical attention until the effects have passed.

MEDIA RELATIONS AND USE OF ANTHROCON IMAGES OR FOOTAGE

All journalists, media photographers, and any other members of the press are required to display an official Anthrocon Press Badge or be accompanied by a senior Anthrocon staff member at all times while in convention space. Members of the press who have not been issued a Press Badge may not conduct interviews or take photographs, audio or video footage without an escort.

If members of the media are present, attendees must act responsibly. Media representatives who do not have Press Badges and are not escorted by an Anthrocon staff member should be reported to Anthrocon Security staff or to Convention Operations immediately. Do not speak to any unbadged and unescorted members of the press!

Anthrocon members should be aware that audio and/or video recordings are frequently made in convention space and that their likenesses may appear in those recordings. Individual members agree to assign without compensation the use of their likeness(es) at Anthrocon for the use of promotional material such as the highlights videos.

The name "Anthrocon" and the Anthrocon logo are registered service marks of Anthrocon, Inc., and must not be used in any fashion that disparages or dilutes that mark. Members

agree to remove from circulation or publication any image or recording that in the sole opinion of Anthrocon, Inc. misrepresents or defames its service mark.

PAYMENTS TO ANTHROCON AND OTHER MONEY MATTERS

Please note that Anthrocon is a 501(c)7 nonprofit organization. As such, donations to the organization are not deductible from individual U.S. Federal income taxes.

Checks that are presented against insufficient funds will be charged a fee of \$30 per check.

Anthrocon accepts most major credit and debit cards. Chargebacks (denying a charge) that are made for the sole purpose of avoiding payment, that are made without sufficient cause, or that are made without first attempting to resolve the dispute with Anthrocon may result in permanent revocation of membership privileges and possible legal action.

Members who have an outstanding balance due to Anthrocon must settle that balance before being permitted to attend the convention.

Anthrocon cannot involve itself in financial disputes between individual members, and cannot divulge information about an individual member to any party other than to banking officials or legal authorities.

MISCELLANEOUS NOTES

The standards of conduct for Anthrocon will be enforced by Anthrocon security Staff. Please remember that your membership badge is the property of Anthrocon, Inc. and must be presented and/or surrendered to any Staff member requesting it. If you have any problem with any action taken by a Staff member you may take the matter up with the Chief of Security or with Anthrocon's Chairman.

Please be reminded that these rules involve "worst-case" scenarios and are put into place to ensure the safety and comfort of our members. They are also not all-inclusive; in all cases, the singular rule that supersedes all others is, "Any action or behavior that causes significant interference with convention operations, excessive discomfort to other attendees, or adversely affects Anthrocon's relationship with its guests, its venue, or the public is strictly forbidden and may result in revocation of membership privileges."

We anticipate no difficulties, as our members as a whole are rational and responsible adults. Anthrocon is prepared to handle difficulties as efficiently as possible should they occur. We thank our members for their past cooperation and for their continued assistance in making this a safe and enjoyable experience for everyone. Please remember to be courteous of those around you, and have fun!

Samuel Conway
Chairman, Anthrocon Inc.

American

August Henry's City Saloon ★★★★★★ \$\$	B-2 • 1
946 Penn Ave, 412-765-3270 - casual attire, kitchen closes earlier than bar	
Th: 11a-2a	Su: closed
Fr: 11a-2a	
Sa: 11a-2a	
Bigelow Grille ★★★★★★ \$\$	B-3 • 2
1 Bigelow Sq, 412-281-5013	
Th: 6a-11p	Su: 7a-11p
Fr: 6a-11p	
Sa: 7a-11p	
Bill's Bar and Burger ★★★★★★ \$\$	C-2 • 3
1001 Liberty Ave, 412-567-2300	
Th: 11a-11p	Su: 11a-11p
Fr: 11a-12a	
Sa: 11a-12a	
Bluebird Kitchen ★★★★★★ 🚚 🟢 \$\$	A-2 • 4
221 Forbes Ave, 412-642-4414	
Th: 7a-3p	Su: closed
Fr: 7a-3p	
Sa: closed	
Braddock's Rebellion ★★★★★★ 🟢 \$\$	A-1 • 5
107 6th St, 412-992-2005	
Th: 7a-11p	Su: 7a-11p
Fr: 11a-2a	
Sa: 11a-2a	
BRGR ★★★★★★ \$\$	A-2 • 6
535 Liberty Ave, 412-281-4748	
Th: 11:30a-9p	Su: 11:30a-9p
Fr: 11:30a-10p	
Sa: 11:30a-10p	
Butcher and the Rye ★★★★★★ \$\$\$	A-2 • 7
212 6th St, 412-391-2752 - casual attire, kitchen closes earlier than bar	
Th: 5p-1a	Su: closed
Fr: 5p-2a	
Sa: 5p-2a	
Cherries Diner ★★★★★★ \$	A-2 • 8
212 Forbes Ave, 412-281-8182	
Th: 7a-3p	Su: closed
Fr: 7a-3p	
Sa: 8a-3p	
Courthouse Tavern ★★★★★★ \$\$	A-3 • 9
310 Forbes Ave, 412-338-8608	
Th: 10:30a-2a	Su: 12p-12a
Fr: 10:30a-2a	
Sa: 10:30a-2a	
Crafted North ★★★★★★ \$\$	C-3 • 10
112 Washington Place, 412-471-4000	
Th: 11a-1a	Su: 11a-1a
Fr: 11a-2a	
Sa: 11a-2a	
Craftwork Kitchen ★★★★★★ 🚚 \$	B-3 • 11
600 Grant St, 412-281-1460	
Th: 7a-2p	Su: closed
Fr: 7a-2p	
Sa: closed	
DeLuca's Restaurant ★★★★★★ \$	Strip • 12
2015 Penn Ave, 412-566-2195 - known for breakfasts, cash only	
Th: 6:30a-2:30p	Su: 7a-3p
Fr: 6:30a-2:30p	
Sa: 6a-3p	
Elevation ★★★★★★ \$\$	B-2 • 13
535 Smithfield St 25th Fl, 412-338-2200	
Th: 7:30a-10:30a, 11a-10p	Su: 7:30a-10:30a, 11a-10p
Sa: 7:30a-10:30a, 11a-10p	
Fr: 7:30a-10:30a, 11a-10p	

American

Eleven ★★★★★★ \$\$\$	C-1 • 14
1150 Smallman St, 412-201-5656 - upscale, business casual attire, reservations recommended	
Th: 11:30a-10p	Su: 5p-9p
Fr: 11:30a-11p	
Sa: 11:30a-2p, 5p-11p	
Meat & Potatoes ★★★★★★ 🟢 \$\$\$	A-2 • 15
649 Penn Ave, 412-325-7007	
Th: 5p-10p	Su: 10:30a-2p, 5p-10p
Fr: 5p-12a	
Sa: 10:30a-2p, 5p-12a	
P&G's Pamela's Diner ★★★★★★ \$	Strip • 16
60 21st St, 412-281-6366 - good for breakfast, cash only	
Th: 7a-3p	Su: 8a-3p
Fr: 7a-3p	
Sa: 7a-3p	
Palm Court ★★★★★★	B-3 • 17
530 William Penn Pl, 412-281-7100 - serves traditional afternoon tea 2:30p-4p	
Th: 11:30a-11:30p	Su: 11:30a-11:30p
Fr: 11:30a-11:30p	
Sa: 11:30a-11:30p	
Penn City Grille ★★★★★★ \$\$\$	C-2 • 18
Westin Convention Center Hotel, 412-281-3700	
Th: 6:30a-11a	Su: 6:30a-2p
Fr: 6:30a-11a	
Sa: 6:30a-2p	
Redbeard's on Sixth ★★★★★★ \$\$	A-2 • 19
144 6th St, 412-261-2324 - Kitchen closes at 1a	
Th: 11a-2a	Su: 11a-2a
Fr: 11a-2a	
Sa: 11a-2a	
Revel ★★★★★★ \$\$	A-2 • 20
242 Forbes Ave, street level, 412-281-1134	
Th: 11a-11p	Su: 10a-10p
Fr: 11a-12a	
Sa: 11a-12a	
Roost ★★★★★★	A-2 • 21
242 Forbes Ave, second floor, 412-281-1616	
Th: 6a-10a, 5p-10p	Su: 7a-11a
Fr: 6a-10a, 5p-10p	
Sa: 7a-11a, 5p-10p	
Smallman Galley ★★★★★★ 🟢 \$\$	A-2 • 22
54 21st St, 412-517-6100 - four restaurants, one building	
Th: 11a-12a	Su: 10a-3p
Fr: 11a-12a	
Sa: 11a-12a	
Ten Penny ★★★★★★ \$\$	B-2 • 23
960 Penn Ave, 412-318-8000	
Th: 11a-12a	Su: 10a-9p
Fr: 11a-12a	
Sa: 10a-12a	
Terrace Room ★★★★★★ \$\$\$	B-3 • 24
Omni William Penn Hotel, 412-553-5235 - dressy	
Th: 6:30a-2p, 5p-9p	Su: 6:30a-2p
Sa: 6:30a-2p, 5p-10p	
Fr: 6:30a-2p, 5p-10p	
The Carlton ★★★★★★ \$\$\$	B-3 • 25
500 Grant St, 412-391-4099 - dressy (Website notes that their dress code is "Whatever you are comfortable with is fine with us.")	
Th: 11a-2:30p, 5p-10p	Su: closed
Fr: 11a-2:30p, 5p-10p	
Sa: 5p-10p	
The Commoner ★★★★★★ \$\$	B-2 • 26
620 William Penn Pl, 412-230-4800	
Th: 6:30a-11p	Su: 7:30a-10p
Fr: 6:30a-2a	
Sa: 7:30a-2a	

American

The Garden Café ★★★★★ \$	A-2 • 27
600 Penn Ave, 412-392-4879	
Th: 11:30a-2:30p	Fr: 11:30a-2:30p
Sa: closed	Su: closed
The Mozart Room ★★★★★ \$\$\$	A-2 • 28
600 Penn Ave, 412-392-4882 - formal attire, RESERVATIONS ONLY	
Th: 5:30p-8p	Fr: 5:30p-8p
Sa: 5:30p-8p	Su: 5:30p-8p
The Yard ★★★★★ 🚚 \$	A-2 • 29
100 Fifth Ave, 412-291-8182 - Kitchen closes before bar	
Th: 11a-11p	Fr: 11a-1a
Sa: 10a-1a	Su: 10a-10p
Union Standard ★★★★★ \$\$\$	B-3 • 30
524 William Penn Pl, 412-281-0738	
Th: 11a-10p	Fr: 11a-11p
Sa: 10a-11p	Su: 10a-9p
Winghart's Burger & Whiskey Bar ★★★★★ \$	A-2 • 31
5 Market Sq, 412-434-5600	
Th: 11a-12a	Fr: 11a-2a
Sa: 11a-2a	Su: 12p-12a

Asian

Bae Bae's Kitchen ★★★★★ 🍱 \$	B-2 • 32
951 Liberty Ave, 412-391-1890	
Th: 11:30a-8p	Fr: 11:30a-8p
Sa: 12p-8p	Su: 12p-3p
Fu Lai Chinese Restaurant ★★★★★ 🚚 \$	A-2 • 33
525 Penn Ave, 412-471-6338	
Th: 1:30p-9:30p	Fr: 1:30p-9:30p
Sa: 12p-9:30p	Su: 12p-9p
Noodles & Company ★★★★★ \$	A-2 • 34
476 McMaster Way, 412-562-2191	
Th: 11a-9p	Fr: 11a-9p
Sa: 11a-9p	Su: 11a-9p
Social House Seven ★★★★★ 🚚 \$	A-1 • 35
123 7th St, 412-709-6808	
Th: 11a-11p	Fr: 11a-2a
Sa: 11a-2a	Su: 11a-10p
Sushi Kim ★★★★★ \$	C-1 • 36
1241 Penn Ave, 412-281-9956 - Fri-Sat 5-10p: BBQ buffet ~ Mon: sushi only	
Th: 11:30a-9:30p	Fr: 11:30a-10:00p
Sa: 11:30a-10:00p	Su: 12p-9p

Bars

941 Saloon ★★★★★ 🇺🇸 \$	B-2 • 37
941 Liberty Ave, 412-281-5222	
Th: 2p-2a	Fr: 2p-2a
Sa: 2p-2a	Su: 2p-2a
Mahoney's Restaurant & Lounge ★★★★★ \$	B-2 • 38
949 Liberty Ave, 412-471-4243 - Ambience described as "Divey"	
Th: 11a-1a	Fr: 11a-1a
Sa: 12p-1a	Su: closed
Olive or Twist ★★★★★ 🍱 \$	A-1 • 39
140 6th St, 412-255-0525 - Kitchen open until 11p on Thurs, 12a Fri & Sat	
Th: 3:30p-12a	Fr: 3:30p-2a
Sa: 3p-2a	Su: closed

Bars

Seven ★★★★★ \$	A-1 • 40
130 7th St, 412-567-9912	
Th: 4p-2a	Fr: 4p-2a
Sa: 4p-2a	Su: 4p-2a
Sharp Edge Bistro on Penn ★★★★★ 🍱 \$	B-2 • 41
922 Penn Ave, 412-338-2437 - kitchen closes at midnight on Fri & Sat	
Th: 11a-12a	Fr: 11a-1a
Sa: 9a-1a	Su: 9a-12a
Speakeasy ★★★★★ \$	B-3 • 42
530 William Penn Pl, 412-281-7100	
Th: 5p-11p	Fr: 5p-12:30a
Sa: 5p-12:30a	Su: closed
The Warren Bar & Burrow ★★★★★ \$	A-2 • 43
245 7th St, 412-201-1110	
Th: 11a-2a	Fr: 11a-2a
Sa: 5p-2a	Su: 5p-2a
Wolfie's Pub ★★★★★ \$	A-2 • 44
274 Forbes Ave, 412-232-3000	
Th: 11a-11p	Fr: 11a-12a
Sa: 11a-12a	Su: 12p-9p

Bars with Nightlife

Andys Wine Bar ★★★★★ \$	A-2 • 45
510 Market St, 412-773-8884	
Th: 4pm-12a	Fr: 4p-1a
Sa: 3pm-1a	Su: closed
Cavo Nightclub ★★★★★ \$	Strip • 46
1916 Smallman St, 412-606-7143	
Th: closed	Fr: 9p-2a
Sa: 9p-2a	Su: closed
Howl at the Moon ★★★★★ \$	A-1 • 47
125 7th St, 412-586-5692	
Th: 5p-2a	Fr: 5p-2a
Sa: 5p-2a	Su: closed
Images Bar ★★★★★ 🇺🇸 \$	B-2 • 48
965 Liberty Ave, 412-391-9990 - Permits smoking	
Th: 2p-2a	Fr: 2p-2a
Sa: 2p-2a	Su: 2p-2a
Real Luck Café ★★★★★ 🇺🇸 \$	Strip • 49
1519 Penn Ave, 412-471-7832 - Permits smoking	
Th: 4p-2a	Fr: 4p-2a
Sa: 4p-2a	Su: 4p-2a
Tap Room ★★★★★ \$	B-3 • 50
Omni William Penn Hotel, 412-281-7100 - casual attire, dining available until 11p	
Th: 11:30a-12a	Fr: 11:30a-2a
Sa: 11:30a-2a	Su: 11:30a-12a
There Ultra Lounge ★★★★★ 🇺🇸 \$	B-2 • 51
931 Liberty Ave, 412-642-4435	
Th: 3:30pm-2am	Fr: 3:30pm-2am
Sa: 7:30pm-2am	Su: 7:30pm-2am

YOUR feedback helps improve our Dining Guide.

Comments are always welcome! Let us know what you liked or didn't like!
E-mail book@arthrocon.org or visit www.arthrocon.org/survey

Follow us on Twitter!



@AnthroconDining

Breakfast/Brunch

Waffles INCaffeinated ★★★★★ \$ \$ **B-3 • 52**
 456 Fifth Ave, 412-290-7801
 Th: 7a-2p Fr: 7a-2p Sa: 8a-2p Su: 8a-2p

Cajun & Creole

NOLA ★★★★★ \$ \$ **A-2 • 53**
 24 Market Sq, 412-471-9100
 Th: 11:30a-10p Fr: 11:30a-11p Sa: 12p-11p Su: 12p-9p

Caribbean & South American

Gaucha Parrilla Argentina ★★★★★ \$ \$ **Strip • 54**
 1601 Penn Ave, 412-709-6622
 Th: 11a-9p Fr: 11a-10p Sa: 11a-10p Su: closed

Kaya ★★★★★ \$ \$ **Strip • 55**
 2000 Smallman St, Suite 9, 412-261-6565
 Th: 11:30a-11p Fr: 11:30a-11p Sa: 11:30a-11p Su: 11a-9p

Coffee

Crazy Mocha **B-2 • 56**
 425 Sixth Ave
 Th: 6:30a-4p Fr: 6:30a-4p Sa: closed Su: closed

Crazy Mocha ★★★★★ \$ \$ **B-3 • 57**
 500 Grant St, I Mellon Ctr, 412-281-1981
 Th: 6a-5p Fr: 6a-5p Sa: closed Su: closed

Crazy Mocha ★★★★★ \$ **B-2 • 58**
 801 Liberty Ave, 412-281-3940
 Th: 6a-6p Fr: 6a-6p Sa: 8a-6p Su: 8a-6p

Dunkin' Donuts ★★★★★ \$ **B-3 • 59**
 601 Grant St, 412-281-4070
 Th: 6a-8p Fr: 6a-8p Sa: 7a-3p Su: 8a-3p

Dunkin' Donuts ★★★★★ \$ **A-2 • 60**
 28 Market Sq, 412-281-3195
 Th: 6a-7:30p Fr: 6a-7:30p Sa: 8a-4:30p Su: 8a-1p

Nicholas Coffee Company ★★★★★ \$ **A-2 • 61**
 23 Market Sq, 412-261-4225
 Th: 7a-5:30p Fr: 7a-5:30p Sa: 9a-4p Su: closed

Redhawk ★★★★★ \$ **B-2 • 62**
 536 Smithfield St
 Th: 7a-4p Fr: 7a-4p Sa: closed Su: closed

Starbucks Coffee Company ★★★★★ \$ \$ **B-3 • 63**
 600 Grant St, 412-765-3125
 Th: 6a-5:30p Fr: 6a-5:30p Sa: closed Su: closed

Coffee

Starbucks Coffee Company ★★★★★ \$ \$ **A-2 • 64**
 210 6th Ave, 412-642-9066
 Th: 5:30a-5:30p Fr: 5:30a-5:30p Sa: closed Su: closed

Starbucks Coffee Company ★★★★★ \$ **B-3 • 65**
 530 William Penn Pl, 412-201-2004
 Th: 5a-8p Fr: 5a-8p Sa: 6:30a-6:30p Su: 6:30a-3p

Starbucks Coffee Company ★★★★★ \$ \$ **A-2 • 66**
 202 6th St, 412-281-2380
 Th: 5:30a-8p Fr: 5:30a-10p Sa: 6:30a-10p Su: 7:30a-8p

Coffee Shop, Wine Bar, & Cat Cafe!

Colony Cafe ★★★★★ \$ \$ **C-1 • 67**
 1125 Penn Ave, 412-586-4850 - Cat loft is open 11a-8p with a catnap closure from 2p-3p. Reservations recommended! Sunday hours vary.
 Th: 10:30a-9p Fr: 10:30a-9p Sa: 9a-9p Su: closed

Deli

Au Bon Pain ★★★★★ \$ **B-2 • 68**
 535 Smithfield St, 412-263-2772
 Th: 6a-4p Fr: 6a-4p Sa: closed Su: closed

Au Bon Pain ★★★★★ \$ **B-3 • 69**
 600 Grant St, 412-456-2906
 Th: 6a-4p Fr: 6a-4p Sa: closed Su: closed

Au Bon Pain ★★★★★ \$ \$ **B-2 • 70**
 707 Grant St, 412-456-4309
 Th: 6a-4p Fr: 6a-4p Sa: closed Su: closed

Bruegger's Bagels ★★★★★ \$ **B-3 • 71**
 531 Grant St, 412-471-9249
 Th: 5:30a-7p Fr: 5:30a-7p Sa: 6a-7p Su: 6a-7p

Eadie's Kitchen and Market ★★★★★ \$ \$ **B-3 • 72**
 500 Grant St - I Mellon Ctr, 412-391-3993
 Th: 6:30a-3p Fr: 6:30a-3p Sa: closed Su: closed

Einstein Bros Bagels ★★★★★ \$ **B-2 • 73**
 436 Seventh Ave, 412-904-1491
 Th: 5:30a-4p Fr: 5:30a-4p Sa: closed Su: closed

Erin's Fine Foods ★★★★★ \$ **A-2 • 74**
 210 6th Ave, 412-315-7052
 Th: 6a-4p Fr: 6a-4p Sa: closed Su: closed

MixStir's Café ★★★★★ \$ \$ **C-1 • 75**
 1212 Smallman St, 412-454-6310
 Th: 10a-5p Fr: 10a-5p Sa: 10a-5p Su: 10a-5p

Fast Food

Arby's ★★★★★ \$	B-2 • 76
808 Liberty Ave, 412-281-1425 Th: 6a-9p Fr: 6a-9p Sa: 10a-8p Su: 10a-8p	
Burger King ★★★★★ \$	B-2 • 77
647 Smithfield St, 412-291-9176 Th: 5a-12a Fr: 5a-12a Sa: 6a-12a Su: 7a-12a	
Five Guys Burgers and Fries ★★★★★ \$\$	A-2 • 78
3 PPG Pl, 412-227-0206 Th: 11a-10p Fr: 11a-10p Sa: 11a-10p Su: 11a-10p	
McDonald's ★★★★★ \$	A-3 • 79
505 Smithfield St, 412-281-1777 Th: 5a-8p Fr: 5a-8p Sa: 5:30a-8p Su: 6a-9p	
McDonald's ★★★★★ \$	B-2 • 80
608 Wood St, 412-261-2281 Th: 4:45a-11p Fr: 4:45a-11p Sa: 4:45a-11p Su: 4:45a-11p	
McDonald's ★★★★★ \$	Strip • 81
1630 Penn Ave, 412-471-1747 Th: 6a-11p Fr: 6a-11p Sa: 6a-11p Su: 7a-10p	
Wiener World ★★★★★ \$	B-2 • 82
626 Smithfield St, 412-471-3013 Th: 9a-4p Fr: 9a-4p Sa: closed Su: closed	

Fusion

Tako Pittsburgh ★★★★★ \$\$	A-2 • 83
214 6th St, 412-471-8256 Th: 5p-10p Fr: 5p-11p Sa: 5p-11p Su: 3p-9p	

Greek

Apollo Café ★★★★★ \$	B-3 • 84
429 Forbes Ave, 412-471-3033 Th: 7a-3p Fr: 7a-3p Sa: closed Su: closed	
Mike & Tony's Gyro and Shish-Kabob ★★★★★ \$	B-2 • 85
927 Liberty Ave, 412-391-4077 - cash only Th: 10a-4:30p Fr: 10a-4:30p Sa: closed Su: closed	
Salonika Gyros ★★★★★ ✓ \$	A-1 • 86
133 6th St, 412-261-4770 Th: 10:30a-12a Fr: 10:30a-12a Sa: 11a-12a Su: 11a-7p	
Zorba's Gyros ★★★★★ \$	A-3 • 87
400 Smithfield St, 412-471-9930 Th: 10:30a-4:30p Fr: 10:30a-3p Sa: closed Su: closed	

YOUR feedback helps improve our Dining Guide.

Comments are always welcome! Let us know what you liked or didn't like!
E-mail book@anthrocon.org or visit www.anthrocon.org/survey

Follow us on Twitter!

 @AnthroconDining

Grocery

Market Street Grocery ★★★★★ 🚚 \$	A-2 • 88
435 Market St, 412-281-3818 Th: 7a-11p Fr: 7a-11p Sa: 9a-11p Su: 9a-9p	
Two Louie's Market ★★★★★ \$	C-1 • 89
1233 Penn Ave, 412-586-5593 - Grocery Th: 7a-6p Fr: 7a-6p Sa: closed Su: closed	

Indian

India Palace ★★★★★ 🚚 \$	A-1 • 90
137 6th St, 412-471-0660 Th: 11a-3p, 5p-10p Fr: 11a-3p, 5p-10p Sa: 11a-3p, 5p-10p Su: closed	
Indian Spices ★★★★★ \$	A-1 • 91
129 6th St, 412-281-1364 Th: 11a-2:30p, 5p-10p Fr: 11a-2:30p, 5p-10p Sa: 12p-10p Su: 5p-9p	
Sree's Authentic Indian Cuisine ★★★★★ ✓ \$	B-2 • 92
701 Smithfield St, 412-860-9181 - cash only Th: 11:30a-3p Fr: 11:30a-3p Sa: closed Su: closed	

Italian

Bella Notte Pizza Pasta & More ★★★★★ 🚚 \$\$	Strip • 93
1914 Penn Ave, 412-281-4488 Th: 11a-7p Fr: 11a-9p Sa: 9a-9p Su: 10a-5p	
Buca di Beppo ★★★★★ \$	Off Map • 94
3 Station Sq, 412-471-9463 - See directions to Station Square on back cover Th: 11a-10p Fr: 11a-11p Sa: 11a-11p Su: 11a-9p	
Lidia's Pittsburgh ★★★★★ ✓ \$	Strip • 95
1400 Smallman St, 412-552-0150 Th: 11:30a-2p, 5p-9p Fr: 11:30a-2p, 5p-10p Sa: 11a-2:30p, 4:30p-10p Su: 11a-2:30p, 4:30p-9p	
Peter Allen's ★★★★★ \$	A-2 • 96
613 Penn Ave, 412-642-6677 Th: 11a-11p Fr: 11a-12a Sa: 11a-12a Su: 12p-7p	
Pizzaiolo Primo ★★★★★ \$	A-2 • 97
8 Market Sq, 412-575-585 Th: 11a-10p Fr: 11a-10p Sa: 11a-11p Su: 3p-10p	
Proper Brick Oven & Tap Room ★★★★★ \$	A-1 • 98
139 7th St, 412-281-5700 Th: 11:30a-11p Fr: 11:30a-12a Sa: 11:30a-12a Su: 11a-10p	
Sienna Mercato ★★★★★ \$	B-2 • 99
942 Penn Ave, 412-281-2810 - Three restaurants, one building Th: 11a-12a Fr: 11a-12a Sa: 11a-12a Su: 11a-10p	
Sunseri Jimmy & Nino ★★★★★ \$	Strip • 100
1901 Penn Ave, 412-255-1100 Th: 7:30a-3:45p Fr: 7:30a-3:45p Sa: 7:30a-3:45p Su: closed	

Italian

Talia ★★★★★ \$\$\$ **B-3 • 101**
425 Sixth Ave, 412-456-8214
Th: 11a-10p Fr: 11a-10p Sa: 5p-11p Su: closed

Vallozzi's Pittsburgh ★★★★★ \$\$\$ **A-2 • 102**
220 Fifth Ave, 412-394-3400
Th: 11:30a-10p Fr: 11:30a-11p Sa: 11:30a-11p Su: closed

Villa Reale Restaurant ★★★★★ 🚚 \$\$\$ **B-2 • 103**
628 Smithfield St, 412-391-3963
Th: 11a-10p Fr: 11a-10p Sa: 11a-6p Su: closed

Mediterranean

Alihan's Mediterranean Cuisine ★★★★★ 🚚 \$\$\$ **A-1 • 104**
124 6th St, 412-888-0630
Th: 11a-10p Fr: 11a-11p Sa: 11a-11p Su: 11a-10p

Christos Mediterranean Grille ★★★★★ 🍷 \$\$\$ **A-1 • 105**
130 6th St, 412-261-6442
Th: 11a-10:30p Fr: 11a-10:30p Sa: 11a-10:30p Su: 11a-10:30p

Crystal ★★★★★ 🚚 \$\$\$ **C-1 • 106**
1211 Penn Ave, 412-434-0480
Th: 11a-11p Fr: 11a-11p Sa: 12p-10p Su: closed

Madonna's Mediterranean Cuisine ★★★★★ 🍷 \$ **A-3 • 107**
408 Smithfield St, 412-281-4693
Th: 10:30a-4p Fr: 10:30a-4p Sa: closed Su: closed

Mexican

Bakersfield ★★★★★ 🍷 \$\$\$ **B-2 • 108**
940 Penn Ave, 412-586-5024
Th: 11a-2a Fr: 11a-2a Sa: 11a-2a Su: 11a-2a

Bea Taco Town ★★★★★ 🚚 🍷 \$ **B-2 • 109**
633 Smithfield St, 412-471-8361
Th: 11a-6p Fr: 11a-6p Sa: 11a-4p Su: closed

Chipotle ★★★★★ 🍷 \$ **A-2 • 110**
211 Forbes Ave, 412-224-5586
Th: 10:45a-10p Fr: 10:45a-10p Sa: 10:45a-10p Su: 10:45a-10p

Condado Tacos ★★★★★ \$\$\$ **B-2 • 111**
971 Liberty Ave, 412-281-9111 - Happy Hour 5p-7p
Th: 11a-2a Fr: 11a-2a Sa: 11a-2a Su: 11a-2a

Las Velas ★★★★★ \$\$\$ **A-2 • 112**
21 Market Sq, 412-251-0031 - Happy Hour M-F 4p-6p, Bar open late Mon-Sat
Th: 11a-10p Fr: 11a-11p Sa: 11a-11p Su: 12p-9p

Moe's Southwest Grill ★★★★★ 🍷 \$ **A-2 • 113**
210 Forbes Ave, 412-224-4422
Th: 11a-9p Fr: 11a-9p Sa: 11a-9p Su: 11a-9p

Mexican

Qdoba Mexican ★★★★★ \$ **B-2 • 114**
808 Liberty Ave, 412-281-2415
Th: 10:30a-7p Fr: 10:30a-7p Sa: closed Su: closed

Qdoba Mexican ★★★★★ \$ **B-3 • 115**
601 Grant St, 412-281-3143
Th: 11a-6p Fr: 11a-6p Sa: closed Su: closed

Middle Eastern

Istanbul Grille ★★★★★ 🍷 \$ **B-2 • 116**
339 6th Ave, 412-316-0092
Th: 11a-2p Fr: 11a-2p Sa: 11a-2p Su: 11a-2p

Pizza

Café Milano ★★★★★ 🚚 \$\$\$ **A-1 • 117**
134 6th St, 412-281-3131
Th: 10a-2a Fr: 10a-3a Sa: 10a-3a Su: 10a-2a

Domino's Pizza ★★★★★ 🚚 \$ **A-2 • 118**
300 6th Ave, 412-288-8989
Th: 10a-2a Fr: 10a-4a Sa: 10a-4a Su: 10a-2a

Giovanni's Pizza and Pasta ★★★★★ 🚚 \$\$\$ **A-1 • 119**
123 6th St, 412-281-7060
Th: 9a-1a Fr: 9a-2a Sa: 10a-2a Su: 10a-1a

Joe & Pie ★★★★★ 🚚 \$ **B-2 • 120**
955 Liberty Ave, 412-402-0444
Th: 7a-11p Fr: 7a-1p, 2:30p-12a Sa: 7a-12a Su: 8a-11p

La Gondola Pizzeria Restaurant ★★★★★ 🚚 \$ **A-2 • 121**
4 Market Sq, 412-261-5252
Th: 10:30a-8p Fr: 10:30a-8p Sa: closed Su: closed

Mamma Lucia's ★★★★★ 🚚 \$ **A-2 • 122**
433 Wood St, 412-281-0416
Th: 9a-6p Fr: 9a-6p Sa: 11a-5p Su: closed

Pizza Parma ★★★★★ 🚚 \$ **B-2 • 123**
963 Liberty Ave, 412-577-7300
Th: 10a-1a Fr: 10a-2a Sa: 10a-2a Su: 10a-1a

V3 Flatbread Pizza ★★★★★ 🍷 🍷 \$ **A-1 • 124**
11 Fifth Ave, 412-456-0500
Th: 11a-8p Fr: 11a-8p Sa: 11a-8p Su: 11a-8p

Polish

Stuff'd ★★★★★ 🍷 \$\$\$ **A-1 • 125**
130 7th St, 412-586-5077
Th: 11a-11p Fr: 11a-2a Sa: 11a-2a Su: 11a-11p

NOTE: Dining Guide listings continue after maps on the following pages.

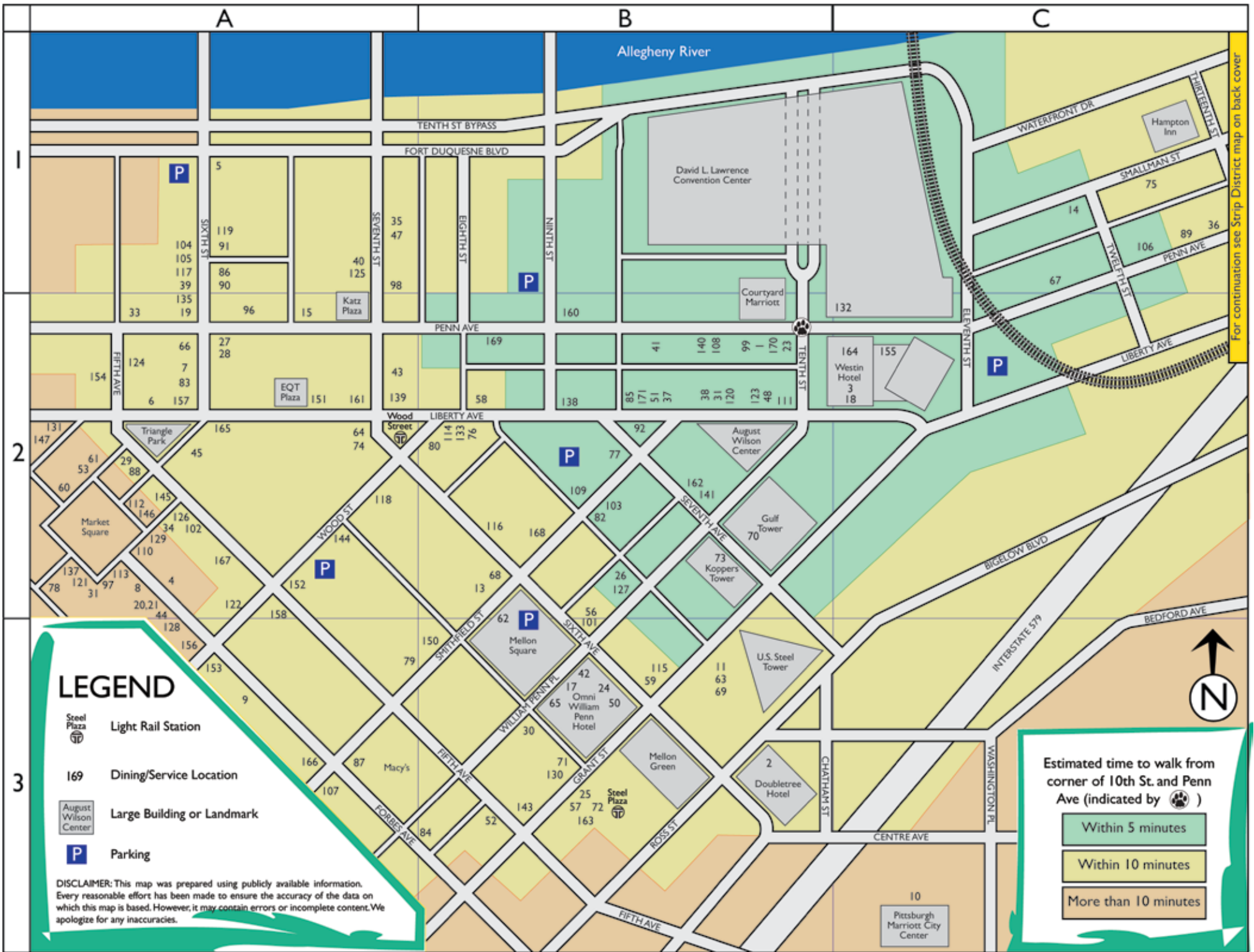

For continuation see Strip District map on back cover

LEGEND

-  Light Rail Station
-  Dining/Service Location
-  Large Building or Landmark
-  Parking

DISCLAIMER: This map was prepared using publicly available information. Every reasonable effort has been made to ensure the accuracy of the data on which this map is based. However, it may contain errors or incomplete content. We apologize for any inaccuracies.

Estimated time to walk from corner of 10th St. and Penn Ave (indicated by 🐾)

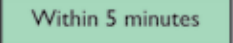
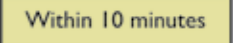
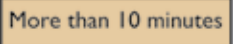
-  Within 5 minutes
-  Within 10 minutes
-  More than 10 minutes

Salads

Earth Inspired Salads ★★★★★ V \$\$ **A-2 • 126**
 218 Fifth Ave, 412-281-1113
 Th: 7a-5p Fr: 7a-5p Sa: closed Su: closed

Earth Inspired Salads ★★★★★ V \$\$ **B-2 • 127**
 611 William Penn Pl, 412-471-1927
 Th: 7a-6p Fr: 7a-6p Sa: closed Su: closed

Hello Bistro ★★★★★ V \$ **A-3 • 128**
 292 Forbes Ave, 412-434-0100
 Th: 10:30a-8p Fr: 10:30a-8p Sa: 11a-6p Su: 11a-6p

Sandwiches

DiBella's Old Fashioned Subs ★★★★★ 🚚 \$ **A-2 • 129**
 16 Market Sq, 412-338-8634 - limited selection for vegetarians
 Th: 10a-9p Fr: 10a-9p Sa: 10a-9p Su: 10a-7p

Jimmy John's ★★★★★ 🚚 \$ **B-3 • 130**
 501 Grant St, 412-281-3474
 Th: 11a-9p Fr: 11a-9p Sa: 11a-9p Su: 11a-9p

Jimmy John's ★★★★★ 🚚 \$ **A-2 • 131**
 506 Liberty Ave, 412-697-0999
 Th: 10:30a-7:30p Fr: 10:30a-7:30p Sa: 10:30a-6p Su: closed

Jimmy John's ★★★★★ 🚚 \$ **C-2 • 132**
 1027 Penn Ave, 412-224-6440
 Th: 11a-9p Fr: 11a-9p Sa: 11a-9p Su: 11a-9p

Penn Station East Coast Subs ★★★★★ \$ **B-2 • 133**
 808 Liberty Ave, 412-803-7366
 Th: 10a-8p Fr: 10a-8p Sa: 10a-8p Su: closed

Peppi's ★★★★★ 🚚 \$ **Strip • 134**
 1721 Penn Ave, 412-562-0125
 Th: 10a-5p Fr: 10a-5p Sa: 10a-8p Su: 11a-3:30p

Pork & Beans ★★★★★ 🚚 \$\$ **A-1 • 135**
 136 6th St, 412-338-1876
 Th: 11:30a-2p, 4p-10p Fr: 11:30a-2p, 4p-10p Sa: 11:30a-11p Su: 3p-9p

Primanti Brothers ★★★★★ \$ **Strip • 136**
 46 18th St, 412-263-2142 - Accepts credit cards
 Th: 24 hours Fr: 24 hours Sa: 24 hours Su: 24 hours

Primanti Brothers ★★★★★ \$ **A-2 • 137**
 2 Market Sq, 412-261-1599 - Accepts credit cards
 Th: 10a-12a Fr: 10a-2a Sa: 10a-2a Su: 10a-12a

Sammy's Famous Corned Beef ★★★★★ \$ **B-2 • 138**
 217 9th St, 412-765-2244
 Th: 9a-11p Fr: 9a-11p Sa: 9a-11p Su: closed

Sandwiches

Subway ★★★★★ \$ **A-2 • 139**
 703 Liberty Ave, 412-434-7827
 Th: 6:30a-10:30p Fr: 6:30a-10:30p Sa: 8a-9p Su: 9a-9p

Subway ★★★★★ \$ **B-2 • 140**
 930 Penn Ave, #2, 412-281-7335
 Th: 7a-9p Fr: 7a-9p Sa: 9a-8p Su: 9a-6p

Subway ★★★★★ \$ **B-2 • 141**
 411 7th Ave, 412-391-3177
 Th: 6a-9p Fr: 6a-9p Sa: 8a-6p Su: 9a-5p

Seafood

Andy's Sushi Bar at Wholey's ★★★★★ \$\$ **Strip • 142**
 1711 Penn Ave, 412-281-8272
 Th: 10a-5:30p Fr: 10a-6p Sa: 10a-5p Su: 9a-4p

Eddie V's Prime Seafood ★★★★★ \$\$\$ **B-3 • 143**
 501 Grant St, 412-391-1714
 Th: 4p-10p Fr: 4p-11p Sa: 4p-11p Su: 4p-9p

McCormick & Schmick's ★★★★★ G \$\$\$ **A-2 • 144**
 301 5th Ave, 412-201-6992
 Th: 11a-9p Fr: 11a-10p Sa: 4p-10p Su: 4p-8p

No 1. Sushi Sushi ★★★★★ \$\$ **A-2 • 145**
 436 Market St, 412-251-5510
 Th: 11a-8p Fr: 11a-8p Sa: closed Su: closed

Original Oyster House ★★★★★ \$ **A-2 • 144**
 20 Market Sq, 412-566-7925 - cash only
 Th: 10a-10p Fr: 10a-10p Sa: 10a-10p Su: 11a-7p

Pittsburgh Poke ★★★★★ \$ **A-2 • 147**
 500 Liberty Ave, 412-338-2199
 Th: 11a-7p Fr: 11a-7p Sa: 11a-7p Su: closed

Roland's Seafood Grill ★★★★★ \$\$ **Strip • 148**
 1904 Penn Ave, 412-261-3401 - Kitchen closes earlier than bar
 Th: 11a-12a Fr: 11a-2a Sa: 11a-2a Su: 11a-12a

Wholey's ★★★★★ \$ **Strip • 149**
 1711 Penn Ave, 412-391-3737
 Th: 8a-5:30p Fr: 8a-6p Sa: 8a-5p Su: 9a-4p

Steakhouses

Fogo de Chao Brazilian Steakhouse ★★★★★ \$\$\$ **B-3 • 150**
 525 Smithfield St, 412-312-5001
 Th: 11a-3p, 5p-10:30p Fr: 11a-3p, 5p-11p Sa: 11a-11p Su: 11a-10p

Morton's The Steakhouse ★★★★★ \$\$\$ **A-2 • 151**
 625 Liberty Ave, #180, 412-261-7141
 Th: 5p-10p Fr: 5p-10p Sa: 5p-11p Su: 5p-10p

Steakhouses

The Capital Grille ★★★★★☆ \$\$\$\$ **A-2 • 152**
 301 5th Ave, 412-338-9100
 Th: 11a-10p Fr: 11a-11p Sa: 4p-11p Su: 4p-9p

Sweets and Treats

Katie's Kandy ★★★★★☆ \$\$ **A-3 • 153**
 422 Wood St, 412-227-0999
 Th: 10a-8p Fr: 10a-8p Sa: 11a-5p Su: 11a-5p

Katie's Kandy ★★★★★☆ \$\$ **A-2 • 154**
 120 Fifth Ave, 412-594-7039 - Fifth Avenue Place, Lower Level
 Th: 10a-6p Fr: 10a-6p Sa: 10a-3p Su: closed

Katie's Kandy **C-2 • 155**
 1000 Penn Ave, 412-734-5586 - Federated Building, Westin Lobby
 Th: 9a-7p Fr: 9a-7p Sa: 8a-5p Su: 8a-3p

Millie's Homemade Ice Cream ★★★★★☆ \$ **A-3 • 156**
 264 Forbes Ave, 412-709-6579
 Th: 11a-10p Fr: 11a-11p Sa: 11a-11p Su: 11a-10p

Sinful Sweets Chocolate Company ★★★★★☆ \$\$ **A-2 • 157**
 539 Liberty Ave, 412-720-1381
 Th: 11a-9p Fr: 11a-9p Sa: 11a-9p Su: 12p-5p

The Milkshake Factory ★★★★★☆ V \$\$ **A-2 • 158**
 314 Fifth Ave, 412-315-7115
 Th: 11a-10p Fr: 11a-11p Sa: 11a-11p Su: 11a-10p

Thai

Little Bangkok on the Strip ★★★★★☆ \$\$ **Strip • 159**
 1906 Penn Ave, 412-586-4107
 Th: 11:30a-3p, 5p-9p Fr: 11a-2p, 5p-9p Sa: 11a-3p, 5p-9p Su: closed

Nicky's Thai Kitchen ★★★★★☆ V G \$\$ **B-2 • 160**
 903 Penn Ave, 412-471-8424
 Th: 11:30a-3p, 5p-10p Fr: 11:30a-3p, 5p-10:30p Sa: 11:30a-3p, 5p-10:30p Su: 5p-9p

Convenience & Newsstands

7-Eleven Stores ★★★★★☆ \$ **A-2 • 161**
 643 Liberty Ave, 412-261-3248
 Th: 24 hours Fr: 24 hours Sa: 24 hours Su: 24 hours

Extra Extra News & Variety **B-2 • 162**
 413 7th Ave, 412-471-7655
 Th: 6:15a-6p Fr: 6:15a-6p Sa: closed Su: closed

Faber, Coe, & Gregg **B-3 • 163**
 600 Grant St, 412-471-4795
 Th: 7a-6p Fr: 7a-6p Sa: closed Su: closed

Faber, Coe, & Gregg **C-2 • 164**
 1000 Penn Ave, 412-261-4449
 Th: 7a-6p Fr: 7a-6p Sa: closed Su: closed

Convenience & Newsstands

Liberty News **A-2 • 165**
 602 Liberty Ave, 412-281-9772
 Th: 7a-7p Fr: 7a-7p Sa: 8:30a-7p Su: closed

Drug Stores

CVS Pharmacy **A-3 • 166**
 429 Smithfield St, 412-261-4846
 Th: 6a-7p Fr: 6a-7p Sa: 8a-6p Su: 10a-6p

CVS Pharmacy **A-2 • 167**
 242 Fifth Ave, 412-566-2619
 Th: 6a-7p Fr: 6a-7p Sa: 8a-6p Su: 10a-6p

Rite-Aid **B-2 • 168**
 623 Smithfield St, 412-471-8882
 Th: 7a-8p Fr: 7a-8p Sa: 9a-6p Su: 11a-4p

Photocopies & Shipping

ColorPerfect Printing **B-2 • 169**
 804 Penn Ave, 412-288-2525
 Th: 8:30a-5p Fr: 8:30a-5p Sa: closed Su: closed

FedEx/Kinkos **B-2 • 170**
 960 Penn Ave, 412-391-2014
 Th: 7:30a-9p Fr: 7:30a-9p Sa: 8a-6p Su: closed

Minuteman Press **B-2 • 171**
 905 Liberty Ave, 412-471-5599
 Th: 8:30a-4:30p Fr: 8:30a-4:30p Sa: closed Su: closed

Points of Interest

National Aviary **Off Map • 172**
 700 Arch St, 412-323-7235 - www.aviary.org
 Th: 10a-5p Fr: 10a-5p Sa: 10a-5p Su: 10a-5p

Pittsburgh Zoo & PPG Aquarium **Off Map • 173**
 7340 Butler St, 412-665-3640 - www.pittsburghzoo.org
 Th: 9a-5p Fr: 9a-5p Sa: 9a-5p Su: 9a-5p

ATM Locations

Bank of America
 301 Fifth Ave

Citizen's Bank
 525 William Penn Pl

Dollar Bank
 400 5th Ave - Kaufmann's
 340 4th Ave

537 Smithfield St - Oliver Building
 David Lawrence Conv. Center, DLCC

First Commonwealth Bank
 501 Grant St - August Wilson Center

First National Bank
 559 Grant St - Smithfield Street Cafe

210 Sixth Ave - Cricket
 707 Grant St - Gulf Tower

Huntington Bank
 650 Smithfield St
 610-612 Wood St
 429 Smithfield St

PNC Bank
 1000 Liberty Ave - Moorehead Fed. Bldg.
 1001 Liberty Ave - Liberty Center
 411 7th Ave - Duquesne Light
 436 7th Ave - Koppers Building
 600 Grant St - Steel Plaza Office
 625 Liberty Ave - Dominion Tower
 643 Liberty Ave - 7-Eleven
 6th Ave & Wood St - T - Wood St. Station

Westin

Please Note

The skybridge stairs lead to the Ballroom only. For easier access to the Dealers' Room, Art Show, or Artists' Alley, please use the ground-level entrance to the Convention Center. Please reserve the elevators in the Skybridge for fursuiters and persons with physical disabilities.

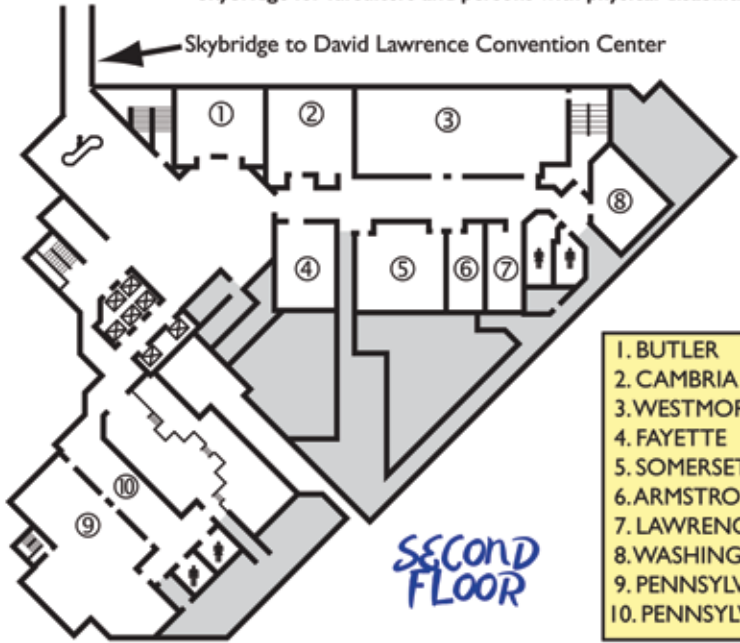

1. BUTLER
2. CAMBRIA
3. WESTMORELAND
4. FAYETTE
5. SOMERSET
6. ARMSTRONG
7. LAWRENCE
8. WASHINGTON
9. PENNSYLVANIA
10. PENNSYLVANIA FOYER



YOUR feedback helps improve our Dining Guide.

Comments are always welcome! Let us know what you liked or didn't like!
E-mail book@anthrocon.org or visit www.anthrocon.org/survey

Follow us on Twitter!

 @AnthroconDining

Dealers' Room Map & Index

ART SHOW (Hall C)

Friday, July 5:

10am: Artist check-in begins
2-6pm: Art Show open to bidders
9-11pm: Artists & Dealers Reception
(by invitation only)

Saturday, July 6:

10am-6pm: Art Show open to bidders
6pm: Mature Gallery written bidding closes
11pm: Mature Gallery voice auction begins (317-318)

Sunday, July 7:

10am-Noon: General Gallery open to bidders
Noon: General Gallery written bidding closes
2pm: General Gallery voice auction begins (317-318)
2-5pm: Sales, artist check-out

DEALERS' ROOM (Hall B)

Friday, July 5:

Noon – 6 p.m.: (11:45 a.m. Sponsor Admission)

Saturday, July 6:

10 a.m. – 6 p.m.: (9:50 a.m. Sponsor Admission)

Sunday, July 7:

10 a.m. – 4 p.m.: (9:50 a.m. Sponsor Admission)

ARTISTS' ALLEY/CON STORE (Hall C)

Friday, July 5: 12 p.m. – 5 p.m.

Saturday, July 6: 10 a.m. – 5 p.m.

Sunday, July 7: 10 a.m. – 3 p.m.

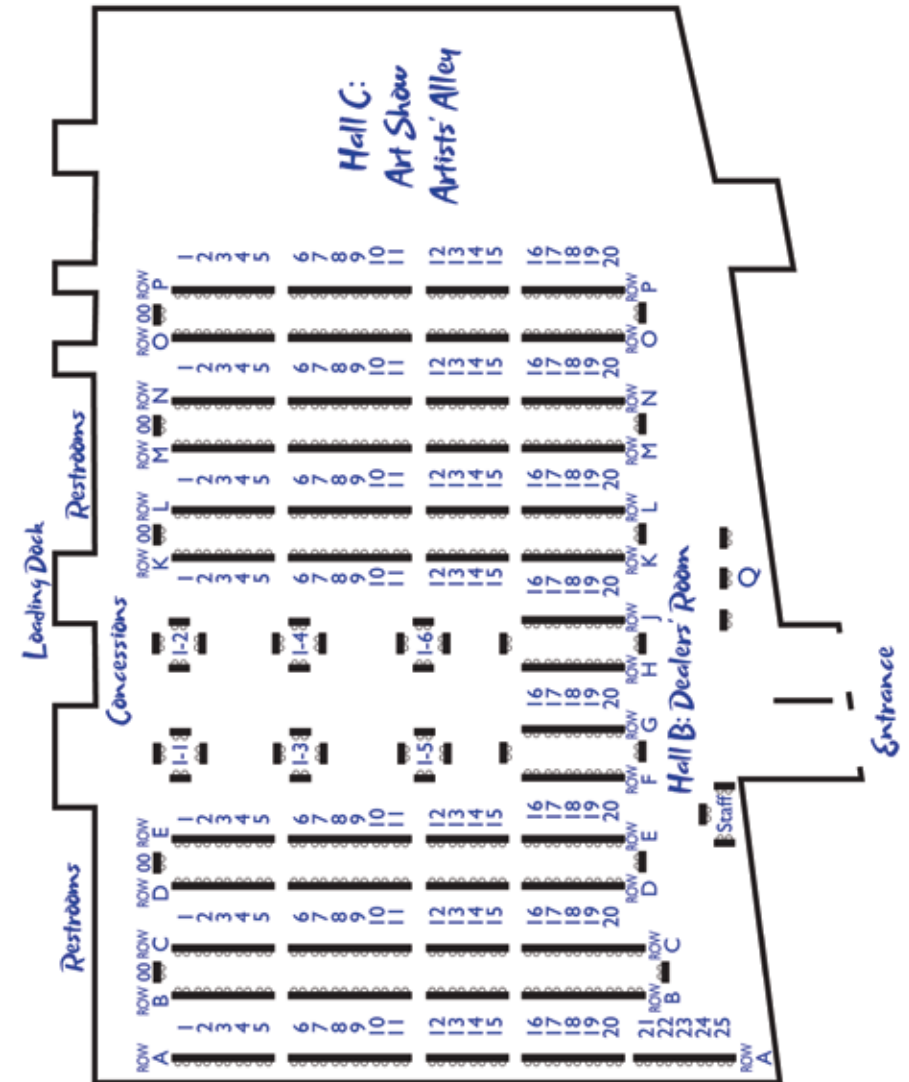

The table below lists the dealers who are confirmed for the 2019 convention as of May 28nd, 2019. Note that the table locations are denoted by a letter followed by a number (such as A15). This represents the row (A through P) and the table number in that row (1 through 25). Tables at the end of a row are listed by both row numbers and the table number (such as B00C or D21E). **TABLES MAY CHANGE BEFORE THE CONVENTION!**

Dealer Name	Location
123 Paprika!	P10
A Case of Random	F17
A Thousand Rasps	B16
A True Blue Artist	C10
Adriana Ferguson	C09
Aetherwears	B20B/B21
Aisu Art	B11
Animal Skull Masks by Eric Strother	B22C
AR.Gl.BI. Creative Studio	C04
Art by Sandy Schreiber	D10
Artwork of Michele Light	D12
Ask Jam/Peaches and Cream	K02B/K03
B3Mascots	C02/C03
Beastly Boo-tique	M03/M04A
Bestcrafts at Tiffany's	A19/A20
Beta Raptor Creations	M21N
Bill Holbrook	P09
BlindCoyote	A07B/A08
Blue Canary Gallery	J15
Boneitis Industries	N17
Brian & Tracy Reynolds	J16
Bunnies and Cream	A04/A05
Butterscotch Biscuit	B12
CadmiumTea	N08
Canis Ovis Arts	O21P
Caribou Ink	D15
Carpetshark Studio	P08
Chance and Skippy Lynn	M02
Chibi Tsubame Creations	B02/B03
CINAMONCUNE	K11
Closet geek llc	L08/L09A
Cocadope Ink	P07
Coey and Shy	B04/B05
Cooner Arts!	L04
Corgilope	N15
Crazdude	A06/A07A
Critical Hit Collectibles	N04
Crowlines	N10
Curious Octopus	C06
CZGoldEdition	E15
Diana Stein	D14
DiZZiNESS	B18
Dowidat Ceramics	N16

Dealer Name	Location
Dragonmelde Illustrations	O06
Drak-Arts	M10
Dreamvision Creations	P17/P18/P19/P20
Dutchcartoon	C12
Ebonyleopard & Kayla-Na	E04
Feather Critter	E14
FeretStudios	N18B
Flinters' Ruderoo Design	K12/K13A
Foxes and Peppers	F18
Fritter Critter Scribbles	B07B
Full Moon Special	E17B
FurPlanet Productions	A13/A14/A15
Furry Dakimakura	O01/O02
Furry Experience Comics	D20B
Furry Mystery Box	O07/O08
FurScience	Q03
FursuitSupplies.com	I04
gBlazeWear, LLC	O14/O15
Gideon's Corral	K04
Gold Star Anime & Games	D01/D00E/E01
Golden Druid	K15
Heather Bruton Illustration	D13
Heliopause Productions	D17
Honeck Sculpture	E06/E07/E08
Honey Sweet Studio	C14
Hopeful Monster Studios	C19/C20
Icy Paw Productions	O17/O18
Ifus	L10
Imagination Boutique	M05
Inanimorphs	M12/M13
INKtiger	L02
Ishaway	N13
Jarlidium Press	K13B/K14
JenKiwi	C17
jill0r / JILLCOSTUMES	C16A
Kacey Miyagami	C13
Kalika	P03
Kaysha Siemens	C05
KIRISKA	D02
Kopes Kreations	K21L
Kozy Koza	M09
Kyote Illustrations	O16
Lackadaisy	K18/K19/K20
Lagarto Gear	I05
Lawyers and Liquor / Dragget Show	A21
Lemonbrat Studio	L06/L07
likeshine	E11
LittleRock's Hatchery	A18
Lizard Lamination & Art	E02
Lizardbeth Art	D18
Lizet	N06
Lock & Key Curiosities	D05
Lydiarts and Crafts	L17/L18
Made by Muttmix/Kawaii Doggo	N02B/N03

Dealer Name	Location
Mango Island and Catcher Files	A11/A12
Mango Wolf Works	A22
Marci McAdam	D11
Mariposa Miniatures	P02
Mary Mouse - Certified Tags	E05
Mastergodai	P11
Melissa Mendelson Art	N12
Mimosa Studio	P01
Monster Cat Creations	O11/O12B
Moon's Creations	B17
Morningwitch Studio	D03
Moss	M15
Moth Monarch	D16
Mystik Waboose	E09/E10
Naomi Romero Art	N11
NeonSlushie	M08
Neurotic Sphynx	C20/C21
Nightengale Needles	K17B/K18
NightlineZ Art	J20
Northwest Furry Trading Company LTD	L03
OffWorld Designs	B01/B00C/C01
OMG Pineapples	C16B
Onnanoko	M14
OtterBear Studios	E18/E19/E20
Otterly Amazing	I06
Owner	L19B/L20
Padma Bhujaga ~ The Art of SoulsPoison	J19
PaintedDog	L16
Panda Fuzz	L11
Papaya Badger	K00L
Paw to Press	A01/A02/A03
PawesomeCostumes	O03/O04
Paws 'N' Relax	Q01
Pinku Shika	M19/M20
Pocket Pandas	J18
Pocket Sushi	D06
Pomgon's Printing Service	M16/M17A
poofinburd	F16
PookatDinoCrafts	M07
Primordial Pals	L01
Princess Rei's Art	K09B/K10
Puccoon Raccoon	B06/B07A
Pupcakes and Cupcats	O13
Quack Quack Honk Designs	G16
Rabbit Valley Comics	B14
RCSI Publishing	M00N
Red Falcon	I01
Ringtail Cafe Productions	O09/O10
Roamin' Bison Workshop	D21E
Roan RPG	B08/B09A
Roz Gibson	E03
Rukis Art	O19/O20
Rysingson Accessories	B15
Saint 508	M06

Dealer Name	Location
Samohr Lion Creations	B09B/B10
Sanguine Games	P06
Sarahcat Fursuits	C11
Sasha R. Jones Illustration	L12/L13
Scotty A	J17
Seward Street Studios	K06/K07/K08
shen's nanigans	L05
Silent Ravyn	C15
Silver Games LLC	N05
Sirkus	O05
SixthLeafClover	E12/E13
Skullcat studios	O00P
Skulldog Studio	N14
Sleeping Fox Art	K09A
Snow Fox Printing LLC	N01/N02B
Sofawolf Press, Inc	A16/A17
Sorbet Jungle	I02
Space Cat Creations	E16/E17A
Sparkle Kreations	I03
SpartaDog Illustration	M17B/M18
Split Hares	L19A
Starry Kitsune	M11
StarSheepSweaters	G18
Static Claws	F15/F14G/G15
Stigmata / Jonathan Vair Illustration	L14/L15
Studio Cute	K01/K01A
Sugar Bunny Shop	A24/A25
Sunset Dragon	D04
Talenshi Illustration & Design	N18A
TaniDaReal	K05
Teaberry Workshop	F19
Tentaclefriendly	B13B
The Animal Acts of Etna Print Circus	A23
The Bead Shoppe	Q02
The Garment Goddess	A09/A10
The Gneech/Suburban Jungle	B13A
The Katbox	P12/P13/P14/P15
The Purple Husky	K16A
The Rainbow Kirin	N09
Tiger Torre Art	H14J
Toy Pony Studios	G19/G20
Trader Tabs	F20
TsaoShin	G17
Twokinds	P16
Ursula Vernon	D19/D20A
voidbug	N07
Waffle Wishes	P04/P05
Walt's Cards	C07/C08
Wanderlust Arts	M01
Warhorse Workshop - Soap Pony	D07/D08
Wayward Leather Design	N19/N20
West's Custom Creations	B19/B20A
Windfalcon	C18
Wingtipdesigns	O12B

Convention Center (1st Floor)

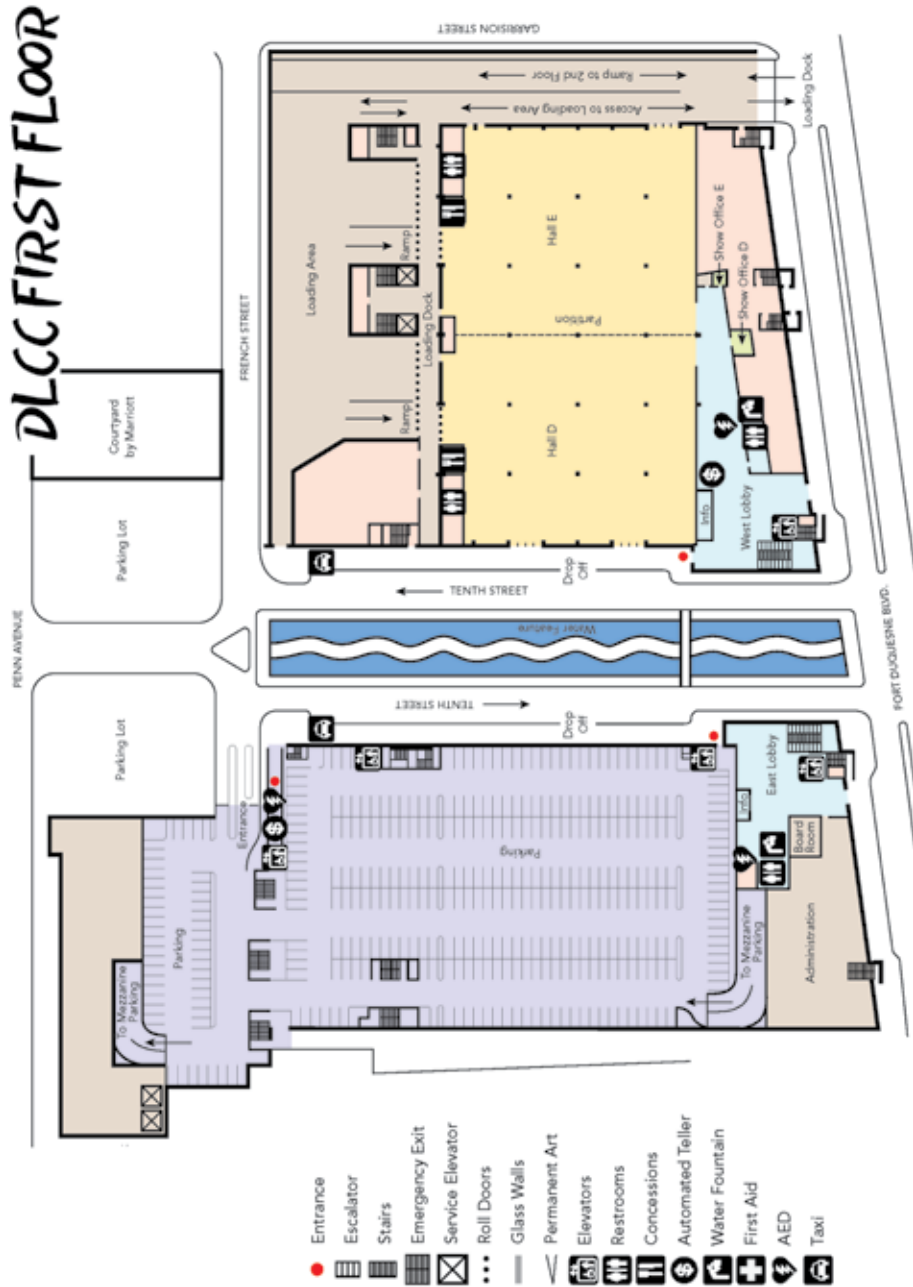

Convention Center (2nd Floor)

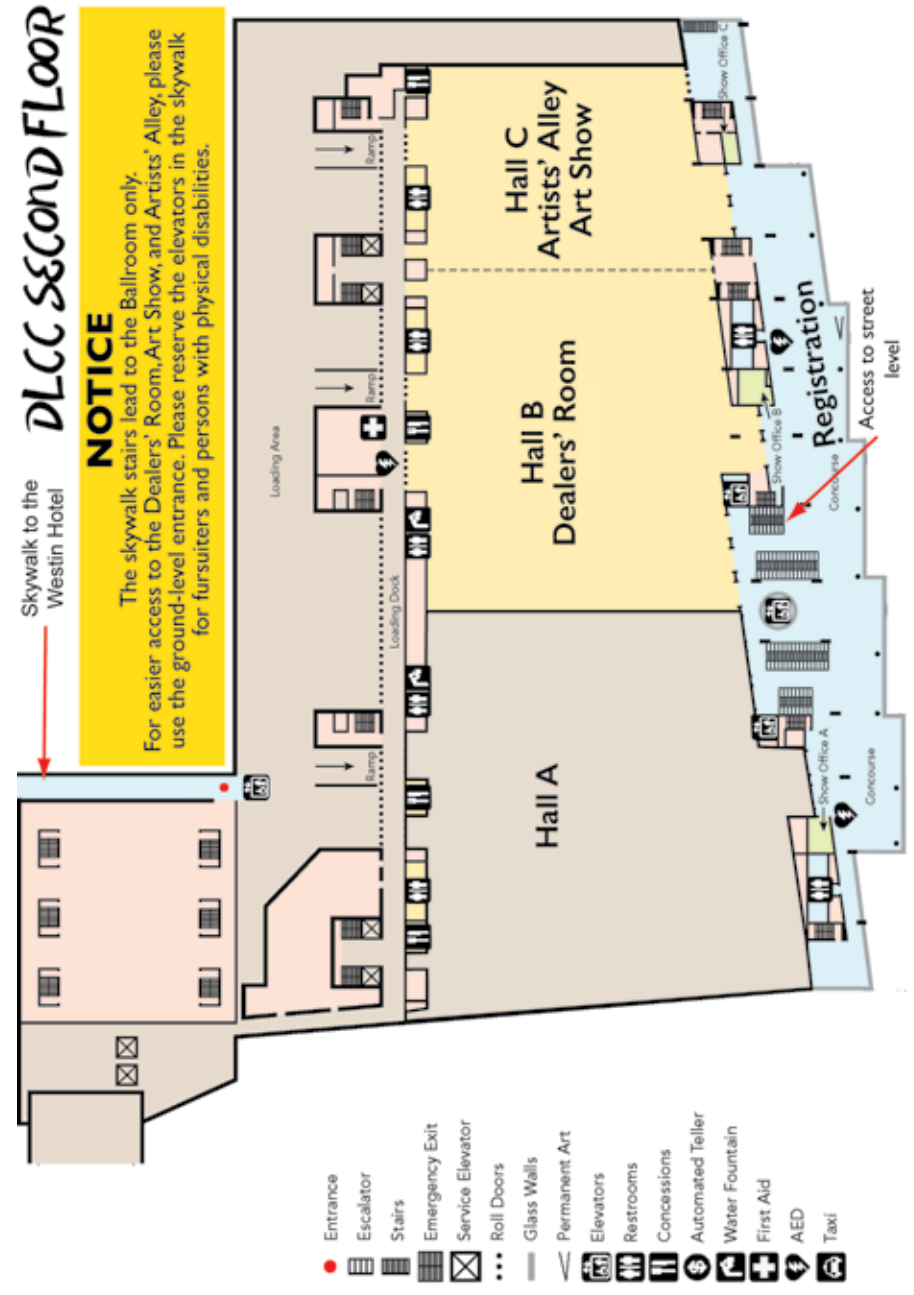

YOUR feedback helps improve our Dining Guide.

Comments are always welcome! Let us know what you liked or didn't like!
E-mail book@anthrocon.org or visit www.anthrocon.org/survey

Follow us on Twitter!

@AnthroconDining

Registration: Concourse B

Thursday, July 5: Pre-registration only: Noon-2 p.m.
On-site registration: 2 p.m.-10 p.m.

Friday, July 6: 9 a.m.-10 p.m.

Saturday, July 7: 10 a.m.-6 p.m.

Sunday, July 8: 10 a.m.-4 p.m.

After hours pre-reg badge pick-up:
Pre-registered badges are brought to Con Ops (DLCC Room 309) after registration closes and are available for after hours pick up until Con Ops closes.

Convention Center (3rd Floor)

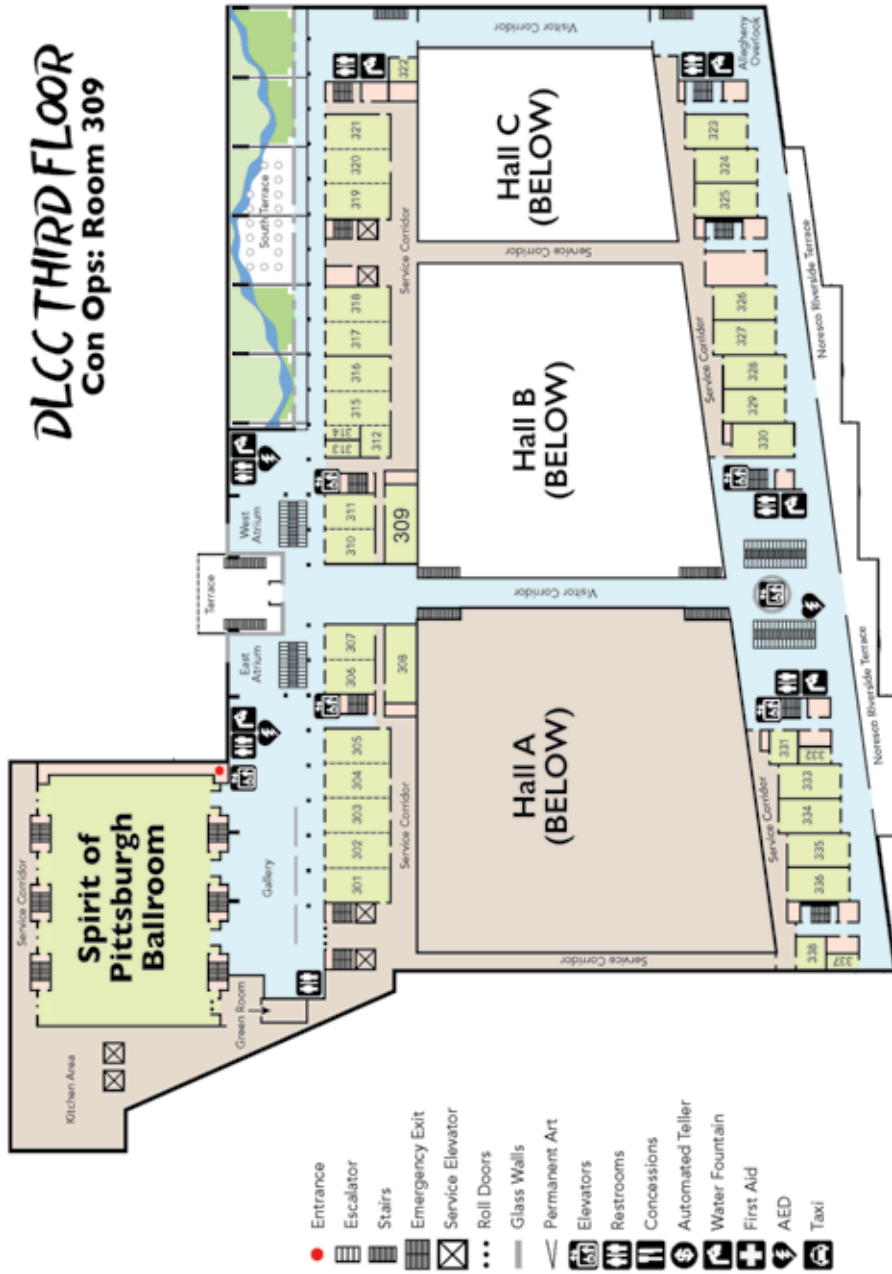

Con Ops will be open in Room 309 the following hours:
Thu: 9 a.m.-2 a.m. • Fri: 9 a.m.-2 a.m. • Sat: 9 a.m.-2 a.m. • Sun: 9 a.m.-7 p.m.

At all other times, including all day Wednesday, 2 a.m.-9 a.m. Thursday-Saturday, and Sunday after 7 p.m., Con Ops will also be in the Crawford Room, located on the third floor of the Westin Hotel, just off of the elevators.

Convention Center (4th Floor)

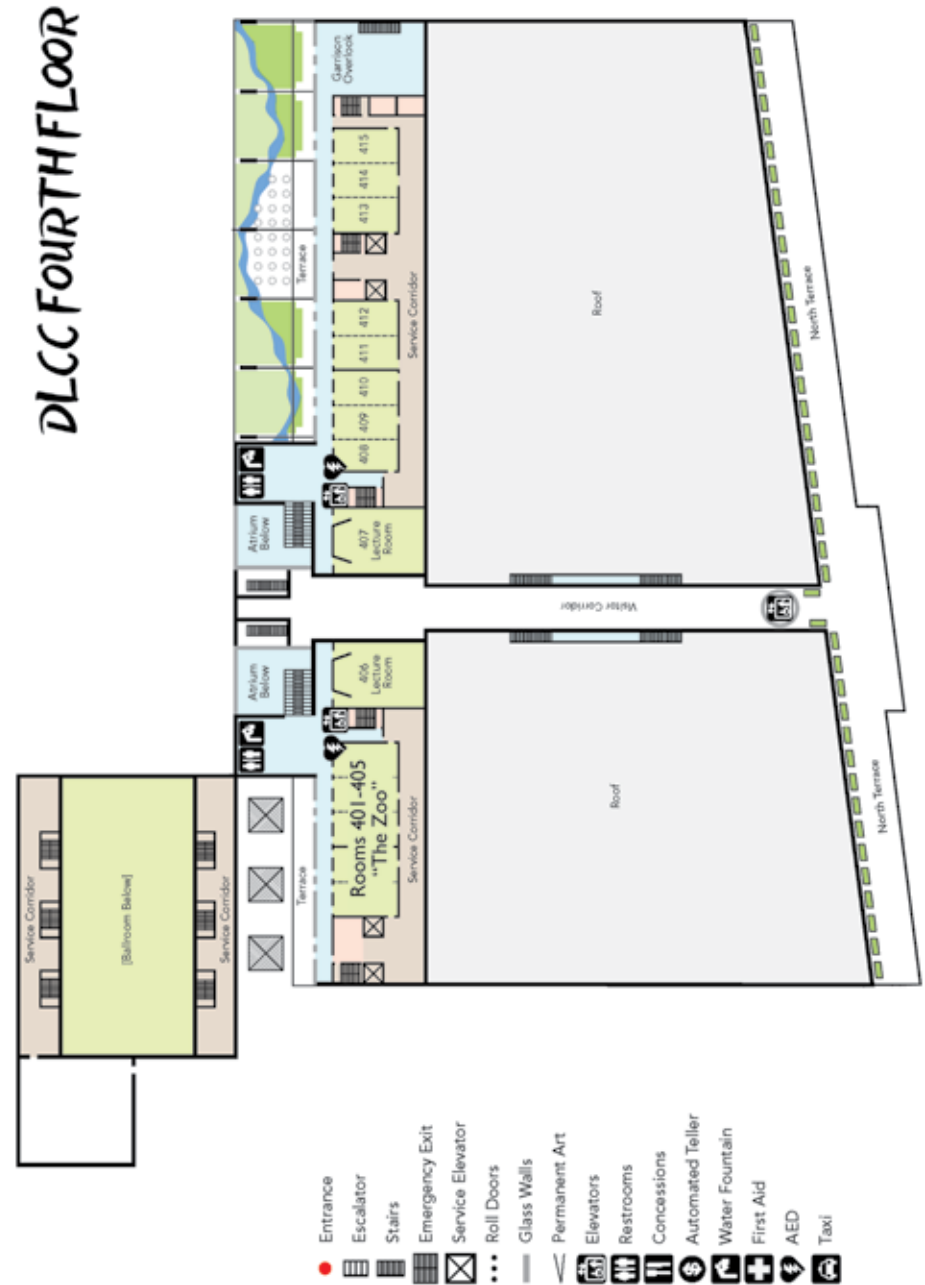

YOUR feedback helps improve our Dining Guide.

Comments are always welcome! Let us know what you liked or didn't like!
E-mail book@anthrocon.org or visit www.anthrocon.org/survey

Follow us on Twitter!

@AnthroconDining

Charity Auction & Raffle

Charity:

- **Display:** Charity's Table in the Dealers' Room, during Dealers' Room hours Fri-Sat for raffle items and until Sunday for auction items.
- *Donations accepted at the Display when available Thursday, and from 9a-Dealers' Room close on Friday.*

Auction:

- **Event:** Sunday, 12p-1:30p, DLCC 406.

Raffle:

- Buy tickets at Charity table and place tickets at the Display.
- Winning ticket numbers displayed on Sunday.
- Items must be claimed at Display on Sunday.



Kazoo, Parrot Adopted from PEARL



Last year, the event raised over \$14,000 (events total; convention total: \$42,051) for South Hills Pet Rescue. Since 1997, Anthrocon has raised over \$350,000 for various charities, including Therapy Dogs, Whiskers, the Great Valley Nature Center, the National Greyhound Adoption Program, Reins of Life, Canine Partners for Life, Support Our Shelters, Forgotten Felines & Fidos, Greater Philadelphia Search & Rescue, Western Pennsylvania National Wild Animal Orphanage, Animal Friends, Pittsburgh Parrot Rescue, the Animal Rescue League of Western PA Wildlife Rehabilitation Center, Fayette Friends of Animals, The Toonseum, Hello Bully, Equine Angels Rescue, The National Aviary, the Western PA Humane Society, the Pittsburgh Zoo & PPG Aquarium, and Hope Haven Farm Sanctuary.

Raffle tickets can be bought and submitted at PEARL Parrot Rescue's table's raffle display in the Dealers' Room. Drawings for each item will occur after the Dealers' Room closes on Saturday and results will be posted

there through Sunday for claims and prize pickup.

Before the Charity Auction on Saturday, donations will also be on display at PEARL Parrot Rescue's table in the Dealers' Room. The Charity Auction itself will occur on Sunday afternoon and will run for approximately one hour. Donated items and services will be offered in the Charity Auction for bargain prices designed to stimulate your interest in contributing to a worthy cause as well as receiving a quality product that you won't be able to find anywhere else at Anthrocon.

If you would like to participate by donating an item to the Charity Auction or Raffle, see the Charity Director, Brian Harris, at the charity table in the Dealers' Room on the afternoon of Thursday, July 4 or during Dealers' Room setup or open hours on Friday, July 5. Please help us support PEARL Parrot Rescue by participating in the 2019 Anthrocon Charity Auction & Raffle.

The genre of anthropomorphics is a field that deals heavily in the thematic appreciation of animals crossed to varying degrees with humans resulting in fantastic, intelligent characters and marvelous new imaginary species. However, we should never overlook the real-life counterparts to this mix and assist our animal friends in any way we can to ensure a better future for all of us.

This year, Anthrocon has chosen to support PEARL (Parrot Education, Adoption, and Rehoming League) Parrot Rescue.

PEARL is an all-volunteer and foster-based organization that strives to provide quality education to

current and potential parrot or bird owners, find qualified applicants to adopt unwanted or found parrots, and assist in home-to-home adoptions for non-parrot pet birds.

You can visit PEARL Parrot Rescue's website at pearlparrots.com for more information.

PEARL Parrot Rescue's representatives will be on hand during the Charity Auction to receive bidders' payments, and throughout the weekend at their Dealers' Room table and raffle display selling tickets and accepting donations. Anthrocon staff does not handle Auction payments or ticket sales. At PEARL Parrot Rescue's table in the Dealers' Room, you can also receive further information on their organization.

The Anthrocon Charity Auction & Raffle will be supporting this beneficial organization by auctioning and raffling items donated by artists, dealers, and other generous donors who have provided us with artwork, merchandise, and other items without requesting anything in return to help raise money for this year's chosen charity.



Art Show Information

ANTHROCON ART SHOW BIDDING RULES

The Anthrocon Art Show is an exhibit of original artworks of a science fiction, fantasy and/or “fannish” nature, especially relating to anthropomorphic animals. Here you will find for sale both flat (e.g. sketches and paintings) and 3-dimensional (e.g. sculpture and costumes) artwork created by professional and amateur artists.

To be a “bidder” (i.e. a prospective buyer of original artwork) you must:

1. Be a registered member of Anthrocon, as evidenced by your convention badge;
2. Obtain a bidder number at the Art Show table by filling out and signing a bidder information sheet, acknowledging that you agree to abide by these bidding rules.

If you wish to place “proxy” bids on behalf of someone not in attendance, please see the Art Show Director.

Significant changes from previous versions of these rules are indicated in **bold type**.

Areas of the Art Show

There are two distinct areas of the Art Show.

1. In the General Gallery, you will see original artwork depicting subjects suitable for all ages to view. This will be open for silent (written) bidding during the day and early evening Friday and Saturday, and Sunday morning. If a piece receives enough written bids by noon Sunday, it will be sent to the general voice auction Sunday afternoon.

2. The Mature Gallery is set aside for the display of original artwork depicting mature subject matter. This will be open during the same hours as the rest of the Art Show Friday and Saturday, and monitored to keep minors out. Pieces in this area which receive enough written bids by Saturday evening will be sent to a separate voice auction later that evening.

Bidding

Each piece of artwork is tagged with a Bid Sheet which provides information about that piece, including its title, the medium, the name of the artist, and the minimum bid at which the artist is willing to sell the piece. If an artist does not wish to sell a given piece, it is listed as “NFS” (Not For Sale).

On the Bid Sheet are several lines where you may write down your name, bidder number, and the amount you wish to bid for that item. The amount of the bid must be in whole dollars, at least as much as the minimum bid specified by the artist, and larger than any preceding bid on the bid sheet. Write *legibly* on the next numbered bid line. *Do not cross out any previously written bids, including your own.* If you make a mistake in bidding, please inform an Art Show crew member so we may fix the bid sheet so there are the correct number of empty bid lines.

You may not interfere with or intimidate someone who wants to outbid you. Allow them to place their bid, and then outbid them on the next bid line. If someone tries to keep you from placing a bid, seek assistance from an Art Show

crew member. Anyone caught interfering with bidding will be asked to leave the Art Show, and their bidding privileges revoked.

Artists (or their associates) may not place bids on their own artwork with the intent of bidding up the price unfairly, or to keep other bidders from purchasing a piece in order to retain it to sell elsewhere under more favorable circumstances. However, they are allowed to place “proxy” bids on behalf of a customer not in attendance.

Written bidding for General Gallery artwork closes at noon Sunday. The Art Show will be cleared of all bidders at that time, as detailed below. Pieces with enough written bids (as shown on the bid sheet) will be placed in the voice auction, which begins Sunday at 2 pm; all other art will be sold to the person with the highest written bid, if any. At the voice auction, the art is open to further bids by other people. Therefore, you should attend the voice auction to defend your bids on pieces you still want to buy. If there are no voice bids, the art will be sold to the person with the highest written bid. Although there are “runners” showing off the auction pieces, this is for *identification*, not admiration. Please take the time to examine the artwork closely while the show is open for written bidding!

For pieces in the Mature Gallery, the procedure is similar, although the times are different. Written bidding ends Saturday at 6 pm. Artwork with enough written bids will be placed in a separate voice auction for mature artwork which begins at 11 pm Saturday, and runs similarly to the General Gallery voice auction, as noted above.

All artwork sold by written bid or in either voice auction will be available for pickup Sunday during sales hours, 2 to 5 pm. Artists have the option of setting a “Price After Closing.” If a piece has received no written bids by closing time, it may be available at the indicated price Sunday afternoon if the artist still wishes to sell it. If this is the case, the blank bid line #1 will be circled in red. Fill in your name, bidder number, and the “Price After Closing” when collecting your artwork.

Be careful. When placing a written bid on items, assume that you will be the winning bidder on *all* of them. In this way, you will avoid having to pay for more art than you can afford to buy. If you have reached your limit for Art Show purchases, wait until you have lost an item to a higher bidder before bidding on another item. (*Keep in mind that we must collect 7% sales tax on purchases, so allow for this in your figuring.*) We provide handy Bidding Record forms so you can keep track of what you’ve bid on and where it’s located to make it easy for you to find again.

Also, return to the Art Show before closing (6 pm Saturday for mature artwork; noon Sunday for everything else) to check the bid sheets to see what items, if any, you have won by written bid and which items will be going to the voice auction. After closing, because the crew is busy getting ready for the auction, we

cannot accommodate anyone who wants to check their bids at that time.

Be serious. Do not make a bid unless you mean it. A bid is a binding obligation to buy that art at that price.

If you are the winning bidder, you purchase only the physical possession of the artwork; the artist retains the copyright. If you wish to make copies of a piece you purchase for any purpose, you must negotiate for the right to do so with the artist, whose name and contact information are on the back of each piece or can be obtained from the Art Show Director. (*Please Note: Artists are provided with the names and addresses of those who have purchased their artwork.*)

Defending Your Bids

When the written bidding closes, crew members will form a “moving wall” starting at the back of a section and moving forward, closing bidding by artist (not by piece, not by panel, not by bay). The closeout path is shown on the Art Show map handout and poster. Closeout is done per artist in a bay: if there are three artists in a bay, there will be three closeouts in the bay; if one artist takes up the entire bay, the entire bay closes at once; and if an artist occupies more than one bay, each of their bays closes separately.

We move quickly, so when the “wall” gets to an artist you want to bid on, do your bidding *before* the auctioneer declares the artist “closed.” We will not close an artist while bidding is going on, but if there is no bidding, it will close quickly, so don’t be timid—if you want to bid, *bid!* We can’t wait for someone to make up their mind at the last second. We want you to get your chance to bid, but do it *quickly!*

You will be allowed to defend your bids, but you may not block anyone else from bidding on any piece—the auctioneer and Art Show crew will see that it doesn’t happen. If you are not actively guarding your bids, we ask that you clear the aisles at least 10 minutes before the show closes. There are a lot of people in the area, and we need to move them out as quickly as possible when closeout begins. If you are just having a conversation with someone, please take it outside the Art Show.

All this allows you to defend bids in more than one section. The Art Show crew follows close behind the “wall,” marking final bids to ensure that if you’re the last bid, you *are* the last bid. Once the “wall” passes a point, no one except Art Show crew are allowed beyond it.

Sales

Art Show Sales will take place Sunday from 2 to 5 pm. (If you have an afternoon ride, flight, train or bus to catch, please ask in *advance* about early sales pickup.) At this time you must personally pick up and pay for all items of art you have won by written bid or voice auction. You must show your con badge for identification, and additional identification may be requested.

If you have items in the Mature Gallery, these pieces must be paid for and wrapped before you can take them out of the Mature Gallery.

Collect your art from the panels and tables. *Do not remove the bid sheets from the artwork!*

There will be work tables set up where you then fill out a sales slip, writing in the artist name, piece title, and high bid amount for each piece, as well as your real name and bidder number. (Use more than one slip if necessary.)

If you have purchased more pieces than you can carry, or need access to a locked display case, ask for help from an Art Show crew member.

Once you have filled out your sales slips, go to a cashier, who will double-check the slip against the bid sheets, add up all the prices and calculate sales tax and total, and take your payment. We accept cash, traveler’s checks, personal checks, credit cards (Visa, MasterCard, American Express, Discover), and debit cards (all major networks). ID may be requested at time of payment.

You must pick up and pay for your own purchases, and show the receipt to the entrance guard when you leave the Art Show (so keep it handy). All sales are final and all items are sold as-is; refunds will not be issued for items purchased in the Art Show for any reason.

Occasionally there are errors in tallying sales slips. We always pay the artist based on the final bid sheet price; if it turns out we under- or overcharged you, in the weeks following the con we will bill you or refund the difference.

Remember: You bid, you buy. Your bid is a binding obligation with Anthrocon and the artist for the purchase of the artwork.

If you do not pick up your artwork and/or do not pay for it in full, we will contact you in the weeks after the convention and bill you for the price of the art plus packing and shipping costs (typically \$10–\$20 for those in the USA). You will be denied attendance at future Anthrocon conventions until you honor your payment obligation. Once you’ve paid, we will ship you the artwork **if available**. (After two years, unclaimed artwork is donated to the Charity Raffle/Auction, or otherwise bestowed, but this does not discharge your obligation; we have already paid the artist, so you must reimburse us.) Until you pay, your real name and badge name may be posted publicly so that others may be wary of doing business with you.

If you do not pick up and pay for your artwork at the con **more than once** without good reason, you will not be allowed to participate in future Anthrocon Art Shows.

Checks which do not clear the bank will be assessed a service charge of at least \$30. Persons who present fraudulent checks, unauthorized credit cards or counterfeit money will be reported to the authorities.

Celebrating 10 years!

Massage Therapy at Anthrocon!

Thank you for making us part of your convention experience. It has been a blast working with this fandom for so long. Be sure to stop by our booth, right next to the dealer's room entrance to book your appointment.

We are pleased to announce a third therapist this year!

Chris, aka Billy Bear will be available for walk-up clients.



Visit **The Bead Shoppe** right next to us for all your accessories.

Make your own necklace! Beads, bottles, vials and more...

